



Addendum No. 1 to ITB 2022-36

Panacea Evacuation Route Road Project (Jer-Be-Lou Boulevard to US Highway 98)

December 2, 2022

SECTION 1.0 SCHEDULE OF EVENTS - Please see dates adjusted in RED below

Failure to comply with this or any other paragraph of this ITB shall be sufficient reason for rejection of the proposal.

All times listed in the Schedule of Events are Eastern Standard Time (EST).

<i>Event</i>	<i>Date/Time</i>
Bid Advertisement Date	November 17, 2022
Release of Invitation to Bid	November 17, 2022
Mandatory Pre-Bid Conference	November 29, 2022 @ 10:00 A.M.
Addendum No. 1 Issued	December 2, 2022
Bid Questions Due from Prospective Bidder	December 6, 2022, by 5:00 P.M
Responses to bid questions due	December 13, 2022
BIDS DUE TO BOCC	December 19, 2022 @ 3:00 P.M.
Posting of Intended Award	December 22, 2022
Board Consideration of Intended Award	January 17, 2023
Posting of Notice of Award	January 18, 2023

This addendum is being issued to make the following clarifications.

ADDENDUM NO. 1 ITB 2022-36 PANACEA EVACUATION ROUTE ROAD PROJECT (Jer-Be-Lou Boulevard to US Highway 98)

Will the project require compliance with Davis-Bacon requirements?

Yes. The project does require adherence to Davis-Bacon guidelines. Please see attached Wakulla County Davis Bacon Prevailing Wage.

The typical section indicates OBG 6, while the bid form references 6" of base. Please clarify.

The typical section is correct. The bid form has been updated to reflect OBG 6. Please see the attached Basis of Bid form.

Will the County self-perform any components of this project?

Yes. The County will separately procure the striping and signage for this project. These items have been removed from the Basis of Bid. Please see the revised Basis of Bid attached to this addendum.

What is the intention at the intersection of Joe Mack Smith and Jer Be Lou Circle?

A detail outlining the proposed pavement at this intersection has been included as part of this addendum. Please see the attached detail.

WAKULLA COUNTY - DAVIS BACON PREVAILING WAGE

"General Decision Number: FL20220138 09/09/2022

Superseded General Decision Number: FL20210138

State: Florida

Construction Type: Heavy

County: Wakulla County in Florida.

HEAVY CONSTRUCTION PROJECTS (Including Sewer and Water Lines)

Note: Contracts subject to the Davis-Bacon Act are generally required to pay at least the applicable minimum wage rate required under Executive Order 14026 or Executive Order 13658. Please note that these Executive Orders apply to covered contracts entered into by the federal government that are subject to the Davis-Bacon Act itself, but do not apply to contracts subject only to the Davis-Bacon Related Acts, including those set forth at 29 CFR 5.1(a)(2)-(60).

If the contract is entered |. Executive Order 14026 |
into on or after January 30, | generally applies to the |
2022, or the contract is | contract. |
renewed or extended (e.g., an |. The contractor must pay |
option is exercised) on or | all covered workers at |
after January 30, 2022: | least \$15.00 per hour (or |
| the applicable wage rate |
| listed on this wage |
| determination, if it is |
| higher) for all hours |
| spent performing on the |
| contract in 2022. |

If the contract was awarded on |. Executive Order 13658 |
or between January 1, 2015 and | generally applies to the |
January 29, 2022, and the | contract. |
contract is not renewed or |. The contractor must pay all |
extended on or after January | covered workers at least |
30, 2022: | \$11.25 per hour (or the |
| applicable wage rate listed |
| on this wage determination, |
| if it is higher) for all |
| hours spent performing on |
| that contract in 2022. |

ADDENDUM NO. 1 ITB 2022-36 PANACEA EVACUATION ROUTE ROAD PROJECT (Jer-Be-Lou Boulevard to US Highway 98)

The applicable Executive Order minimum wage rate will be adjusted annually. If this contract is covered by one of the Executive Orders and a classification considered necessary for performance of work on the contract does not appear on this wage determination, the contractor must still submit a conformance request.

Additional information on contractor requirements and worker protections under the Executive Orders is available at <https://www.dol.gov/agencies/whd/government-contracts>.

Modification Number Publication Date

0 01/07/2022

1 02/25/2022

2 09/09/2022

ENGI0673-009 05/01/2021

Rates Fringes

POWER EQUIPMENT OPERATOR:

Crawler Crane, Hydro

Crane, Locomotive Crane,

Tower Crane, Truck Crane... \$ 32.62 12.00

Gantry Crane, Bridge Crane.. \$ 28.81 12.00

Oiler..... \$ 27.08 12.00

IRON0597-004 04/01/2021

Rates Fringes

IRONWORKER, STRUCTURAL AND

REINFORCING..... \$ 27.75 11.48

* LABO0517-002 05/01/2022

Rates Fringes

LABORER: Grade Checker..... \$ 22.06 10.98

PAIN0164-006 06/01/2021

Rates Fringes

PAINTER: Brush, Roller and

Spray..... \$ 20.21 12.38

ADDENDUM NO. 1 ITB 2022-36 PANACEA EVACUATION ROUTE ROAD PROJECT (Jer-Be-Lou Boulevard to
US Highway 98)

* SUFL2009-177 06/24/2009

Rates Fringes

CARPENTER..... \$ 15.36 0.00
CEMENT MASON/CONCRETE FINISHER...\$ 14.77 ** 3.50
ELECTRICIAN..... \$ 17.25 3.02
LABORER: Common or General..... \$ 9.43 ** 0.81
LABORER: Landscape..... \$ 7.25 ** 0.00
LABORER: Pipelayer..... \$ 10.00 ** 0.57
LABORER: Power Tool Operator
(Handheld Drills/Saws,
Jackhammer and Power Saws
Only)..... \$ 10.63 ** 2.20
OPERATOR: Asphalt Paver..... \$ 11.59 ** 0.00
OPERATOR: Backhoe Loader
Combo..... \$ 16.10 2.44
OPERATOR: Backhoe/Excavator..... \$ 12.09 ** 0.91
OPERATOR: Bulldozer..... \$ 15.00 4.98
OPERATOR: Grader/Blade..... \$ 16.00 2.84
OPERATOR: Loader..... \$ 13.89 ** 2.07
OPERATOR: Mechanic..... \$ 14.32 ** 0.00
OPERATOR: Roller..... \$ 10.76 ** 0.00
OPERATOR: Scraper..... \$ 11.00 ** 1.74
OPERATOR: Trackhoe..... \$ 20.92 5.50
OPERATOR: Tractor..... \$ 10.54 ** 0.00
TRUCK DRIVER, Includes Dump
Truck..... \$ 8.52 ** 0.25
TRUCK DRIVER: Lowboy Truck..... \$ 12.73 ** 0.00
TRUCK DRIVER: Off the Road
Truck..... \$ 12.21 ** 1.97

WELDERS - Receive rate prescribed for craft performing operation to which welding is incidental.
=====

** Workers in this classification may be entitled to a higher minimum wage under Executive Order 14026 (\$15.00) or 13658 (\$11.25). Please see the Note at the top of the wage determination for more information.

Note: Executive Order (EO) 13706, Establishing Paid Sick Leave for Federal Contractors applies to all contracts subject to the Davis-Bacon Act for which the contract is awarded (and any solicitation was issued) on or after January 1, 2017. If this contract is covered by the EO, the contractor must provide employees with 1 hour of paid sick leave for every 30 hours they work, up to 56 hours of paid sick leave each year. Employees must be permitted to use paid sick leave for their own illness, injury or other health-related needs, including preventive care; to assist a family member (or person who is like family to the employee) who is ill, injured, or has other health-related needs, including preventive care; or for reasons resulting from, or to assist a family member (or person who is like family to the employee) who is a victim of, domestic violence, sexual assault, or stalking. Additional information on contractor requirements and worker protections under the EO is available at <https://www.dol.gov/agencies/whd/government-contracts>.

ADDENDUM NO. 1 ITB 2022-36 PANACEA EVACUATION ROUTE ROAD PROJECT (Jer-Be-Lou Boulevard to US Highway 98)

Unlisted classifications needed for work not included within the scope of the classifications listed may be added after award only as provided in the labor standards contract clauses (29CFR 5.5 (a) (1) (ii)).

The body of each wage determination lists the classification and wage rates that have been found to be prevailing for the cited type(s) of construction in the area covered by the wage determination. The classifications are listed in alphabetical order of ""identifiers"" that indicate whether the particular rate is a union rate (current union negotiated rate for local), a survey rate (weighted average rate) or a union average rate (weighted union average rate).

Union Rate Identifiers

A four letter classification abbreviation identifier enclosed in dotted lines beginning with characters other than ""SU"" or ""UAVG"" denotes that the union classification and rate were prevailing for that classification in the survey. Example: PLUM0198-005 07/01/2014. PLUM is an abbreviation identifier of the union which prevailed in the survey for this classification, which in this example would be Plumbers. 0198 indicates the local union number or district council number where applicable, i.e., Plumbers Local 0198. The next number, 005 in the example, is an internal number used in processing the wage determination. 07/01/2014 is the effective date of the most current negotiated rate, which in this example is July 1, 2014.

Union prevailing wage rates are updated to reflect all rate changes in the collective bargaining agreement (CBA) governing this classification and rate.

Survey Rate Identifiers

Classifications listed under the ""SU"" identifier indicate that no one rate prevailed for this classification in the survey and the published rate is derived by computing a weighted average rate based on all the rates reported in the survey for that classification. As this weighted average rate includes all rates reported in the survey, it may include both union and non-union rates. Example: SULA2012-007 5/13/2014. SU indicates the rates are survey rates based on a weighted average calculation of rates and are not majority rates. LA indicates the State of Louisiana. 2012 is the year of survey on which these classifications and rates are based. The next number, 007 in the example, is an internal number used in producing the wage determination. 5/13/2014 indicates the survey completion date for the classifications and rates under that identifier.

Survey wage rates are not updated and remain in effect until a new survey is conducted.

Union Average Rate Identifiers

Classification(s) listed under the UAVG identifier indicate that no single majority rate prevailed for those classifications; however, 100% of the data reported for the classifications was union data.

EXAMPLE: UAVG-OH-0010 08/29/2014. UAVG indicates that the rate is a weighted union average rate. OH indicates the state. The next number, 0010 in the example, is an internal number used in producing the wage determination. 08/29/2014 indicates the survey completion date for the classifications and rates under that identifier.

A UAVG rate will be updated once a year, usually in January of each year, to reflect a weighted average of the current negotiated/CBA rate of the union locals from which the rate is based.

WAGE DETERMINATION APPEALS PROCESS

1.) Has there been an initial decision in the matter? This can be:

- * an existing published wage determination
- * a survey underlying a wage determination
- * a Wage and Hour Division letter setting forth a position on a wage determination matter
- * a conformance (additional classification and rate) ruling

On survey related matters, initial contact, including requests for summaries of surveys, should be

ADDENDUM NO. 1 ITB 2022-36 PANACEA EVACUATION ROUTE ROAD PROJECT (Jer-Be-Lou Boulevard to
US Highway 98)

with the Wage and Hour National Office because National Office has responsibility for the Davis-Bacon survey program. If the response from this initial contact is not satisfactory, then the process described in 2.) and 3.) should be followed.

With regard to any other matter not yet ripe for the formal process described here, initial contact should be with the Branch of Construction Wage Determinations. Write to:

Branch of Construction Wage Determinations

Wage and Hour Division

U.S. Department of Labor

200 Constitution Avenue, N.W.

Washington, DC 20210

2.) If the answer to the question in 1.) is yes, then an interested party (those affected by the action) can request review and reconsideration from the Wage and Hour Administrator (See 29 CFR Part 1.8 and 29 CFR Part 7). Write to:

Wage and Hour Administrator

U.S. Department of Labor

200 Constitution Avenue, N.W.

Washington, DC 20210

The request should be accompanied by a full statement of the interested party's position and by any information (wage payment data, project description, area practice material, etc.) that the requestor considers relevant to the issue.

3.) If the decision of the Administrator is not favorable, an interested party may appeal directly to the Administrative Review Board (formerly the Wage Appeals Board). Write to:

Administrative Review Board

U.S. Department of Labor

200 Constitution Avenue, N.W.

Washington, DC 20210

4.) All decisions by the Administrative Review Board are final.

END OF GENERAL DECISION

BASIS OF BID
Jer Be Lou and Joe Mack Smith Paving

	Item	Unit Cost	Quantity	Units	Cost
1	Mobilization		1	LS	
2	Maintenance of Traffic		1	LS	
3	Clearing and Grubbing		1	LS	
4	Grading and Shaping		1	LS	
5	Type B Stabilization (12")		9950	SY	
6	Asphalt		1300	TON	
7	OBG 6		9950	SY	
8	Performance Turf		6000	SY	
9	Sod		3500	SY	
10	15" ERCP		40	LF	
11	18" ERCP		90	LF	
12	24" ERCP		96	LF	
13	15" Headwall		2	EA	
14	18" Headwall		4	EA	
15	24" Double Headwall		2	EA	
				Total	

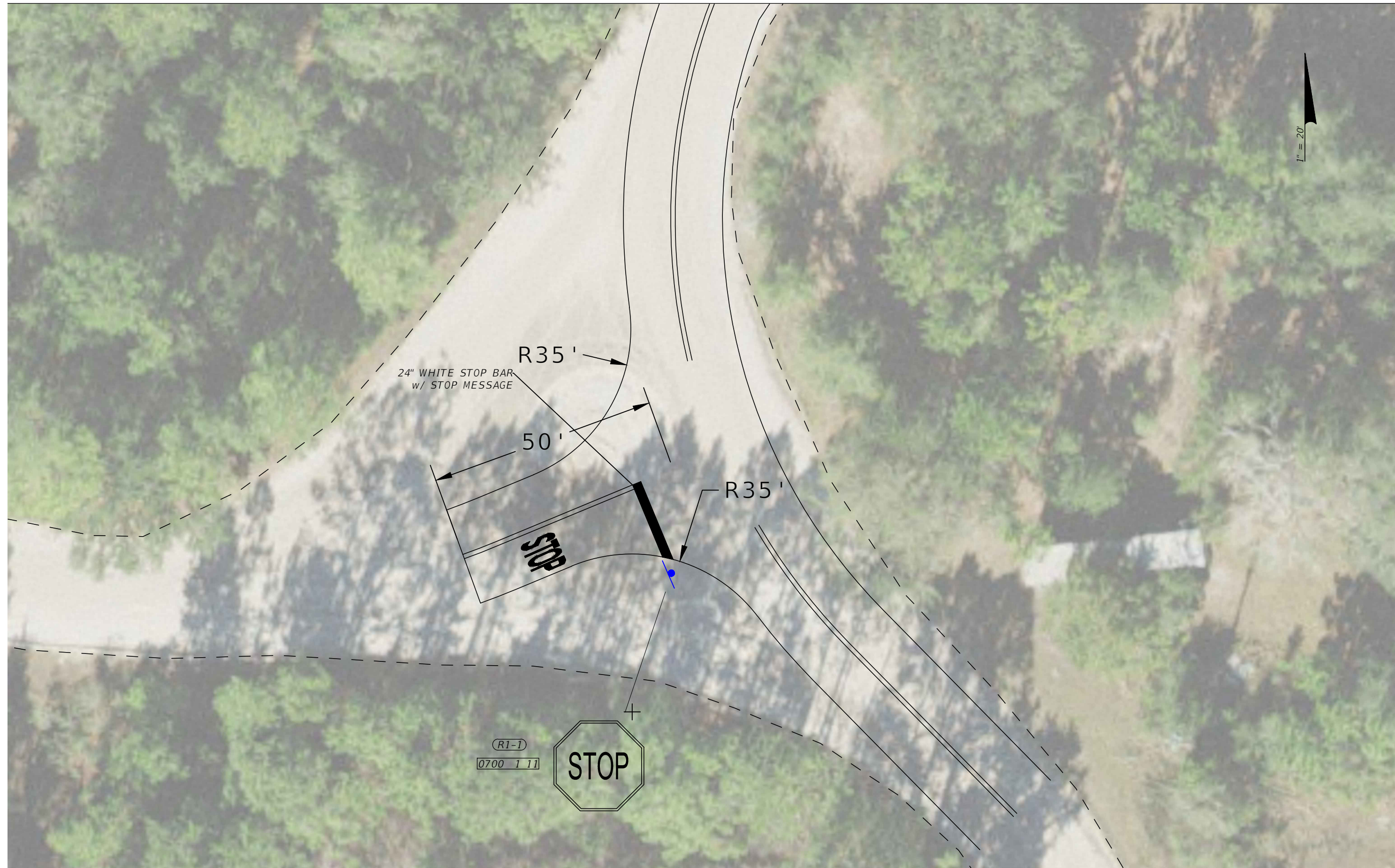

(R1-1)
0700 1 11



REVISIONS			
DATE	DESCRIPTION	DATE	DESCRIPTION
---	---	---	---

JOE MACK ROAD INTERSECTION		
ROAD NO.	COUNTY	FINANCIAL PROJECT ID
---	---	---

PLAN VIEW

SHEET NO.
