

**VILLAGE OF HINSDALE
VILLAGE BOARD OF TRUSTEES
MINUTES OF THE MEETING OF
January 4, 2011**

The regularly scheduled meeting of the Hinsdale Village Board of Trustees was called to order by President Tom Cauley in Memorial Hall of the Memorial Building on Tuesday, January 4, 2011 at 7:31 p.m.

Present: President Tom Cauley, Trustees J. Kimberley Angelo, Bob Saigh, Laura LaPlaca, Cindy Williams, Doug Geoga and Bob Schultz

Absent: None

Also Present: Village Attorney Ken Florey, Village Manager Dave Cook, Assistant Village Manager/Director of Finance Darrell Langlois and Deputy Village Clerk Christine Bruton

Also Present: Chuck Fieldman – The Doings, Dennis Jacobs – Patch.com, Ken Knudson – Hinsdalean, Don Grigus – Suburban Life

PLEDGE OF ALLEGIANCE

President Cauley led those in attendance in the recitation of the Pledge of Allegiance.

APPROVAL OF MINUTES

Trustee Saigh moved to **approve the minutes of the Regularly Scheduled Meeting of December 14, 2010.** Trustee Angelo seconded the motion.

AYES: Trustees Angelo, Saigh, LaPlaca, Williams, Geoga, Schultz

NAYS: None

ABSTAIN: None

ABSENT: None

Motion carried.

APPOINTMENT TO FINANCE COMMISSION

President Cauley read the qualifications of Mr. R. Scott Morris and asked for a motion to appoint Mr. Morris to the Finance Commission for a full 3-year term through April 30, 2013. So moved by Trustee Saigh, seconded by Trustee Angelo.

AYES: Trustees Angelo, Saigh, LaPlaca, Williams, Geoga, Schultz

NAYS: None

ABSTAIN: None

ABSENT: None

Motion carried.

CITIZENS' PETITIONS

None.

VILLAGE PRESIDENT'S REPORT

President Cauley announced the promotion of Tim McElroy to the newly created position of Assistant Fire Chief. He described Tim's 35 year service to the Village. As Assistant Fire Chief, Tim will oversee day-to-day administration of the Fire Department and will direct operations for the Fire Prevention Bureau. The fire inspector position Tim has held for the past ten years will be restructured to use part-time staff, resulting in substantial savings to the the Village without compromising service. He further commented it is a credit to Tim to see so many firefighter's present tonight to show their support. The hard work and dedication of the Fire Department is greatly appreciated.

CONSENT AGENDA

President Cauley read the Consent Agenda as follows:

Items Recommended by Administration & Community Affairs Committee

Item A: Ordinance Amending Title 3 (Business and License Regulations), Chapter 2 (Municipal Occupation Taxes) of the Village Code of Hinsdale to Establish a Non-Home Rule Municipal Retailers' Occupation Tax and a Non-Home Rule Municipal Service Occupation Tax

Item B: Approve a Request from Hinsdale Platform Tennis Association to solicit for donations and to sell Lifetime Memberships in order to generate funds for Two Additional Platform Tennis Courts at KLM

Trustee Angelo moved to **approve the Consent Agenda, as presented.** Trustee Schultz seconded the motion.

AYES: Trustees Angelo, Saigh, LaPlaca, Williams, Geoga, Schultz

NAYS: None

ABSTAIN: None

ABSENT: None

Motion carried.

ADMINISTRATION AND COMMUNITY AFFAIRS

Accounts Payable

Trustee Schultz moved **Approval and Payment of the Accounts Payable for the Period of December 11, 2010 through December 22, 2010** in the aggregate amount of \$573,448.61 as set forth on the list provided by the Village Treasurer, of which a permanent copy is on file with the Village Clerk. Trustee Geoga seconded the motion.

AYES: Trustees Angelo, Saigh, LaPlaca, Williams, Geoga, Schultz

NAYS: None

ABSTAIN: None

ABSENT: None

Motion carried.

Ordinance Placing a Referendum on the April 5, 2011 Consolidation Election Ballot Regarding whether the Village Clerk of the Village of Hinsdale should be Appointed by the Village President with the Advise and Consent of the Board of Trustees rather than Elected

President Cauley introduced the matter stating it had been taken up at ACA, but there was a division of views. He explained that the Village Clerk position is currently an elected position which pays \$400.00 per month. The position has been vacant for two years, and will be for two years moving forward as no one has come forward to run for the position. He described the duties of the position and noted that the Village Manager's executive assistant has currently been handling these responsibilities. He also noted that this is a purely administrative position and that Village business would run more smoothly if the Clerk were a member of the Village staff. President Cauley stated that he cannot appoint the current Deputy Clerk to the position because that person must be a resident of Hinsdale. If the position is changed to an appointed position, Ms. Bruton can be appointed. However, this can only be done by referendum; the ordinance before the Board tonight accomplishes this. He believes this referendum question should be placed on the April 5th ballot because 1) an appointed clerk would eliminate the administrative bottleneck that often results from having an elected clerk; 2) to save the compensation paid to the elected clerk; 3) to give Ms. Bruton the title of Village Clerk as she has performed the functions of the Clerk for the last two years and will continue to do so for the foreseeable future.

In response to the questions of Trustee Schultz, it was confirmed that the term of the Clerk is concurrent with that of the Village President and that 'advice and consent of the Village Board' is consistent with the current practice of appointments to Boards and Commissions. Trustee Williams stated that she will vote no on the matter as she does not believe it is right to take this away from a resident, further it takes away the democratic process and she does not appreciate the aspersions cast upon the previous Clerk. Trustee Angelo disagrees because there are no policy setting implications with this position and there needs to be someone involved on a daily basis. Trustee Saigh noted the excellent qualifications of the previous Clerk, but her personal circumstances changed and she returned to her career. Given the administrative functions of the position, having some flexibility to make an appointment would be warranted. Trustee LaPlaca stated that this would not impact any democratic process and makes more sense for it to be a staff member. Trustee Geoga commented that this is an administrative position and should be handled that way.

Trustee Angelo moved to approve an **Ordinance Placing a Referendum on the April 5, 2011 Consolidation Election Ballot Regarding whether the Village Clerk of the Village of Hinsdale should be Appointed by the Village President with the Advise and Consent of the Board of Trustees rather than Elected.** Trustee Saigh seconded the motion.

AYES: Trustees Angelo, Saigh, LaPlaca, Geoga

NAYS: Trustees Williams and Schultz

ABSTAIN: None

ABSENT: None

Motion carried.

ENVIRONMENT AND PUBLIC SERVICES

Trustee LaPlaca reported that the initial meeting with the engineers for the Oak Street redesign and replacement has taken place. She encouraged residents and interested parties to contact Village Manager Cook regarding the community advisory committee. Information will be posted on website.

ZONING AND PUBLIC SAFETY

None.

REPORTS FROM ADVISORY BOARDS AND COMMISSIONS

None.

STAFF REPORTS

None.

CITIZENS' PETITIONS

None.

TRUSTEE COMMENTS

None.

ADJOURNMENT

President Cauley stated there is no need for a Closed Session of the Village Board tonight. There being no further business before the Board of Trustees, Trustee Angelo **moved to adjourn the meeting of January 4, 2011.** Trustee Saigh seconded the motion.

AYES: Trustees Angelo, Saigh, LaPlaca, Williams, Geoga, Schultz

NAYS: None

ABSTAIN: None

ABSENT: None

Motion carried.

Meeting adjourned at 7:52 p.m.

ATTEST: _____
Christine M. Bruton, Deputy Village Clerk

DATE: January 10, 2011

REQUEST FOR BOARD ACTION

AGENDA		ORIGINATING Community		
SECTION NUMBER EPS Consent Agenda		DEPARTMENT Development		
ITEM Award SEC Group, Inc., An HR Green Company, Engineering Services to Develop Bidding Documents and Construction Observation of the 2011 Road Resurfacing Project		APPROVAL Daniel M. Deeter Village Engineer		
<p>The Village is developing a 2011 Road Resurfacing program to include portions of First Street, Third Street, Columbia, Pamela Circle, Charleston, and Old Mill Street (see attached). The resurfacing project will include replacement of ± 2500 feet of water main and lining ± 440 feet of sanitary sewer. Feasibility studies will be conducted on the localized drainage issues at 8th Place, Fifth & Grant, and N. Madison to develop alternatives and cost estimates.</p> <p>After reviewing the qualifications of consultants we have previously worked with, staff is recommending SEC Group, Inc., An HR Green Company, to develop the bid documents, support the bidding process, and to conduct the construction observation during construction.</p> <p>Should the Committee concur with this request, the following motion would be appropriate:</p> <p>Motion: To Award the Engineering Services for the Development of Bidding Documents and Construction Observation of the 2011 Road Resurfacing Project to SEC Group, Inc., an HR Green Company, in the amount not to exceed \$89,530.00.</p>				
APPROVAL	APPROVAL	APPROVAL	APPROVAL	MANAGER'S APPROVAL
COMMITTEE ACTION: At the Environment and Public Services Committee meeting on January 10, 2011, the committee approved the motion unanimously.				
BOARD ACTION:				

MEMORANDUM

TO: Chairman LaPlaca and EPS Committee
FROM: Engineering Department
DATE: January 10, 2011
RE: 2011 Resurfacing Project

1. The project consists of milling, base repair (patching), and resurfacing of the existing residential streets with hot mix asphalt as well as utility improvements. The 2011 Resurfacing program will include the following areas:

Street Name	From	To	Est. Dist. (LF)	Scope
First Street	County Line	Columbia	1574	2" Surface Removal & Replacement (R&R)
			656	Replace 6" WM w/8" WM CLR to Princeton
Third Street	County Line	Hill Crest		Crack control treatment
	Hill Crest	Columbia	1427	2" Surface R&R/PCC repair
	Hill Crest	Princeton	440	Lining/repair 48" brick sewer
Columbia	First	Third	640	2" Surface R&R & mid-block storm sewer
Pamela Circle	West End	East End	1036	2" Surface R&R
	Oak	County Line	610	Replace 6" WM w/8" WM
Charleston	West End	County Line	2446	2" Surface R&R
	Elm	County Line	1250	Replace 6" WM w/8" WM
Old Mill Road	York	Road D	500	2" Surface R&R
Various Locations				Adjusting Manholes

2. To not delay the construction of the areas above, Feasibility Studies will be conducted to develop alternatives and cost estimates for the following Localized Drainage areas:

Eighth Place	Madison	East End	344	2" Surface R&R
	Eighth Place	Eighth St.	700	15" Storm Sewer
Grant	Fifth	Sixth	290	24" Storm Sewer
Sixth	Grant	Vine	425	24" Storm Sewer
Monroe	Ogden	Mid-block	1240	15" Storm Sewer

cc: President and Board of Trustees
 David Cook

**Consultant Qualification Analysis
2011 Resurfacing Project**

	JJ Benes & Assoc.	Clark Dietz, Inc.	SEC/HR Green Co.
Consultant has experience working on projects in Hinsdale? - Understands ordinances, expectations, residents, and staff of Hinsdale?	8	8	8
Consultant has experience with public relations issues and procedures? - Has successfully handled public relations issues in Hinsdale or other similar municipalities?	8	8	8
Consultant has demonstrated a working relationship with the municipal customer? - Understands the staff and board's goals and requirements? - Provides well thoughtout, planned, and timely service?	8	8	8
Consultant has demonstrated quality engineering work? - Has successfully accomplished similar jobs in Hinsdale or similar municipalities? - Has experienced professionals managing and observing the project who are familiar with the technical requirements and IDOT rules & regulations?	7	8	9
Overall Rating	31	32	33

Scoring

Meets or exceeds all of the the requirement.	10
Meets most conditions of the requirement.	5
Marginally meets the requirement.	1
Does not meet the requirement.	0

DATE: January 10, 2011

REQUEST FOR BOARD ACTION

AGENDA		ORIGINATING		
SECTION NUMBER Village Board Consent Agenda Item		DEPARTMENT Community Development		
ITEM Request for Village Participation in Addressing Localized Drainage Area #47		APPROVAL Daniel M. Decter Village Engineer		
<p>The backyard area of the southern half of the 700-block between S. Lincoln and S. Washington Streets is identified in the Village Stormwater Master Plan as Localized Drainage Area #47. The Stormwater Master Plan proposed that a private storm sewer could transport water from the back yards to a public storm sewer on 8th Street.</p> <p>During the re-construction of 8th Street in 2008, the Village provided a storm sewer structure for the future private line to connect into. During 2010, the residents of this area have developed a plan to construct a private 8-inch storm sewer line from Drainage Area #47 to the 8th Street Storm Sewer. The cost of this storm sewer (including engineering) is \$36,500.</p> <p>Under the Village's Localized Drainage Plan, the cost of projects established solely to alleviate private property flooding can be split 80/20 where the residents' are responsible for 80%. The residents of the 700-block of S. Lincoln and S. Washington are requesting that the Village provide 20% or \$7,300 to address this drainage issue. The Village will provide the funding when residents have presented all invoices at the end of the project.</p> <p>Motion: To Approve the Payment of 20% of the Construction and Engineering Costs or No More Than \$7,300 to Impacted Local Residents to Alleviate Flooding on Private Property Known as Localized Drainage Area #47 Once the Village has Received and Approved the Construction and Engineering Invoices.</p>				
APPROVAL	APPROVAL	APPROVAL	APPROVAL	MANAGER'S APPROVAL
COMMITTEE ACTION: At the Environment and Public Services Committee meeting on January 10, 2011, the committee approved the motion unanimously.				
BOARD ACTION:				

11.0 Sheet 20

Village of Hinsdale

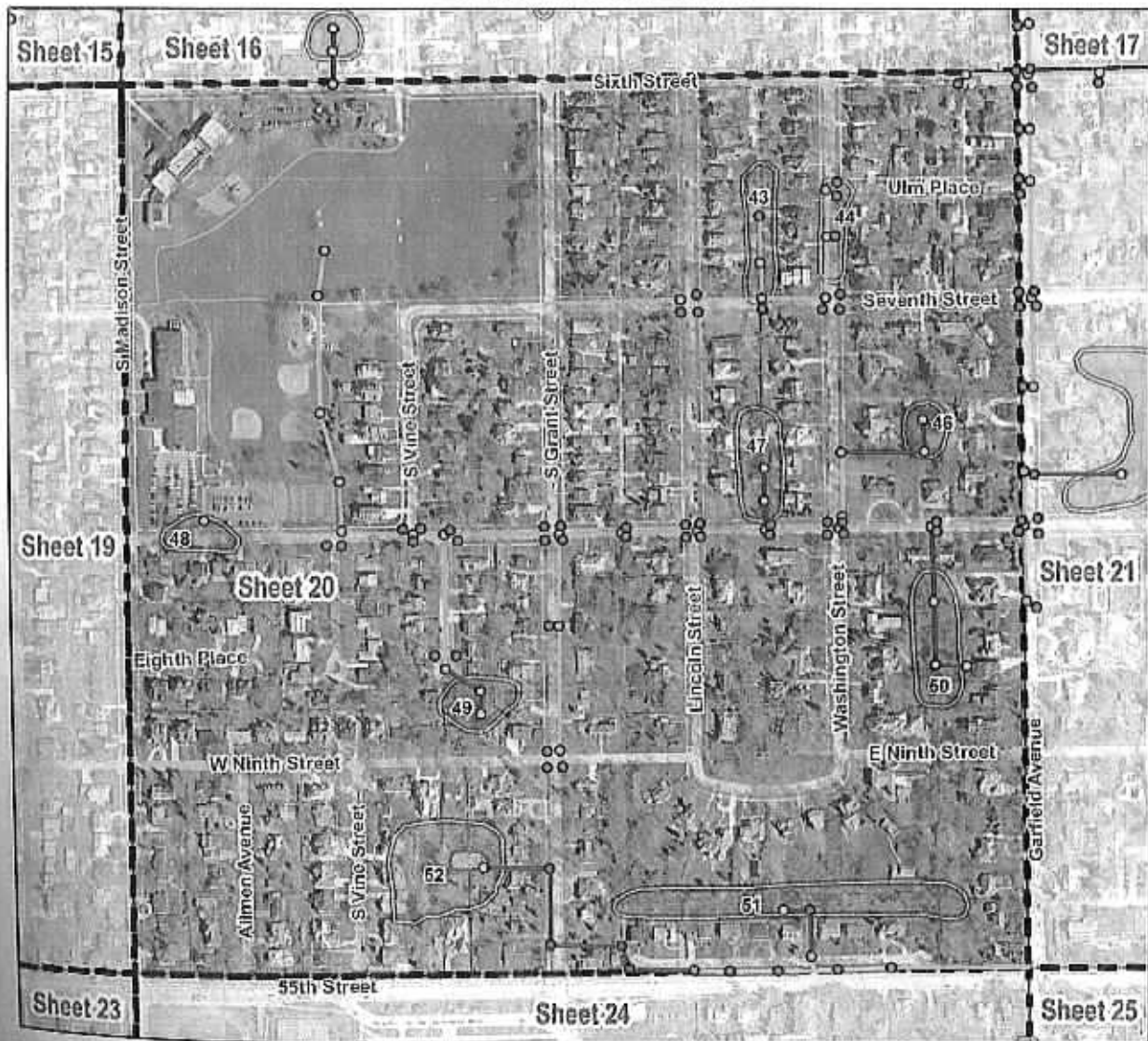
Flooded Problem Areas
Village Sewer Atlas Sheet 20**Legend**

- | | |
|----------------------------|--------------------------|
| Proposed Ditch Cleaning | Proposed Sewer (Private) |
| Proposed Inlet (Private) | Proposed Sewer (Village) |
| Proposed Inlet (Village) | Identified Problem Areas |
| Proposed Manhole (Private) | |
| Proposed Manhole (Village) | |

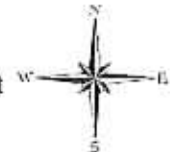
0 125 250 500
Feet**Larger Details are Shown for:**

Area 43 and Area 44
Area 48
Area 51
Area 52

Jeff Holland
723 S. Lincoln
Hinsdale, IL 60521
jeffreyjh2@comcast.net
630-674-7226

December 7, 2010
Chairperson Laura LaPlaca, EPS
In Care of Dan Deeter Village of Hinsdale Engineer

Mrs. LaPlaca,

The 700 Block of South Lincoln Street has been determined by the Village of Hinsdale to having drainage issues. This area has been identified by the Village as a "Flooding Problem Area" in the Village Sewer Atlas Sheet 20. These issues have also been documented by the village engineer, and the village engineer has encouraged us to attempt to solve the problem.

I am working with the neighbors affected by these drainage problems and recently our neighborhood has worked together to develop a plan to resolve our drainage issues, and we would like to be considered for cost sharing through the village.

We have already hired a civil engineer for \$5,000 and would like to proceed with cost sharing on the full project including the civil engineer's fees.

At this time, we plan on proceeding with the 8" bored pipe solution by McGuire and Sons, Inc. for \$30,000. We anticipate the engineer will charge us an additional \$1,500 for supervision. The total project cost is estimated to be \$36,500.

Attached is a copy of our plan and bids received.

Sincerely yours,



Jeffrey Holland



1661 Aucutt Road - Montgomery - IL 60538
Tel: (630) 801-7927 - Fax: (630) 701-1385

September 09, 2010

Via Email

Mr. Bruce Mantia
729 S. Lincoln Street
Hinsdale, IL 60521
Phone: 630-654-8650
Fax: 630-981-1151
Email: bjmantia@gmail.com

SUBJECT: PROPOSAL FOR ENGINEERING AND SURVEYING SERVICES DRAINAGE IMPROVEMENTS IN HINSDALE, ILLINOIS

Dear Bruce:

Ridgeline Consultants, LLC (RC) (Consultant) is pleased to submit its proposal to provide Engineering and Surveying services to Mr. Bruce Mantia (Client). Services are concerning the drainage improvements in the eastern yards of the adjoining residential properties located at 723, 729, 733, 739 S. Lincoln and 23W 8th Street.

Upon speaking with Mr. Al Diaz of Village of Hinsdale on 09/08/10, RC offers to complete the following Professional Services for the lump sum fees as detailed below:

1. Topographic and Boundary Survey

\$2,850.00

Prepare a Topographic and Boundary Survey of the subject properties signed and sealed by an Illinois Professional Land Surveyor. This survey would include sufficient spot elevations to generate 1 foot contours within the eastern yards of the subject properties and offsite area to the north, the south and the east adequate to determine the immediate offsite drainage pattern. We will place a J.U.L.I.E. request prior to our field work and include the utility markings in the survey. We will include existing above ground structures and visible utilities as required for civil engineering design purposes. All trees with 6" in diameter or greater in the rear yards will be identified in the Survey. The topographic survey will be based on Village of Hinsdale datum. Based on our research into the latest FEMA flood maps, there is no regulatory floodplain/floodway on site and immediately offsite that would impact the permitting process.

2. Final Engineering Plans

\$1,400.00

We will prepare a Final Engineering Plans for the proposed improvements which will likely be storm sewers with the appurtenant structures running within the subject rear yards and discharging into the existing catch basin on the north curb of 8th Street. The plans will include specification, construction details, existing site demolition, detailed utility design, detailed grading and Erosion Control design. Once the plan is approved by the Village, upon client's request, we will furnish a number of sewer contractor contacts for bidding. The fees quoted herewith include all necessary plan revisions in order to secure the Village's approval. As confirmed by Mr. Diaz, Village of Hinsdale is the only governmental entity where the permit is required.

Also, it is our suspicion that the stripe of lands adjacent to the rear lot lines of the subject properties were reserved for the public utility purpose (electricity, cable, phone & possibly gas) when the original 16' wide alley was vacated. It is likely that the proposed storm sewers will be running outside of this stripe of lands unless the followings hold true.

- a. these lands were also reserved for the drainage purpose and
- b. the existing utilities within this stripe does not pose difficulties for construction.

The restrictions and rights associated with this stripe of lands will be researched and the routing of the proposed storm sewers will be studied.

3. Plat of Easement Preparation (If Necessary)

\$750.00

Since the proposed storm sewers will be privately owned, a normal Plat of Easement process dedicating the easement to the Village will not be necessary. Therefore, Village does not require a Plat of Easement. However, if the proposed storm sewers will be running outside the stripe of lands immediately west of the rear lot lines, for a better record keeping, we do recommend having a Plat of Easement prepared so that the boundaries of such an easement will be legally described. This Plat of Easement will have the terms and restrictions associated with the easement, signed off by all affected property owners and recorded in DuPage County Recorder's office. Please note that the fee quoted herewith only covers the preparation of the Plat, and not includes the coordination of getting the plat signed and recorded.

The terms of the attached Rider are hereby incorporated and made a part of this proposal. If the above is acceptable, please have this proposal executed. We will begin work as soon as we receive an executed copy. This proposal will be invalid if not accepted by June 30, 2011.

Thank you again for the opportunity to submit this proposal, and should you have any questions or need additional information, please do not hesitate to contact us.

Very truly yours,

Ridgeline Consultants, LLC

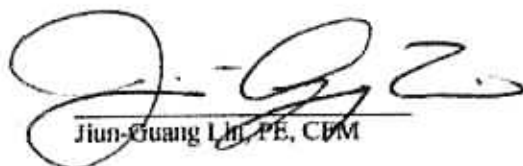

Jun-Guang Lin, PE, CFM

ACCEPTED:

By: _____

Date: _____

RIDER

CONTROLLING LAW - This Agreement is to be governed by the law of the State of Illinois. The parties agree that any claims, disputes, actions or causes of action arising out of this Agreement or relating to the breach thereof shall be brought before a court of proper jurisdiction in Kane County, Illinois, except that Ridgeline Consultants, LLC (RC) may bring an action to enforce any lien against the Property in the county where the Project is located.

CURE PERIOD - If during the Project term, Client observes or becomes aware of any improper service which has been provided by RC, Client agrees to immediately notify RC of the same. RC shall then have five working days to cure, or begin to cure in a diligent manner, such improper service before Client may exercise its rights under any default and remedy provision provided for in this Agreement.

RC'S RELIANCE ON INFORMATION PROVIDED - Client agrees to provide RC with all requested information needed for RC to perform its services. RC is entitled to rely on the accuracy and completeness of any information furnished to RC by or on Client's behalf.

PERMITS AND FEES - Unless the Agreement specifically provides otherwise, Client shall be responsible for obtaining and paying for all applications and permits. RC does not warrant, represent or guarantee that any permits or approvals will be issued.

PREVAILING PARTY - In the event of a dispute amongst the parties, the parties agree that the prevailing party to such a dispute shall be entitled to receive from the other party all court costs and expenses, including reasonable attorneys' fees, which the prevailing party incurred in such action.

ADDITIONAL SERVICES - Authorized extra or additional work not specifically included in the Scope of Services set forth in the foregoing proposal may be performed at the hourly rates set forth below or an agreed upon lump sum fee. CLIENT shall authorize all such extra or additional work before commencement of such extra work. Line and grade stakes shall be set one time under the provisions of this Agreement. Client shall notify RC that stakes shall be needed at least two (2) working days in advance. Additional Surveying or Engineering services will be completed by RC at the hourly rates shown herein, and will be completed only after receipt of a signed or verbal authorization.

The Ridgeline Consultants, LLC, Hourly Rates

Staff Member	Rate
Field Survey Crew	\$125.00
Professional Engineer or Land Surveyor	\$100.00
Office	\$ 50.00

PAYMENT - RC shall render invoices to the CLIENT from time to time as services are provided to CLIENT on a percentage of completion basis plus reimbursable expenses. CLIENT shall promptly review invoices and notify RC of any objection thereto; absent such objection in writing within twenty (20) days after the date of the invoice, the invoice shall be deemed proper and acceptable. Invoices shall be due and payable when rendered. In the event any invoice is not paid within thirty (30) days after rendering of the invoice or within the time period per the Agreement, it shall commence bearing interest at the rate of 18% per annum and CLIENT agrees to pay all accrued interest, together with the charges for services rendered. The RC, at its discretion, may suspend further performance until the default is cured and shall have the right to retain all documents and materials prepared by the RC. RC shall be entitled to recover all costs, including attorneys' fees incurred in enforcing any provision of this agreement. All payments thereafter received from Client will be credited first to interest and then to principal. In the event of a disputed or contested billing, no portion of the payment due will be withheld until written notice of the dispute or contest is given to RC and thereafter only that portion so disputed or contested may be withheld from payment, and the undisputed or uncontested portion will be paid.

REIMBURSABLE EXPENSES - RC shall render invoices to CLIENT from time to time for all reimbursable items such as fees, permits, bond premiums, title company charges, special travel, delivery charges, long distance telephone calls, blueprints and reproductions and all other charges and expenses not specifically covered by this agreement. In the event reimbursable items are to be paid by RC, then such charges and expenses shall be invoiced at direct cost plus 20% for handling.

OWNERSHIP OF DOCUMENTS - All original sketches, drawings, computations, computer files, electronic media, survey notes, plans, specifications, and other documents prepared by RC are and shall remain the property of the RC, notwithstanding the filing with a government agency. So long as CLIENT is not in default under this Agreement, CLIENT shall have the right to use copies of such materials in connection with its Project, but CLIENT shall acquire no additional rights to any of such materials. These copies may be of a reproducible nature, but will not include the original tracings or signatures.

LIMITATION OF LIABILITY - RC warrants that services contemplated by this Agreement shall be rendered in accordance with good professional practices consistent with the standard of the industry where the Project is located. Except as set forth above, RC makes no representation or warranty of any kind regarding the services to be rendered and specifically disclaims any warranty of merchantability or fitness for any particular purpose or that any governmental entity having jurisdiction over the Project will approve or consent to the Project or the work performed by RC. CLIENT and persons claiming through CLIENT agree to limit the liability of the RC, its agents, and employees, for all claims arising out of, in connection with or resulting from the performance of services under this Agreement to an amount in the aggregate of the amount of fees paid under this agreement. CLIENT acknowledges that the RC is a limited liability company and agrees that any claim made by the CLIENT arising out of any act or omission of any director, officer or employee of the RC, in the execution or performance of this Agreement, shall be made against the RC and not against such director, officer or employee personally.

McGuire & Sons Inc.

12250 Shirley Lane
Alsip, IL 60803
312 914-8591
Fax 815 469-6968

Dec. 2, 2010

PROPOSAL

Jeff Holland
723 S. Lincoln
Hinsdale, IL 60521

REAR YARD STORM SEWER

Directional Bore and provide and install 350' of 8" HDPE poly pipe SDR11. Includes all pipe fusions and pulling head. We will install 3 24" ADS Basins with lids. We will leave 6" stubs for each lot that is marked on the plan.

TOTAL LABOR & MATERIALS \$30,000.00

FOR 6" HDPE TOTAL \$21,000.00

NO PERMIT FEES

*MAINT more on smaller pipe
lay 6" a little steeper.
Agreement includes maintenance
- Needs to be recorded up County
8" all the way.*

Aurora Underground LLC
965 Edwards St.
Aurora, IL 60505

1/3
Estimate

Date 11/23/2010
Estimate # 614

Name / Address

Bruce Mantia
739 S. Lincoln St.
Hinsdale, IL

P.O. #

Terms

Due Date 11/23/2010
Other

Description	Qty	Rate	Total
1) Directional Boring - auger 16" hole	350	45.00	15,750.00
2) PVC pipe, tees, Nyoplast drains, etc.		10,970.00	10,970.00
3) Stone, dirt removal, misc. materials, etc.		3,450.00	3,450.00
4) Machine time and labor		13,112.00	13,112.00
5) Landscape restoration - topsoil and sod		2,497.00	2,497.00

*2000 less
for 8" pipe*

*\$ 2,000 less for 8" pipe per phone
conversation*

3 pages. See page 2 for Terms and Conditions and page 3 for Unit Pricing

Subtotal	\$45,779.00
Sales Tax (0.0%)	\$0.00
Total	\$45,779.00

Aurora Underground LLC

630.742.9624
Fax 630.851.7123

Aurora Underground LLC

excavating * sewer * water

965 Edwards St.

Aurora, IL 60505

630.742.9624 off

630.851.7123 fax

Terms & Conditions

RE: Backyard Drainage Dev. – Block 12, Getchell's Resub.

Estimate #: 614

23 November, 2010

We hereby propose to furnish labor and materials – complete in accordance with the above/previous specifications for forty-five thousand seven hundred seventy-nine dollars (\$45,770) plus any additional and/or applicable T&M/proposed services charges, to be paid net 7 upon submission of invoices, with 1 ½ % interest monthly charged on outstanding balances, plus any fees/costs including, but not limited to, attorney's fees and court costs incurred trying to collect said balance. Payment and acceptance of our work is not to be delayed because of others delaying acceptance of our work. This proposal is specific; nothing should be assumed, as nothing has been inferred. This proposal is line item specific. No additional work should be assumed to be included in the scope of any other work. Proposal does not include stone or dirt removal or grading or any type of concrete removal/work or demolition or stump removal or winter service unless clearly specified. Backfill is defined as placing of excavated material into outside overdigs, not grading, clean up, or leveling of site subgrade. If bedrock or unsuitable soil is encountered and must be removed, it will be done on a T&M basis, and will become an extra charge over and above the estimate. This proposal supersedes any and all written or verbal agreements and is per print/grading plan/site plan if applicable. This proposal was written using drawing by Ridgeline Consultants, LLC, dated 11/11/10. The men and equipment described above with standard attachments will be used in a manner that is consistent with normal operation for the work in which it is hired. Does not include any fees or permits. All applicable fees/permits to be paid for by others. All work to be completed in a workmanlike manner according to standard practices. No irregular or special circumstances or conditions of any kind have been considered as a part of, or to accomplish, work. Assumes all work will be done contiguously unless otherwise noted. Any and all utilities, landscape features, trees, etc. that interfere with execution of work must be removed prior to start of job. Any alteration or deviation from above specifications involving extra costs, will be executed only upon written orders, and will become an extra charge over and above the estimate. If obtaining written orders to perform extra work is delayed by more than two hours or if completion of extra work by others which prohibits Aurora Underground from completing their contracted work exceeds two hours and results in the redeployment of men or equipment, additional charges will apply(see attached T&M price list). All agreements contingent upon strikes, accident, and/or delays or pricing beyond our control. Aurora Underground has the option to revoke estimate after 30 days if not accepted. Aurora Underground has option to cancel remaining contract due to slow or non-payment, with executed work to be paid for as outlined above with additional charges for redeployment of men & equipment(see attached T&M price list) to be paid as outlined above.

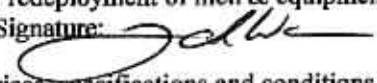
Authorized Signature: 

With a complete understanding, the above prices, specifications and conditions are hereby accepted. You are authorized to do the work as specified. Payment will be made as outlined above. Authorized Signature: _____ Date: _____

Time & Material/Unit Pricing

Equipment(4 hr min. + mobilization [price per equip. hourly en route shop to shop])

Cat 320 Hydraulic Excavator	\$	140 per hour
Cat 315/Volvo 160 Hydraulic Excavator	\$	135 per hour
Cat 953/955 Loader	\$	135 per hour
Case 855 Loader	\$	100 per hour
Cat D3 Dozer	\$	105 per hour
Cat D5 Dozer	\$	115 per hour
Vibratory Compactor	\$	105 per hour
Cat 416/Volvo 90LB Rubber Tire Backhoe	\$	115 per hour
Skidsteer or Mini-excavator	\$	90 per hour
Frost Removal (excavator)	\$	195 per hour
Labor, Mobilization <10,000#, 2.5-Scy dump	\$	80 per hour
Six-Wheeler Dump truck	\$	85 per hour
Semi-Dump truck	\$	95 per hour
Mobilization >10,000#/Lowboy (permits not included)	\$	115 per hour

Gravel Installed(priced per ton for entire load; part. loads per ton + cartage)

CA-7 or equal	\$	22.00 per ton
CA-1 or equal	\$	21.00 per ton
CA-6 or equal	\$	20.00 per ton

Load & Haul Fill(no partial loads, any size load is considered a full load)

Load & Haul fill on site	\$	10 per loose cubic yard
Load & Haul fill off site	\$	25 per loose cubic yard
Haul in topsoil or Fill from off-site	\$	20 per loose cubic yard

SUBJECT TO CHANGE WITHOUT NOTICE.

PROPOSAL

H & R Construction, Inc.
6 Wild Plum Court
Lemont, Illinois 60439
Phone: 630-968-3581
FAX: 630-257-0073

No: 5292
Date: 12/7/10

Proposal Submitted To:		Work To Be Performed At:	
Name: Jeff Holland		Street: Lincoln St	
Street:		City: Hinsdale	
City:	State: Illinois	State: Illinois	Zip:
Zip:	Phone:		

We hereby submit specifications and estimate for:

8th & Lincoln Storm Sewer: Bore in place approx. 350 LF of 8" HDPE storm sewer. Connect to existing storm inlet. Install 3- 24" nylo plast drain basins. TOTAL \$ 42,000.00. ** If 12" HDPE pipe used add \$ 18,500.00 to price.

#23: 6" raiser, drain pipe, 12X12 yard basin. \$ 1,900.00

#739: 6" raiser, drain pipe, 12X12 yard basin \$ 1,900.00

#733: 6" raiser, drain pipe, 12X12 yard box \$ 2,300.00

#729: Raiser pipe, drain pipe, 12X12 yard inlet \$ 1,900.00

#723: Raiser pipe, drain pipe, 12X12 yard inlet \$ 1,900.00

#717: Raiser pipe, drain pipe, 12X12 yard inlet \$ 1,900.00

#736: Raiser pipe, drain pipe, 12X12 yard inlet \$ 1,900.00

#724: Install 4" PVC storm sewer. Install 16 ft. of channel grate. Remove 2ft wide blacktop drive. Re pour w/ 8" thick concrete to finished grade \$4,000.00

**All yard restoration by others. No permits. Yards drain connections to storm sewer to be trenched in w/ mini excavator. Rear yard axcess will be needed.

We propose to furnish labor and materials-complete in accordance with the above specifications, for the sum of _____ dollars (\$ _____) with payment to be made as follows:
upon completion _____

All material is guaranteed to be as specified. All work to be completed in a workmanlike manner according to standard practices. Any alteration or deviation from above specifications involving extra costs, will be executed only upon written orders, and will become an extra charge over and above the estimate. All agreements contingent upon strikes, accident or delays beyond our control This proposal subject to acceptance within 30 days and is void thereafter at the option of the undersigned.

Licensed- Bonded -Insured

Authorized Signature _____

ACCEPTANCE OF PROPOSAL

The above prices, specifications and conditions are hereby accepted. You are authorized to do the work as specified. Payment will be made as outlined above.

ACCEPTED:

DATE _____

SIGNATURE _____

PLEASE SIGN ONE COPY AND RETURN

AGENDA SECTION	ACA	ORIGINATING DEPARTMENT	Finance
ITEM	Accounts Payable	APPROVED	Darrell Langlois Assistant Village Manager/Director of Finance
<p>At the meeting of January 18, 2011 staff respectfully requests the presentation of the following motion to approve the accounts payable:</p> <p>Motion: To move approval and payment of the accounts payable for the period of December 23, 2010 through January 07, 2011 in the aggregate amount of \$1,099,450.09 as set forth on the list provided by the Village Treasurer, of which a permanent copy is on file with the Village Clerk.</p>			
STAFF APPROVALS			
APPROVAL	APPROVAL	APPROVAL	MANAGER'S APPROVAL 
COMMITTEE ACTION:			
BOARD ACTION:			

VILLAGE OF HINSDALE

ACCOUNTS PAYABLE WARRANT REGISTER #1494

FOR PERIOD December 23, 2010 through January 07, 2011

The attached Warrant Summary by Fund and Warrant Register listing TOTAL DISBURSEMENTS FOR ALL FUNDS of \$1,099,450.09 has been reviewed and approved by the below named officials.

APPROVED BY _____ DATE _____
VILLAGE TREASURER/ASSISTANT VILLAGE MANAGER

APPROVED BY _____ DATE _____
VILLAGE MANAGER

APPROVED BY _____ DATE _____
VILLAGE TRUSTEE

**Village of Hinsdale
Warrant # 1494
Summary By Fund**

Recap By Fund	Fund	Regular Checks	Pension Checks	ACH/Wire Transfers	Total
Corporate Fund	10000	385,971.70	-	-	385,971.70
Motor Fuel Tax Fund	23000	5,140.15	-	-	5,140.15
Capital Project Fund	45300	10,203.75	-	-	10,203.75
Water & Sewer Operations	61061	142,047.83	-	-	142,047.83
Police Pension Fund	71100	200.00	55,549.48	-	55,749.48
Firefighter's Pension Fund	71200	17,422.00	73,402.24	-	90,824.24
Payroll Revolving Fund	79000	9,898.64	-	356,595.30	366,493.94
Library Operations	99000	43,019.00	-	-	43,019.00
Total		613,903.07	128,951.72	356,595.30	1,099,450.09

Village of Hinsdale
Schedule of Bank Wire Transfers and ACH Payments
Warrant Register # 1494

Payee/ Date	Description	Vendor Invoice	Invoice Amount
Intergovernmental Personnel Benefit Cooperative 1/3/2011	January 2011 Contribution	Employee Health Insurance	145,010.05
Electronic Federal Tax Payment Systems 1/7/2011	Village Payroll # 1-Calendar 2011	FWH	46,009.53
Electronic Federal Tax Payment Systems 1/7/2011	Village Payroll # 1-Calendar 2011	FICA/MCARE	30,190.15
Illinois Department of Revenue 1/7/2011	Village Payroll # 1-Calendar 2011	State Tax Withholding	9,921.91
DuPage Credit Union 1/7/2011	Village Payroll # 1-Calendar 2011	Employee Withholding	5,510.19
ICMA - 457 Plans 1/7/2011	Village Payroll # 1-Calendar 2011	Employee Withholding	12,643.28
HSA Plan Contribution 1/7/2011	Village Payroll # 1-Calendar 2011	Employee Withholding	1,663.74
HSA Plan Contribution 1/7/2011	Village Payroll # 1-Calendar 2011	Employer Contributions	4,125.00
Illinois Municipal Retirement Fund 1/10/2011	Employee/Employer Contributions	December 2010 Wages	83,310.82
Electronic Federal Tax Payment Systems 1/14/2011	Pension Payroll #11- Calendar Year 2011	1/11 Final FWII	<u>18,210.63</u>

Total Bank Wire Transfers and ACH Payments 356,595.30

Total Regular Checks, Pension Checks and Wire Transfers/ACH Payments 1,099,450.09

HINSDALE POLICE PENSION #7173

1494

CHECK DATE	PAYEE	CHECK NUMBER	CHECK AMOUNT
1/14/2011	VIRGINIA POTEMPA	107117	1,000.00
1/14/2011	DOLORES HERMES	107118	1,098.98
1/14/2011	CAROL BAUMGARTEN	107119	1,047.68
1/14/2011	GEORGE DURFOR	107120	1,078.03
1/14/2011	NORA H RICHIE	107121	1,983.21
1/14/2011	KENNETH FELBINGER	107122	3,518.30
1/14/2011	FRANCINE ANDERSON	107123	1,581.08
1/14/2011	JOSEPH M KOZAK	107124	3,107.97
1/14/2011	DANIEL J HETHERINGTON	107125	3,978.70
1/14/2011	PAUL E TULACKA	107126	1,810.11
1/14/2011	WILLIAM M BLAZEJEWSKI	107127	3,103.65
1/14/2011	EDWARD KUBISH	107128	3,546.12
1/14/2011	WILLIAM ZAHALKA	107129	3,195.24
1/14/2011	JAMES ECCARDT	107130	5,477.49
1/14/2011	KELLY WEEKS	107131	3,077.05
1/14/2011	RONALD HOOGSTRA	107132	4,856.57
1/14/2011	PAUL LAMBERT	107133	4,590.72
1/14/2011	ROBERT KRAFT	107134	2,637.04
1/14/2011	RICHARD BIRDSONG	107135	4,260.63
TOTAL POLICE PENSION CHECKS			55,549.48

HINSDALE FIREFIGHTERS PENSION #7176

1494

CHECK DATE	PAYEE	CHECK NUMBER	CHECK AMOUNT
1/14/2011	KENNETH KASPAR	107135	2,301.20
1/14/2011	LLOYD R HEINEMANN	107137	3,209.1
1/14/2011	ROBERT KASPER	107138	3,446.02
1/14/2011	CALVIN JOHNSON	107139	2,641.41
1/14/2011	JOHN P WARGEN	107140	2,332.88
1/14/2011	JOHN L MILLER	107141	2,423.76
1/14/2011	ROBERT L EVANS	107142	4,146.68
1/14/2011	GEORGE C KERINS	107143	2,139.42
1/14/2011	RAY HENSHAW	107144	2,732.77
1/14/2011	STANLEY BULAT	107145	5,671.13
1/14/2011	WILLIAM P EBY	107146	3,415.20
1/14/2011	PATRICK F HEINEMANN	107147	2,172.79
1/14/2011	MARILYN MUSCH	107148	2,672.62
1/14/2011	JOHN MEJDRECH	107149	4,170.29
1/14/2011	MICHAEL E SPIEL	107150	2,117.66
1/14/2011	RICHARD BOCEK	107151	1,306.04
1/14/2011	SCOTT MILLER	107152	3,775.23
1/14/2011	RICHARD CIRCO	107153	2,279.76
1/14/2011	PATRICK KENNY	107154	5,271.12
1/14/2011	THOMAS SENIER	107155	3,488.15
1/14/2011	CHERYL JOHNSON	107156	5,400.21
1/14/2011	THOMAS McCARTHY III	107157	6,288.73
TOTAL FIREFIGHTER'S PENSION CHECKS			<u>73,402.24</u>
TOTAL PENSION CHECKS			<u><u>128,951.72</u></u>

WARRANT REGISTER 4

1494

1/13/11

DATE	DESCRIPTION	VENDOR INVOICE	INVOICE AMOUNT	CHECK NO.	CHECK AMOUNT
SECURITY-FLEXONE					
56117	ALPAC OTHER	010711000000000	264.33		
56118	ALPAC SLAT	010711000000000	204.90		
56119	ALPAC OTHER	010711000000000	258.97		
	CHECK NO.	85068			728.20
COLONIAL LIFE INS. RETIRE					
56112	COLONIAL LIFE	010711000000000	27.63		
56113	COLONIAL LIFE	010711000000000	54.33		
	CHECK NO.	85069			81.96
NATIONAL INTERNAL UNION					
56105	UNION DUES	010711000000000	684.00		
	CHECK NO.	85071			684.00
JUDGMENT CREDITOR					
56110	WAGE GARNISHMENT-MARVAVIG	010711000000000	416.35		
	CHECK NO.	85072			416.35
JUDGMENT CREDITOR 85073					
56119	WAGE GARNISHMENT-M. WALEH	010711000000000	249.03		
	CHECK NO.	85073			249.03
LONG AS TRUSTEE FOR POST					
56113	PHIP REGULAR	010711000000000	2178.82		
56114	PHIP COMPTIME PD	010711000000000	496.93		
56115	PHIPED	010711000000000	578.54		
	CHECK NO.	85074			3254.29
NATIONWIDE RETIREMENT SOL					
56106	USCK/PEBSCO	010711000000000	1630.00		
	CHECK NO.	85075			1630.00
NCFERS GRP LIFE INS 3105					
56104	LIFE INS	010711000000000	256.00		
	CHECK NO.	85076			256.00
STATE DISBURSEMENT UNIT					
56116	CHILD SUPPORT/G. FRANCO	010711000000000	1461.70		
	CHECK NO.	85077			1461.70
STATE DISBURSEMENT UNIT					
56117	CHILD SUPPORT-JUAN MARIN	010711000000000	513.21		
	CHECK NO.	85078			513.21
VILLAGE OF HINSDALE					
56107	MEDICAL REIMBURSEMENT	010711000000000	531.42		

WARRANT REGISTER

1494

1/18/11

PAYEE	DESCRIPTION	VENDOR INVOICE	INVOICE AMOUNT	CHECK AMOUNT
VILLAGE OF HINSDALE				
56106	DMP CASE RECOMMENDMENT	01071100010000	95.00	
56106	MEDICAL REIMBURSEMENT	01071100050000	207.00	
		CHECK NO. 85072		873.90
ATYCAT, ASPA				
56278	TIME REPORT	00101203/19776	20.00	
		CHECK NO. 85073		500.00
AMERICAN MESSAGING				
56117	1/18/11	011531101A	244.00	
		CHECK NO. 85081		244.00
AMERICAN PLANNING ASSOC				
56322	RENEWAL	143095101107	494.00	
		CHECK NO. 85082		494.00
ANDRES MEDICAL BILLING LT				
56129	DECEMBER PREL	27504	1934.96	
		CHECK NO. 85083		1934.96
ATLAS RESTORATION				
56282	CORT BD/419 WARREN TERRAC 19639		500.00	
		CHECK NO. 85084		500.00
ATWELL & ATWELL				
56366	DEC LEGAL FEE	200-12/10	200.00	
		CHECK NO. 85085		200.00
AVAYA FINANCIAL SERVICES				
56140	RENTAL	18380849	78.60	
		CHECK NO. 85086		78.60
BATTERY SERVICE CORP				
56202	BATTERY	205673	559.90	
		CHECK NO. 85087		559.90
BRACON SSI INCORPORATED				
56203	KEYS	68052	261.85	
		CHECK NO. 85088		261.85
BROOKS, ROBERT				
56115	816 NW/223 NORTH EAV	18376	3410.00	
		CHECK NO. 85089		3410.00
BLOOM, BRADLEY				
56143	DAILY PLANS	71045414	48.65	

WARRANT REGISTER

1494

1/18/11

PAYEE	DESCRIPTION	VERSION INVOICE	INVOICE AMOUNT	CHECK AMOUNT
STOCK, BRADLEY		CHECK NO. 85090		65.45
HYUN-DAI RAILROAD				
0127 PUBLIC HEARINGS	A 28-13		205.91	
0128 PUBLIC HEARINGS	A 35-13		316.29	
0129 MPA	M-5-10		580.00	
	CHECK NO. 85091			1062.00
EL PROGRESO DE NUESTRO MUNICIPIO				
0130 RESERVATIONS	01-07		103.00	
	CHECK NO. 85092			103.00
BRAVO PAVING & SEAL CTG				
56275 CONT RD/106 W FOURTH	15545		500.00	
	CHECK NO. 85093			500.00
HUBBARD, TOM				
56129 SAFETY BOOTS	59455		84.19	
	CHECK NO. 85094			84.19
BUTTERBY RENTAL SERVICE IN				
56345 LOG SPLITTER	1222868		90.00	
	CHECK NO. 85095			90.00
CLARA				
56165 UPDATE	02188		130.00	
	CHECK NO. 85096			130.00
CASE LOTS INC				
56182 PAPER GOODS	028120		276.90	
56186 PAPER GOODS	028750		218.55	
56210 PAPER GOODS	028515		328.40	
56355 PAPER GOODS	028934/28942		397.20	
	CHECK NO. 85097			1221.05
ABC RESTAURANT				
56123 PERMIT OVERPAYMENT	140761		5.04	
	CHECK NO. 85098			5.04
ABC SOFTWARE				
56117 MODIFICATIONS	11862		865.00	
	CHECK NO. 85099			865.00
CDW-GOVERNMENT INC.				
56165 LASER PRINTER	VX89063		70.50	
56110 WEB HOSTING	VX86368		1400.00	

WARRANT REGISTER

1494

1/18/11

PAYEE	INVOICE	CHECK
DATE DESCRIPTION	NUMBER	AMOUNT
COFF-GOVERNMENT INC.		
56264 SCANNER	769537907	1511.33
	CHECK NO. 85102	
AS 2000 BLADE TOP CO INC.		
56265 RESURFACING	769534458	10003.75
	CHECK NO. 85101	10003.75
CHILDS SUPPLY CORPORATION		
56273 FIRE EQUIPMENT	7695341740	572.66
	CHECK NO. 85102	572.66
COUGLAS		
56183 RUGS TOWELS ETC	769537907	161.31
56285 RUGS TOWELS ETC	769534458	242.81
56313 RUGS TOWELS ETC	7695341740	242.81
	CHECK NO. 85103	646.93
CUT TECHNOLOGY FIN SERV IN		
56266 ALARM SYSTEM INST/MAINT	7695341740	305.00
	CHECK NO. 85104	305.00
COLORADO STATE PATROL		
56271 RENEWAL	41	300.00
	CHECK NO. 85105	300.00
COMCAST		
56262 FW	0037136-01/11	125.00
56309 WATER DEPT	0036815-01/11	89.95
56310 VILLAGE HALL	0036757-01/11	160.00
56311 PD/PO	0036781-01/11	160.00
56312 KLM LODGE	0036807-01/11	95.00
	CHECK NO. 85106	639.95
COMED		
56227 SAFETY TOWN	7262162005-12/10	16.11
56228 RR	7011157008-12/10	82.48
56229 WALNUT STREET	7011481009-12/10	25.27
56230 PIERCE PARK	7011378007-12/10	69.06
56231 BRIDGE PARK	6605174005-12/10	96.29
56232 ZOO	6505457007-12/10	402.50
56233 VEECH PARK	2405066008-12/10	684.95
56234 WATER PLANT	8521400008-12/10	31.5
56235 FOUNTAIN	0471035006-12/10	252.51
56236 STOUGH PARK	8083480008-12/10	15.16
56237 ELEANOR PARK	6683706102-12/10	50.50
56238 BURNSFIELD	6685640004-12/10	18.26

WARRANT REGISTER

1494

1/19/11

VOIC	DESCRIPTION	VENDOR INVOICE	INVOICE AMOUNT	CHECK AMOUNT
COMM				
56229	ROBBINS PARK	8091683007-12/10	512.50	
56230	TRAIN STATION	8091387001-12/10	555.71	
56240	WALKING HOUSE	0203037006-12/10	310.14	
56242	WASHINGTON	2098029001-12/10	50.54	
56243	CHUCK TOWER	0261097101-12/10	25.19	
56244	CHESTNUT	0203065101-12/10	215.11	
56245	CHUCK PARK	0454035010-12/10	3095.62	
56245	ELM	7093551011-12/10	1232.22	
56247	PARKMAN LOT	1336114011-12/10	44.45	
56247	4TH STREET	0215093060-12/10	540.12	
56249	314 SYMONDS	0617015040-12/10	227.63	
56249	314 SYMONDS	1653148069-12/10	73.44	
56241	SPINNING WHEEL	1131101044-12/10	743.60	
56242	ELEANOR PARK	0075151076-12/10	1036.66	
56242	SALT CREEK	1917016003-12/10	25.29	
	CHECK NO.	85107		11020.51

COMMERCIAL COFFEE SERVICE

56157	COFFEE	104760	62.40	
56177	COFFEE	104815	70.80	
	CHECK NO.	85109		132.40

VOIDED CHECK

VOIDED CHECK

VOIDED CHECK

CHECK NO. 85110

COURTNEY'S SAFETY LANE

56159	SAFETY INSPECTION	4109898	32.00	
	CHECK NO.	85111		32.00

COURTYARD HOMES

56245	SITE RMSE/625 S MONROE	19385	3000.00	
	CHECK NO.	85112		3000.00

CREATIVE PRODUCT SOURCING

56327	DARE MERCHANDIZE	33917	596.50	
	CHECK NO.	85113		596.50

CUTICAL BRANCH

56226	CALANDAR FOR	01227	265.00	
	CHECK NO.	85114		265.00

C.R. GINA

56345	PAID VOIDED TICKET	0410002274	25.00	
	CHECK NO.	85115		25.00

WARRANT REGISTER

1454

1/18/11

PAYER

INVOICE

CHECK

VILL. BROSCHIP.COM

VENDOR INVOICE

AMOUNT

AMOUNT

INVOICE

56104 CLEANING

4214-2/10

4214.00

CHECK NO.

85116

4214.00

Tool: MEDICAL GLOVES

56106 GLOVES

545226

129.00

CHECK NO.

85117

129.00

FLOPPY DISKETTES INC.

56107 STPPEL SHIRTING

44340

8895.00

CHECK NO.

85118

8895.00

DIONICA, MARIE

56288 KLM REFUND

EN101224/19719

337.50

CHECK NO.

85119

337.50

DIGITAL HOME TECHNOLOGIES

56326 COMPUTER

12573

484.27

CHECK NO.

85120

484.27

BLANCK ADVANTAGE INC

56350 WEB HOSTING

4083

3045.00

CHECK NO.

85121

3045.00

DIAMOND CONSTRUCTION LLC

56152 50/50 SIDEWALK RETAINAGE

480-1

5140.15

CHECK NO.

85122

5140.15

DOWNS, TOM

56287 KLM REFUND

EN101219/19428

450.00

CHECK NO.

85123

450.00

DUPAGE COUNTY RECORDER

56351 RECORDING FEES

201011160278

850.00

CHECK NO.

85124

850.00

EAGLE UNIFORMS INC

56175 UNIFORMS

206216/280/203

638.20

CHECK NO.

85125

638.20

EMERGENCY MEDICAL PRD

56305 MEDICAL SUPPLIES

1338361

195.37

CHECK NO.

85126

195.37

EXCEL FASTENER SOLUTIONS

56149 TOOLS

1500

116.75

56119 FITTINGS

1511

387.04

WARRANT REGISTER

1494

1/18/11

PAYEE	WARRANT REGISTER #	INVOICE	CHECK
DESCRIPTION	INVOICE	AMOUNT	AMOUNT
LEWIS PASSENGER SOLUTIONS	CHECK NO. 85127		503.79
EVILAN ENERGY INC	70213990070	1,018.71	
56151 SPARE LENSE	0421730745	477.05	
56152 400 EIM	1004318801-12/10	2321.88	
56153 PARKSFORM	2002286003-12/10	1266.41	
56154 STREET LIGHTS	CHECK NO. 85128		15230.55
56155			
56156 WATER	1507430	705.69	
56160 REFUND PD TO VILLAGE	2443	25.49	
	CHECK NO. 85129		721.09
56161			
56184 OVERNIGHT MAIL	723509516	176.71	
	CHECK NO. 85130		176.71
56135 TIRMS	081805	212.59	
56136 ALIGNMENT	081859	55.00	
	CHECK NO. 85131		267.50
56259 KLM RESPOND	WH01231/19402	306.25	
	CHECK NO. 85132		306.25
56317 ASST HARDWARE	1133304/362	462.96	
	CHECK NO. 85133		462.96
56266 CAR WASHERS/REPAIRS	694459	630.59	
56307 CAR WASHERS/SNOW PLOWING	381403	2986.81	
	CHECK NO. 85134		3617.50
56178 UNIFORMS	1028516220	258.53	
56181 UNIFORMS	1028513655	258.53	
	CHECK NO. 85135		517.06
56187 UNIFORMS	511037102	444.67	
56219 UNIFORMS	923549	99.79	
	CHECK NO. 85136		544.46

WARRANT REGISTER #

1494

1/16/11

PAYEE	WARRANT REGISTER #	INVOICE	CHECK
NO. DESCRIPTION	VENDOR INVOICE	AMOUNT	AMOUNT
PAPEL TECHNOLOGIES			
56390 TIM KINTRO	2010211/19100	500.00	
	CHECK NO. 85140		500.00
AMPCO & SONS P O			
56391 REINFORCEMENT	20101305	325.00	
	CHECK NO. 85138		325.00
SPENCE APPRAISERS CO			
56394 DAN W/552 N VINE	20101	1432.00	
	CHECK NO. 85139		1432.00
SPOR			
56370 ANNUAL DUES	0134001	490.00	
	CHECK NO. 85140		490.00
GULLIANOS			
56201 EMERGENCY DINNERS	123010	55.74	
	CHECK NO. 85141		55.74
GRACE EPISCOPAL CHURCH			
56369 STM WTR/REFUND	18336	2020.00	
	CHECK NO. 85142		2020.00
GRAYNER, INC.			
56142 ADHESIVE	94421220113	6.26	
56179 WATER COOLER	9412275559	601.28	
56316 BAR PLUGS	9424498824	55.36	
	CHECK NO. 85143		662.82
GRANT & POWER LANDSCAPE			
56283 CONT RD/236 N COUNTY LINE 18234		250.00	
	CHECK NO. 85144		250.00
GRANT & POWER LANDSCAPE			
56291 CONT RD/722 CLEVELAND	18166	250.00	
	CHECK NO. 85145		250.00
GRIFFIN, JENNIFER			
56293 KLM REFUND	10010201/18723	500.00	
	CHECK NO. 85146		500.00
LYNN CO			
56316 SUPPLIES	90557901	122.65	
	CHECK NO. 85147		122.65
HANSON AGGREGATES INC			

WARRANT REGISTER II

1499

1/18/11

PAYEE	INVOICE	CHECK
NO. DESCRIPTION	VENDOR INVOICE	AMOUNT
HANSON ASSOCIATES INC		
56111 SAND	5255128	197.00
56125 SAND	5266-88	1,40.33
56126 SAND/WATER SAND	5264445/E/581	1826.01
	CHECK NO. 85143	2,063.34
HERSCHEL CRYSTAL CLEAN		
56127 CLEANING SOLVENT	1515311	350.00
	CHECK NO. 85143	350.00
PELAND PAINTVANT		
56177 PAINT	553315	7.38
	CHECK NO. 85150	7.38
HOME DEPOT CREDIT SERVICE		
56238 ASST SUPPLIES	4103284/8032706	294.60
	CHECK NO. 85151	294.60
JOE BLUEPRINT		
56333 PRINTING	79714/79550/7575	70.75
	CHECK NO. 85153	70.75
LAKE		
56306 RENEWAL	59362	25.00
	CHECK NO. 85153	25.00
LAHDC		
56147 RENEWAL	55361	50.00
	CHECK NO. 85154	50.00
ICE MOUNTAIN WATER		
56321 WATER	08L0120706023	74.46
	CHECK NO. 85155	74.46
IQFOA		
56255 RENEWAL	17000-1/11	170.00
	CHECK NO. 85156	170.00
TR ASSOC OF PARK DISTRICT		
56221 RENEWAL	67159	631.55
	CHECK NO. 85157	631.55
TRAIL		
56171 CONFERENCE	55927	175.00
	CHECK NO. 85158	175.00
FLICO, INC.		

WARRANT REGISTER II

1494

1/18/11

PAYER	DESCRIPTION	VERSION	INVOICE	CHECK
			NUMBER	AMOUNT
56114	ALB VENT	2268000	160.70	
	CHECK NO.	85155		160.70
56116	ILLINOIS ASSOCIATION OF	33600-12/10	370.00	
	CHECK NO.	85160		370.00
56124	PRINTED REPAIRS	547443-001	208.50	
	CHECK NO.	85161		208.50
56133	SQUADS	14274	840.00	
	CHECK NO.	85162		840.00
56173	ELECTRICAL SUPPLIES	193033/034/19274	185.77	
56190	CALCIUM	193194	56.00	
56301	STREET LIGHTS	193413	24.00	
	CHECK NO.	85163		265.77
56191	LIQ CALCIUM	16605	1885.59	
	CHECK NO.	85164		1885.59
56301	WP EXT	48708	168.00	
56321	EXTERMINATING	11162818	208.00	
	CHECK NO.	85165		376.00
56165	RENEWAL	59450	245.00	
	CHECK NO.	85166		245.00
56218	BATTERIES	33012097	177.90	
	CHECK NO.	85167		177.90
56111	TRNG	405053-12/10	405050.00	
	CHECK NO.	85168		405050.00
56165	RENEWAL	59421	40.00	
56117	RENEWAL	59424	40.00	
	CHECK NO.	85169		80.00

WARRANT REGISTER

1494

1/18/11

PAYEE	DESCRIPTION	VENDOR INVOICE	INVOICE AMOUNT	CHECK AMOUNT
W.C. HILFORD & COMPANY				
56177 WEST	23445		105.24	
	CHECK NO.	85170		105.24
W.C. HILFORD & COMPANY				
56178 WEST	23446		104.09	
	CHECK NO.	85171		104.09
BRANTZ & SONS				
56188 INDEPENDENT WAREHOUSE	22102		1232.00	
	CHECK NO.	85172		1232.00
WELLS BRANTZ CO INC				
56132 DILL	81193461N		343.95	
	CHECK NO.	85173		343.95
KENWORTH TRUCK PARTS				
56144 DOOR LATCH	1194131		81.97	
	CHECK NO.	85174		81.97
KH KIMS TAX BROK DO				
56221 CLASS	222750		2227.50	
	CHECK NO.	85175		2227.50
JOHNSON WOODS				
56120 BOARD SUPPLIES	36217675		24.98	
	CHECK NO.	85176		24.98
KROSCHELL ENGINEERING CO				
56192 HVAC	38864/63		1304.00	
	CHECK NO.	85177		1304.00
LAMB, TIMOTY				
56299 REIMBURSEMENT	59506		102.79	
	CHECK NO.	85178		102.79
LAPIERRE, MARTIN				
56277 CONT BD/333 E CHICAGO	19291		500.00	
	CHECK NO.	85179		500.00
MAXIS BUSINESS DATA INC				
56113 CONTRACT PR	13017512010741		152.50	
	CHECK NO.	85180		152.50
MARTH, JASON				
56299 RIM RETURN	08101229/15326		250.00	
	CHECK NO.	85181		250.00

WARRANT REGISTER

1494

1/18/11

PRYER	INVOICE	CHECK
NO. DESCRIPTION	VENDOR INVOICE	AMOUNT
56200 KLM REFUND	EE101213/19167	250.00
	CHECK NO. 85182	250.00
56205 KLM REFUND	EE101212/18709	500.00
	CHECK NO. 85181	500.00
56214 TOSHIBA-CARR SUPPLY CO	72171463	197.21
	CHECK NO. 85180	197.21
56360 LASER CENTER A/R	2453373	99.98
	CHECK NO. 85185	99.98
56285 KLM REFUND	EE101212/19721	450.00
	CHECK NO. 85186	450.00
56279 CONTE BD/220 S CLAY	18802-1	500.00
	CHECK NO. 85187	500.00
56271 KIMBLE ELECTRONICS	238826	142.50
	CHECK NO. 85188	142.50
56336 AUTOMOTIVE PARTS CO - FMD	50238119/244802	219.71
	CHECK NO. 85189	219.71
56164 NATIONAL ALLIANCE OF	59360	80.00
	CHECK NO. 85190	80.00
56267 HEDCO INC	322359	682.57
	CHECK NO. 85191	682.57
56252 KENNEL/SPRINT	977761515-12/10	2589.46
	CHECK NO. 85192	2589.46
56253 KIDOR GAS	304660100-12/10	89.77
56254 YOUTH CENTER	9007790000-12/10	472.73

WARRANT REGISTER

1494

1/18/11

PAYER	DESCRIPTION	VENDOR INVOICE	INVOICE AMOUNT	CHECK AMOUNT
50237	550 N VINU	1327011500-12/10	571.72	
		CHECK NO. 85193		1134.22
50240	CONT BD/829 S GRANT	19510	150.00	
		CHECK NO. 85194		509.00
50277	ANDERSON BROS CO.	7061163	10393.04	
50278	ROAD BALT	70637738	6430.03	
50279	ROAD BALT			1701.09
50297	SCHOOL	139862	400.00	
		CHECK NO. 85196		400.00
50337	SEMINAR	59423	25.00	
		CHECK NO. 85197		25.00
50286	CATERING	8H101216/19778	112.00	
		CHECK NO. 85198		112.00
50246	SITE MGR/631 S GRANT	19228	3000.00	
		CHECK NO. 85199		3000.00
50151	TAPE	270158	27.00	
		CHECK NO. 85200		27.00
50261	PAY PHONES	242144	153.00	
		CHECK NO. 85201		153.00
50162	VEHICLE ORD	0410002538	35.00	
		CHECK NO. 85202		35.00
50278	CORTRAK/COURTYARD	19213	500.00	
		CHECK NO. 85203		500.00
50230	PROSECUTOR	5023	1048.00	

WARRANT REGISTER

1494

1/18/11

PAYEE	WARRANT REGISTER #	CHECK NO.	INVOICE	CHECK
WARRANT DESCRIPTION	WARRANT INVOICE	AMOUNT	AMOUNT	
BOICZYNSKI, LINDA		85204		1440.00
BOGASMA, PAUL				
10152 KIM REFUND	BN101207/19773		500.00	
	CHECK NO.	85205		500.00
LOGGERS ERECTION, INC				
56181 COLUMBIA	32435633		17.55	
	CHECK NO.	85206		17.55
AND SAFETY				
56269 GLOVES	2/683122		70.35	
	CHECK NO.	85207		70.35
QUARRY MATERIALS, INC.				
56219 COLD MIX	40560		324.38	
56257 COLD MIX	40564		744.80	
	CHECK NO.	85208		1069.18
A O L T				
56254 KIM REFUND	BN101209/19189		250.00	
	CHECK NO.	85209		250.00
PAY OHERSON CO INC				
56272 UNIFORMS	8031716		149.75	
	CHECK NO.	85210		149.75
RECORD INFORMATION				
56206 PUBLIC RECORD SERVICES	28283		575.00	
	CHECK NO.	85211		575.00
REDMOND, DENNIS				
56346 METER VIOLATION	6548		10.00	
	CHECK NO.	85212		10.00
KEY CESAR CORPUS				
56248 CONT BD/319 HAMPTON	19761		500.00	
	CHECK NO.	85213		500.00
JANE CHES				
56227 ASST SUPERVISOR	PH01107164		526.97	
	CHECK NO.	85214		526.97
SCHWARTZ, JAMES				
56122 VEHICLE ORD	44015		15.00	
	CHECK NO.	85215		15.00

WARRANT REGISTER

1494

1/18/11

DATE	DESCRIPTION	WARRANT INVOICE	INVOICE AMOUNT	CHECK AMOUNT
56117	DAYTON			
56118	DAYTON			
56119	DAYTON			
56120	DAYTON			
56121	DAYTON			
56122	DAYTON			
56123	DAYTON			
56124	DAYTON			
56125	DAYTON			
56126	DAYTON			
56127	DAYTON			
56128	DAYTON			
56129	DAYTON			
56130	DAYTON			
56131	DAYTON			
56132	DAYTON			
56133	DAYTON			
56134	DAYTON			
56135	DAYTON			
56136	DAYTON			
56137	DAYTON			
56138	DAYTON			
56139	DAYTON			
56140	DAYTON			
56141	DAYTON			
56142	DAYTON			
56143	DAYTON			
56144	DAYTON			
56145	DAYTON			
56146	DAYTON			
56147	DAYTON			
56148	DAYTON			
56149	DAYTON			
56150	DAYTON			
56151	DAYTON			
56152	DAYTON			
56153	DAYTON			
56154	DAYTON			
56155	DAYTON			
56156	DAYTON			
56157	DAYTON			
56158	DAYTON			
56159	DAYTON			
56160	DAYTON			
56161	DAYTON			
56162	DAYTON			
56163	DAYTON			
56164	DAYTON			
56165	DAYTON			
56166	DAYTON			
56167	DAYTON			
56168	DAYTON			
56169	DAYTON			
56170	DAYTON			
56171	DAYTON			
56172	DAYTON			
56173	DAYTON			
56174	DAYTON			
56175	DAYTON			
56176	DAYTON			
56177	DAYTON			
56178	DAYTON			
56179	DAYTON			
56180	DAYTON			
56181	DAYTON			
56182	DAYTON			
56183	DAYTON			
56184	DAYTON			
56185	DAYTON			
56186	DAYTON			
56187	DAYTON			
56188	DAYTON			
56189	DAYTON			
56190	DAYTON			
56191	DAYTON			
56192	DAYTON			
56193	DAYTON			
56194	DAYTON			
56195	DAYTON			
56196	DAYTON			
56197	DAYTON			
56198	DAYTON			
56199	DAYTON			
56200	DAYTON			
56201	DAYTON			
56202	DAYTON			
56203	DAYTON			
56204	DAYTON			
56205	DAYTON			
56206	DAYTON			
56207	DAYTON			
56208	DAYTON			
56209	DAYTON			
56210	DAYTON			
56211	DAYTON			
56212	DAYTON			
56213	DAYTON			
56214	DAYTON			
56215	DAYTON			
56216	DAYTON			
56217	DAYTON			
56218	DAYTON			
56219	DAYTON			
56220	DAYTON			
56221	DAYTON			
56222	DAYTON			
56223	DAYTON			
56224	DAYTON			
56225	DAYTON			
56226	DAYTON			
56227	DAYTON			
56228	DAYTON			
56229	DAYTON			
56230	DAYTON			
56231	DAYTON			
56232	DAYTON			
56233	DAYTON			
56234	DAYTON			
56235	DAYTON			
56236	DAYTON			
56237	DAYTON			
56238	DAYTON			
56239	DAYTON			
56240	DAYTON			
56241	DAYTON			
56242	DAYTON			
56243	DAYTON			
56244	DAYTON			
56245	DAYTON			
56246	DAYTON			
56247	DAYTON			
56248	DAYTON			
56249	DAYTON			
56250	DAYTON			
56251	DAYTON			
56252	DAYTON			
56253	DAYTON			
56254	DAYTON			
56255	DAYTON			
56256	DAYTON			
56257	DAYTON			
56258	DAYTON			
56259	DAYTON			
56260	DAYTON			
56261	DAYTON			
56262	DAYTON			
56263	DAYTON			
56264	DAYTON			
56265	DAYTON			
56266	DAYTON			
56267	DAYTON			
56268	DAYTON			
56269	DAYTON			
56270	DAYTON			
56271	DAYTON			
56272	DAYTON			
56273	DAYTON			
56274	DAYTON			
56275	DAYTON			
56276	DAYTON			
56277	DAYTON			
56278	DAYTON			
56279	DAYTON			
56280	DAYTON			
56281	DAYTON			
56282	DAYTON			
56283	DAYTON			
56284	DAYTON			
56285	DAYTON			
56286	DAYTON			
56287	DAYTON			
56288	DAYTON			
56289	DAYTON			
56290	DAYTON			
56291	DAYTON			
56292	DAYTON			
56293	DAYTON			
56294	DAYTON			
56295	DAYTON			
56296	DAYTON			
56297	DAYTON			
56298	DAYTON			
56299	DAYTON			
56300	DAYTON			

WARRANT REGISTER

1494

1/16/11

NO	PAYER DESCRIPTION	VENDOR INVOICE	INVOICE NUMBER	CHECK AMOUNT
56150	TRASH DOOR CHECK	CHEK 152	85227	27.95
56151	TECH SYSTEMS INC	FC01994	15419.56	
56152	ANNUAL RENEWAL	CHECK NO.	85228	12115.89
56153	ST-SEA FIND	54614	172.00	
56154	PERMITS PERMIT	CHECK NO.	85229	172.00
56155	WAP LIGHTING INC	1220	151.60	
56156	EXIT LIGHTS	1219	71.76	
56157	BULBS	1221	149.70	
56158	LIGHTS	CHECK NO.	85230	373.06
56159	TERS PLUS	342177	675.66	
56160	DARE T SHIRTS	CHECK NO.	85231	675.66
56161	TRE CARE OF TREES	904224637	9870.00	
56162	TREE PRUNING	CHECK NO.	85232	9870.00
56163	THE HINSDALEAN	9368/9/9415/4/95	1960.00	
56164	DT SHOPPING	CHECK NO.	85233	1960.00
56165	THE VILLAGE CELLAR	19747	500.00	
56166	CORT BD/24 N CHICAGO	CHECK NO.	85234	500.00
56167	THIRD MILLENIUM	13215	1098.48	
56168	UTILITY BILLING	CHECK NO.	85235	1098.48
56169	THOMPSON PUBLISHING GRP	5649198-1/11	438.50	
56170	RENEWAL	CHECK NO.	85236	438.50
56171	Y PEDI CON CONSULTANT	4768	1770.00	
56172	SEWER PLAN REVIEW	CHECK NO.	85237	1770.00
56173	TRAFFIC CONTROL & PROTECT	58376	163.21	
56174	14-12 SIGNS			

WARRANT REGISTER

1494

1/18/11

PAYEE	WARRANT REGISTER #	1494	1/18/11	INVOICE	CHECK
VOU: DESCRIPTION	VERNON INVOICE			AMOUNT	AMOUNT
56010 CONTROL & PROTECT	CHECK NO. 85238				353.21
56030 INSURANCE	165089			455.00	
56030 INSURANCE	CHECK NO. 85239				310.00
56030 RADIO COMMUNICATIONS	20474901			144.00	
56030 RADIO COMMUNICATIONS	20474902			576.00	
	CHECK NO. 85240				720.00
56034 STRIP CHART ROLLS	299827			249.40	
	CHECK NO. 85241				249.40
56294 KIM REPUNE	FN101210/19425			375.00	
	CHECK NO. 85242				375.00
56309 VERIZON WIRELESS	2509425123			645.15	
	CHECK NO. 85243				645.15
56121 VILLAGE OF OAK BROOK	4397			681.16	
	CHECK NO. 85244				681.16
56131 VILLAGE TAXI SERVICE, INC	312479			19.50	
	CHECK NO. 85245				19.50
56163 VOSS, WILLIAM	8213046140			5.00	
	CHECK NO. 85246				5.00
56198 WAREHOUSE DIRECT INC	9788030			139.45	
56198 OFFICE SUPPLIES	9431750			617.50	
56211 ADT BOOK	8788470			25.55	
56211 TOILET	90677910			248.57	
	CHECK NO. 85247				1271.56
56215 PESCOB UNDERSHOED	3207			1500.00	
	CHECK NO. 85248				1500.00

WARRANT REGISTER

1494

1/18/11

PAYEE	WARRANT REGISTER #	INVOICE	CHECK
NO. DESCRIPTION	NUMBER INVOICE	NUMBER	AMOUNT
RETAILSALE DIRECT, INC			
56144 BRAD LICENSE	182761	39.38	
	CHECK NO. 85249		35.75
P. BUCKENBROOK, TONY INC			
56150 CRUSERS	5354651	70.74	
	CHECK NO. 85250		70.73
TOPICAL MARK			
56157 REIMBURSEMENT	59429	75.20	
56161 REIMBURSEMENT	19421	54.70	
	CHECK NO. 85251		129.91
WORK N GEAR			
56162 SAFETY BOOTS	142592	100.00	
	CHECK NO. 85252		100.00
ZEN MEDICAL			
56203 MEDICAL SUPPLIES	0100265090	18.32	
	CHECK NO. 85253		18.32
ZIBBELL WATER SERVICE			
56180 WATER MAIN	211049	668.98	
56204 WATER MAIN SUPPLIES	210999	2461.14	
	CHECK NO. 85254		3130.12
ZIMMERMAN, THOMAS			
56367 TICKET REFUND	2813	20.00	
	CHECK NO. 85255		20.00
GAUR, SAMEER			
56268 TRK REIMBURSEMENT	3746-1	780.00	
	CHECK NO. 85256		780.00
	GRAND TOTAL		\$613,903.07

Village of Hinsdale
Schedule of Bank Wire Transfers and ACH Payments
Warrant Register # 1494

Payee/ Date	Description	Vendor/Invoice	Invoice Amount
Intergovernmental Personnel Benefit Cooperative 1/3/2011	January 2011 Contribution	Employee Health Insurance	145,010.05
Electronic Federal Tax Payment Systems 1/7/2011	Village Payroll # 1-Calendar 2011	FW11	46,009.53
Electronic Federal Tax Payment Systems 1/7/2011	Village Payroll # 1-Calendar 2011	FICA/MCARE	30,190.15
Illinois Department of Revenue 1/7/2011	Village Payroll # 1-Calendar 2011	State Tax Withholding	9,921.91
DuPage Credit Union 1/7/2011	Village Payroll # 1-Calendar 2011	Employee Withholding	5,510.19
ICMA - 457 Plans 1/7/2011	Village Payroll # 1-Calendar 2011	Employee Withholding	12,643.28
HSA Plan Contribution 1/7/2011	Village Payroll # 1-Calendar 2011	Employee Withholding	1,663.74
HSA Plan Contribution 1/7/2011	Village Payroll # 1-Calendar 2011	Employer Contributions	4,125.00
Illinois Municipal Retirement Fund 1/10/2011	Employee/Employer Contributions	December 2010 Wages	83,310.82
Electronic Federal Tax Payment Systems 1/14/2011	Pension Payroll #11- Calendar Year 2011	1/11 Final FW11	<u>18,210.63</u>

Total Bank Wire Transfers and ACH Payments 356,595.30

Total Regular Checks, Pension Checks and Wire Transfers/ACH Payments 824,243.99