



Village of Hinsdale
19 E. Chicago Avenue
Hinsdale, IL 60521-3489
(630)789-7000

Village Website: www.villageofhinsdale.org

PUBLIC SERVICES UTILITY PERMIT APPLICATION - Permit Fee of \$100.00-

Date of Application: 3/2/22 Permit No: ATT - 0042 Permit Expiration Date: 06/30/22

Utility Company Information:

Company Name: AT&T
Address: 1000 Commerce Dr
City, State, Zip: Oak Brook IL 60523
Contact Person: Brian Tazelaar
Phone Number: 630-418-9001
Email Address: bt1812@att.com
Cell Number: 630-418-9001
Project/Work Order Number: AT&T Job#: A029W4N

Contractor Information:

Company Name: JOSCO
Address: 2551 Division St, unit 102
City, State, Zip: Joliet IL 60435
Contact Person: Chris Nurczyk - Project Manager
Phone Number: 815-725-1975
Email Address: info@josco.com
Cell Number: 815-725-1975

PROJECT LOCATION: 120 S LINCOLN ST

Description of work covered under this permit: Bore and place approximately 1260' OF 1-3" FLEX-PIPE
Bore and place approximately 203' OF 1-4" FLEX-PIPE. DIG 4'X4' PIT FOR CORE BORE OF MH 11.
DIG 2'X2' PIT FOR CORE BORE OF MH 11
PLACE 52"X50"X4" PRECAST PAD FOR 864 PFP CABINET

Start Date: 3/2/22 Completion Date: 6/2/22

Site Plan/Details/Specifications (3 sets) included with application? YES NO
Currently registered as a Utility Contractor with the Village of Hinsdale? YES NO
Engineer Estimate of Cost included with application? YES NO

Type of Utility: ComEd, Nicor, Comcast, Water, Sewer, Communications, Fiber Optic, Wireless, Other

Applicant Information:

Print Name: Brian Tazelaar Phone Number: 630-418-9001
Company: AT&T Email Address: bt1812@att.com
Signature: Brian Tazelaar Date: 3/2/22

ALL CONSTRUCTION SHALL BE DONE IN ACCORDANCE WITH THE LATEST EDITION IN EFFECT ON THE DATE OF PERMIT APPLICATION OF THE FOLLOWING: STANDARD SPECIFICATIONS FOR ROAD AND BRIDGE CONSTRUCTION & SUPPLEMENTAL SPECIFICATIONS AND RECURRING SPECIAL PROVISIONS BY THE ILLINOIS DEPARTMENT OF TRANSPORTATION, ILLINOIS MANUAL ON UNIFORM TRAFFIC CONTROL DEVICES FOR STREETS AND HIGHWAYS, STANDARD SPECIFICATIONS FOR WATER AND SEWER MAIN CONSTRUCTION IN ILLINOIS, AND THE VILLAGE OF HINSDALE SUBDIVISION ORDINANCES (Ord. 02007-73, 11-6-2007) AND ENGINEERING STANDARDS.

Village Use Only

Permit Approved: YES NO

Conditions for Approval/Reasons for Denial: RESTORE ALL DISTURBED AREAS WITHIN 14 DAYS OF COMPLETION. NOTIFY LOCAL BUSINESSES 48 HOURS PRIOR TO START.

Approved By: [Signature] Date: 3/11/22



ISSUE	1
DATE	3/1/22

A029W4N PROPOSED DETAILS	
DESCRIPTION	QUANTITY
MANHOLE	-
PEP	1
FLOWER POT	-
HANDHOLE	1
DIG PIT	2



SCALE-N.T.S

AT&T PROJECT: A029W4N
 ENGINEER: BRIAN TAZELAAR
 TEL # 630-418-9001
 QUARTER SECTION: NW-12
 MUNICIPALITY: HINSDALE
 TOWNSHIP: DOWNERS GROVE
 WIRE CENTER: HINSDALE
 COUNTY OF: DUPAGE

DWG 1 OF 3 REV. NO.

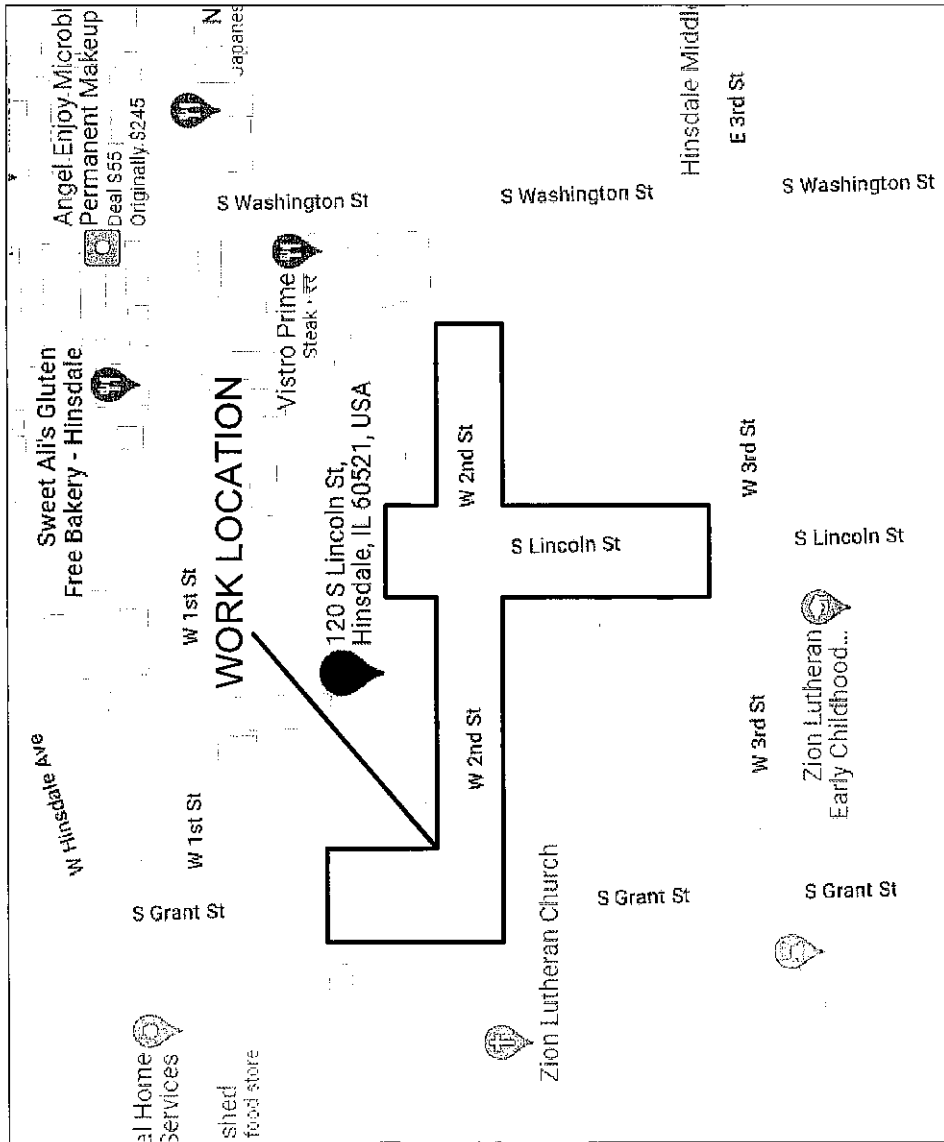

PREPARED BY: MAULIK GUPTA
 CHC CONSULTING
 1845 W. Orangewood Ave., Suite 300
 Orange, CA 92668
 (949) 250-0009 / FAX (949) 250-0008

PHYSICAL ADDRESS:-
 120 S LINCOLN ST, HINSDALE, IL 60521, USA

CONTRACTOR PRINT

GENERAL CONSTRUCTION NOTES:

1. LOCATE ALL UNDERGROUND OBSTRUCTIONS PRIOR TO DIGGING CONTACT J.U.L.I.E. AT 8-1-1 TWO BUSINESS DAYS IN ADVANCE TO DIGGING
2. RESTORE ALL DISTURBED GROUNDS TO ORIGINAL OR BETTER CONDITION AS SOON AS POSSIBLE OR WITHIN TWO (2) WEEKS AFTER CONSTRUCTION IS COMPLETE.
3. AT&T CONTRACTOR TO PLACE CONDUIT NO LESS THAN 24" DEEP.
4. AT&T CONTRACTOR TO PROVIDE ALL BARRICADES AND WORK AREA PROTECTION.
5. AT&T CONTRACTOR IS REQUIRED TO KEEP ALL ROADWAY PAVEMENT, CURBS, GUTTERS AND STORM WATER COLLECTORS FREE OF MUD AND OTHER DEBRIS AT ALL TIMES DURING CONSTRUCTION.
6. ALL PROPOSED WORK IS IN EXISTING PUBLIC RIGHT OF WAY AND/OR UTILITY EASEMENT.
7. TUNNEL ALL TREES PER BUREAU OF FORESTRY GUIDELINES.

CAUTION: VOLTAGE RANGES FROM 301V TO 15KV
 THIS PROJECT REQUIRES COORDINATION WITH UT: _____ NA _____

- Ⓜ21 DIG 4' X 4' PIT FOR CORE BORE MH #11
- Ⓜ22 BORE AND PLACE 1-3" FLEX-PIPE - 260'
- Ⓜ23 BORE AND PLACE 1-3" FLEX-PIPE - 505'
- Ⓜ26 DIG 2' X 2' PIT FOR CORE BORE MH #11
- Ⓜ27 BORE AND PLACE 1-4" FLEX-PIPE - 203' MH #11 TO NEW PFP-864
- Ⓜ28 PL. PFP 52"X50"X4" PRECAST PAD FOR 864 PFP CABINET

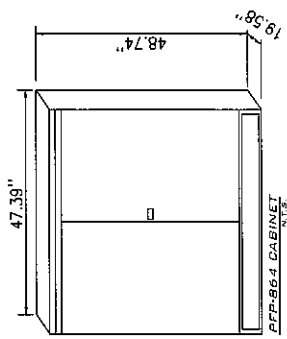

EXCAVATION DATA	
DIRT	BORE LENGTH
4'X4'=16 SQ FT	946 FT.
DIRT PIT	
2'X2'=4 SQ FT	

ISSUE 1
 DATE 3/1/22

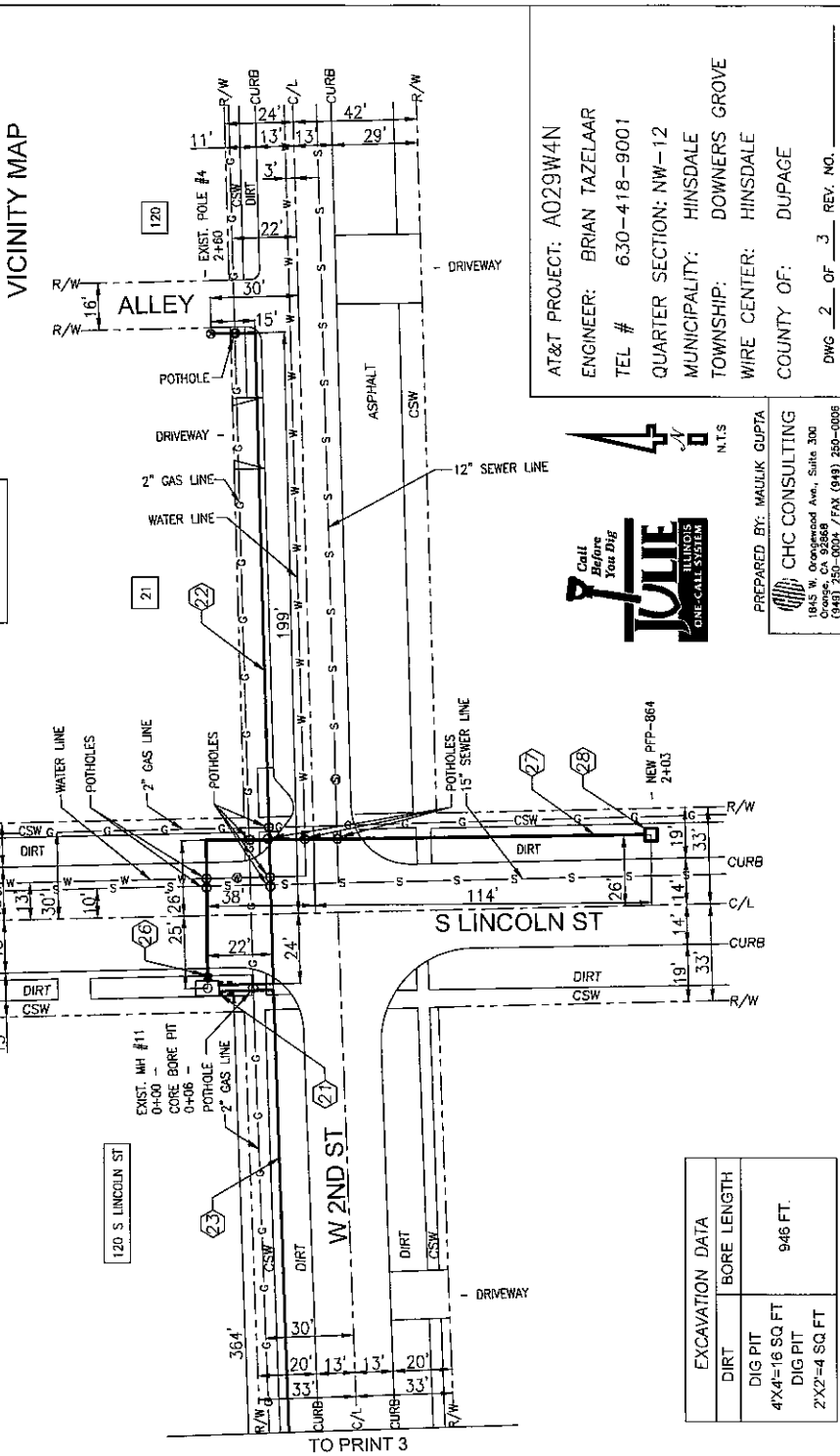
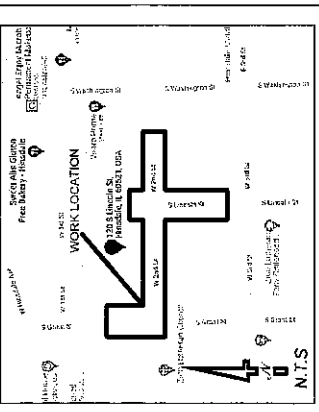

AT&T PROJECT: A029W4N
 ENGINEER: BRIAN TAZELAAR
 TEL # 630-418-9001
 QUARTER SECTION: NW-12
 MUNICIPALITY: HINSDALE
 TOWNSHIP: DOWNERS GROVE
 WIRE CENTER: HINSDALE
 COUNTY OF: DUPAGE
 DWG 2 OF 3 REV. NO. _____

PREPARED BY: MAULIK GUPTA
 CHC CONSULTING
 1845 W. Orangehood Ave., Suite 300
 Orange, CA 92669
 (949) 258-0004 / FAX (949) 258-0005



ISSUE	DATE
1	3/1/22

CONTRACTOR PRINT

- (23) BORE AND PLACE 1-3" FLEX-PIPE - 505'
- (24) PL. NEW (30"X48"X36") HH #111
- (25) PL. NEW GROUND BED

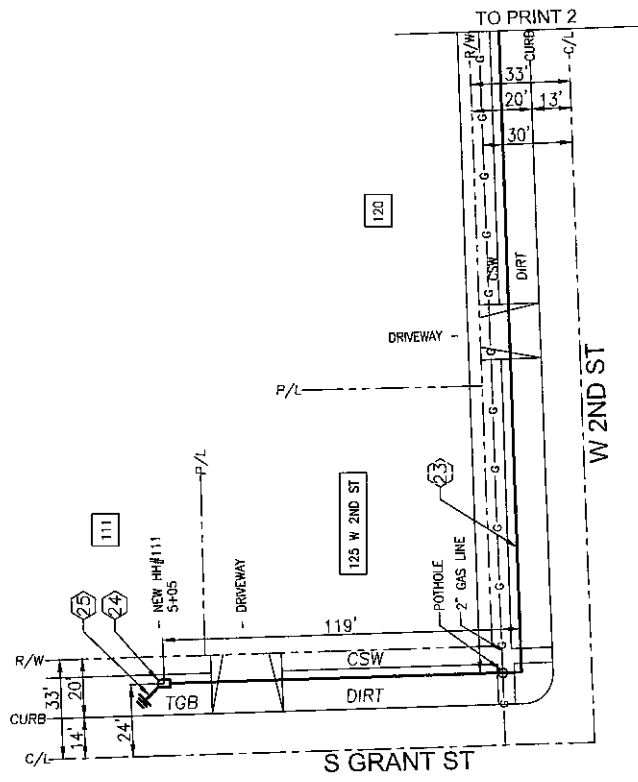

LEGEND

	- TGB
	- HH



AT&T PROJECT: A029W4N
 ENGINEER: BRIAN TAZELAAR
 TEL # 630-418-9001
 QUARTER SECTION: NW-12
 MUNICIPALITY: HINSDALE
 TOWNSHIP: DOWNERS GROVE
 WIRE CENTER: HINSDALE
 COUNTY OF: DUPAGE

DWG 3 OF 3 REV. NO.

GENERAL CONSTRUCTION NOTES:
 SEE DWG 2

PREPARED BY: MALIK GUPTA
 CHC CONSULTING
 1845 W. Orangewood Ave., Suite 300
 Orange, CA 92668
 (949) 250-0007 / FAX (949) 250-0006

EXCAVATION DATA	
DIRT	BORE LENGTH
NEW HH (30"X48"X36")	