



Prepared in cooperation by the Dodge County Historical Society, Dodge County Environmental Services and the Goodhue County GIS Office

Concord (Ghost Town)

LOCATION: CR 24 and 201st Ave, West Concord, MN 55985

STATUS: Private

TYPE: Historic, District

HISTORY: A post office was established in 1856 and discontinued service in August of 1906. This village was in the vicinity of the first homes of the early settlers and grew to almost 200 inhabitants. This village was once called Sumner's Grove until official surveying in 1856 named it "Concord." When the railroad by-passed Concord, another village grew and became West Concord. Today, the village still stands and the old school acts as town hall. The Christian Church remains in Concord today, but the Baptist Church moved to West Concord. The cemetery is still being used today.

Photograph and information courtesy of *History of Concord* by Neil Wheeler

OTHER RESOURCES:

<https://www.dodgecountyhistorical.org/>

PROPERTY PICTURES:



This picture was taken approximately 1930 of the North Middle Branch of the Zumbro River that runs through Concord. This bridge was washed out by a flood in 1946 or 1947 and replaced with a temporary bridge. The current bridge was built in 1951.

The original photograph is owned by Neil Wheeler.

1883 Plat Map of

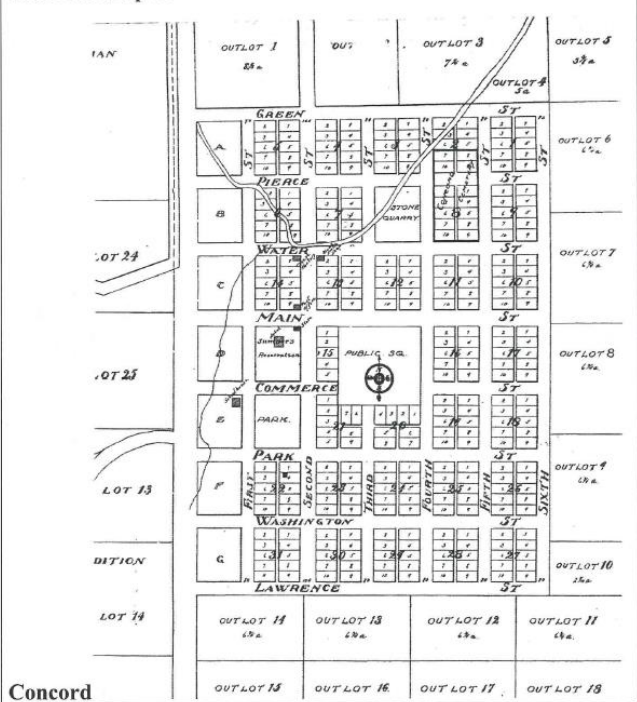

Concord

Concord Residents

Code	1883	2004
NW Out lot 1	George Wheeler	Paul/Jessie Stanton
SW Out lot 1	Concord Church of Christ	Same
SW Out lot 1	Church Parsonage	Same
SE Out lot 1	Zeno Gibbs	Arvin/Patty Schmidt
Block 5; Lot 1	D. D. Gardner	Empty Lot
Block 4; Lot 2	L. J. White	Empty Lot
Block 4; Lot 10	H. Barnes	Empty Lot
Block 6; Lot 4	Ira Miller	William/Jodie Sexton
Block 7; Lot 3	E. P. Wright	Glen/Mary Lou Hanson
Block 7; Lot 10	Grist Mill	Empty Lot
Block 4; Lot 1	Concord Dairy Association	Harold/Evelyn Moreland
Block 13; Lot 2	Schliel Harness Shoe Store	Empty Lot
Block 14; Lot 4	Videtta Avery	Neil/Sharril Wheeler
Block 14; Lot 5	J. M. Avery	Empty Lot
Block 13; Lot 7	T. M. Burdette Nolions & Singing Lessons	Empty Lot
Block 14; Lot 10	Harvey Berry	Richard Franzen
Block 14; Lot 16	Emma Carr, Postmaster	Dernik Ellingson
Block 13; Lot 10	Hotel	Doug/Vickie Rhodes
Block 13; Lot 9	General Store	Doug/Vickie Rhodes
Block 12; Lot 10	G. L. Hunt, Justice of the Peace	Aaron Ludlow
Block 12; Lot 9	Baptist Church	Mike / Heidi Jo Jager
NE Sumner's Reservation	General Store	Concord Store and Looker
N Central Sumner's Reservation	Masonic Hall	Empty Lot
N Central Sumner's Reservation	Blacksmith Shop	Jerome/Beth Ryan
Central Sumner's Reservation	Sumner's Hotel	Jerome/Beth Ryan
Block 22; Lot 10	C. Jacks	Ed/Clara Hanson
Block 15; Lot 1	Beaulier M.D.	Kevin Kyle/Amanda Buelner
Block 15; Lot 4	S. Gibbs	Doug/Mary Espenson
Block 22; Lot 5	H. W. Severns	Empty Lot
Block 29; Lot 1	Red Lions Billiard & Saloon	John/Velva Kath
Block 21; Lot 2	Rions House & Stagecoach Stop	John/Velva Kath
Block 21; Lot 3	G. W. Benjamin	David King
Block 21; Lot 5	Frank Benjamin	Rolland/Adeline Schletty
Block 23; Lot 2	Alanson Wheeler	Empty Lot
Block 23; Lot 1		Rod/Renee Streich
Block 23; Lot 10		Empty Lot
Block 30; Lot 3	W. Welch	Charlie Giesler
Block 20; Lot 8	J. Babcock	Raymond Courson
Block 24; Lot 10	Horace Caloun	Empty Lot
Block 24; Lot 9	Jason Wheeler	Empty Lot
Block 20; Lot 7	Perry Nelson	Empty Lot
Block 26; Lot 4	Sanderson	Empty Lot
Block 27; Lot 6	J. P. Rions	Dennis/Barbara Jacobs
Block 18; Lot 9	B. S. Schneck	Joe DeFieger
Block 19; Lot 3	J. Avery	John Fitzgerald
Block 16; Lot 3	W. G. Avery	Gary Knudsen
Block 9; Lot 9	Oliver Strook	Empty Lot
	H. Berry	

Concord Plat Map, 1883