

# THE KNOT

## BIMINI BASIN'S ENTERTAINMENT DISTRICT



### 1 COMMUNITY CENTER AND DOG PARK

Whether it be Karate class on Saturday or your wedding day, the Community Center has the venue for you. Don't worry there is even a spot for your dog to have a little fun.

### 2 MULTI-FAMILY HOUSING

For those of you wanting to be in the middle of the action, having great views of both The Hook Park and Bimini Basin, this is the place for you.

### 3 BOARDWALK

Grab a beer and a new pair of swim trunks all while taking a nice stroll by the water. Don't forget to dance the night away with The Bimini Basin as your backdrop.

### 4 THE KNOT'S PARK

Come to Band's on the Basin and catch your favorite band's in the Knot's backyard. Be apart of Cape Coral's biggest block party while getting a taste of local food, brew, and tunes.

**S**  
**T**  
**A**  
**T**  
**S**

PARKING - minimum of 1020 spaces  
RESIDENTIAL - 148,596 sq ft, approximately 112 units  
COMMERCIAL - 205,939 sq ft  
COMMUNITY CENTER - 86,751 sq ft



SCALE 1" = 100' 

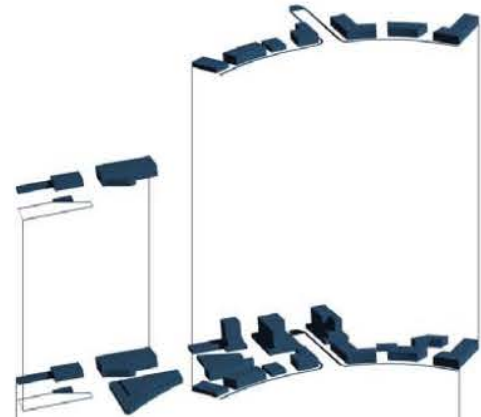

Terry and George Ronan just spent their 65th wedding anniversary in their beloved town of Cape Coral. George took Terry to dinner at her favorite restaurant in The Knot, Cape Corals entertainment district. After a lovely dinner at her favorite restaurant, The Palm Leaf, Terry took her out on a romantic boat ride down Bimini Basin and out into The Gulf. When they returned they watched the city lights as they took a stroll together down The Boardwalk.





THE RUBICON CANAL IS THE SUBJECT OF MUCH DEBATE. AS VIEWED ABOVE, WITH THE PROPER PLANNING THE RUBICON CAN BECOME AN ACTIVE ROUTE OF TRANSPORTATION THAT BRINGS PEOPLE TO THE HEART OF DOWNTOWN CAPE CORAL. OPENING UP THE RUBICON WOULD ALLOW PEOPLE WITH BOATS, KAYAKS, CANOES, PADDLE BOARDS, AND JET SKIS TO HAVE DIRECT WATER ACCESS TO DOWNTOWN AND THE GULF, AS WELL AS MANY OTHER CONNECTED CANALS. OPENING UP THE RUBICON WOULD ALSO ALLOW FOR THE BOARDWALK ALONG BIMINI BASIN TO EXTEND FURTHER DOWN THE CANAL, LEADING TO A PROSPEROUS PUBLIC WATERFRONT. DRAWBRIDGES COULD BE IMPLEMENTED TO ALLOW FOR TALL BOATING TRAFFIC TO PASS THROUGH. THIS INFRASTRUCTURE OF DRAWBRIDGES ARE SMALLER IN SCALE AND WOULD LESSEN THE IMPACT ON DOWNTOWN PEDESTRIAN MOVEMENT AND BUSINESS. OPENING UP THE RUBICON WOULD HELP TO REVITALIZE THIS AREA AND BRING WATER INTO CAPE CORAL'S ACTIVE PUBLIC REALM.

STEPS MUST BE TAKEN IN ORDER TO CREATE THIS KIND OF VISION. AS THE FINAL PHASE OUTLINED, THE RUBICON CANAL WILL ACT AS THE FINAL FACTOR IN TRANSFORMING CAPE CORAL'S DOWNTOWN. BY CHANGING THE BLOCK ALIGNMENT AND LEAVING THE AREA NEEDED FOR THE BRIDGES AND CANALS OPEN, THIS SPACE COULD ACT AS A PUBLIC GREEN PARK UNTIL CAPE CORAL IS READY FOR THIS ENDEAVOR.