

THE OFFICIAL RECORD OF THIS SHEET IS THE ELECTRONIC FILE DIGITALLY SIGNED AND SEALED UNDER RULE 61G15-23.004, F.A.C.

Plotted By: Reiber, Logan Sheet: Set: Lake Kennedy Racquet Center Layout: C-4 AERIAL SITE PLAN May 13, 2021 01:43:05pm K:\SAB_URO\048420013.1 - Lake Kennedy Park CAD Plan Sheets\C-4 AERIAL SITE PLAN.dwg
This document, together with the concepts and designs presented herein, is intended only for the specific purpose and client for which it was prepared. Reuse of and improper reliance on this document without written authorization and adaptation by Kimley-Horn and Associates, Inc. shall be without liability to Kimley-Horn and Associates, Inc.



Kimley»Horn

© 2021 KIMLEY-HORN AND ASSOCIATES, INC.
1777 MAIN STREET, SUITE 200, SARASOTA, FL 34236
PHONE: 941-379-7600
WWW.KIMLEY-HORN.COM CA 0000696

SWEETSPARKMAN ARCHITECTURE & INTERIORS

CIVIL ENGINEER & LANDSCAPE ARCHITECT
Kimley Horn and Associates, Inc.
1777 Main Street, Suite 200
Sarasota, FL 34236
TEL (941) 379-7600

ARCHITECT
Sweet Sparkman Architects
2168 Main Street
Sarasota, FL 34237
TEL (941) 852-0034

MECHANICAL, ELECTRICAL, PLUMBING ENGINEER
TLC Engineering
13099 S. Cleveland Avenue, Suite 500
Fort Myers, FL 33907
TEL (239) 275-4240

SURVEYOR
E.F. Gaines Surveying Services, Inc.
5235 Ramsey Way, Suite 10
Fort Myers, FL 33907
TEL (239) 2418-0128

LICENSED PROFESSIONAL

DEAN L. PAQUET, P.E.
FLORIDA LICENSE NUMBER 59916

DATE

5/13/21

LAKE KENNEDY RACQUET CENTER

400 SANTA BARBARA BLVD,
CAPE CORAL, FL 33991



100% CONSTRUCTION PLANS
NOT FOR CONSTRUCTION

REVISIONS:

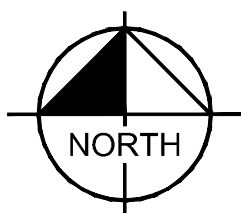

GRAPHIC SCALE IN FEET
0 50 100 200

SCALE:	AS SHOWN
DESIGNED BY:	KHA
DRAWN BY:	KHA
CHECKED BY:	TTS
PROJECT NUMBER:	048420013.1
DATE:	12/03/2020

AERIAL SITE PLAN

SHEET NUMBER

C-4

CALL 2 WORKING DAYS
BEFORE YOU DIG

IT'S THE LAW!
DIAL 811



SUNSHINE STATE ONE CALL OF FLORIDA, INC.

Plotted By: Reiber, Logan Sheet: Set: Lake Kennedy Racquet Center Layout: C-7 SITE PLAN May 13, 2021 01:44:18pm K:\SAB-URG\048420013.1 - Lake Kennedy Park CAD Plan\Sheets\C-7 SITE PLAN.dwg
This document, together with the concepts and designs presented herein, is intended only for the specific purpose and client for which it was prepared. Reuse of and improper reliance on this document without written authorization and adaptation by Kimley-Horn and Associates, Inc. shall be without liability to Kimley-Horn and Associates, Inc.

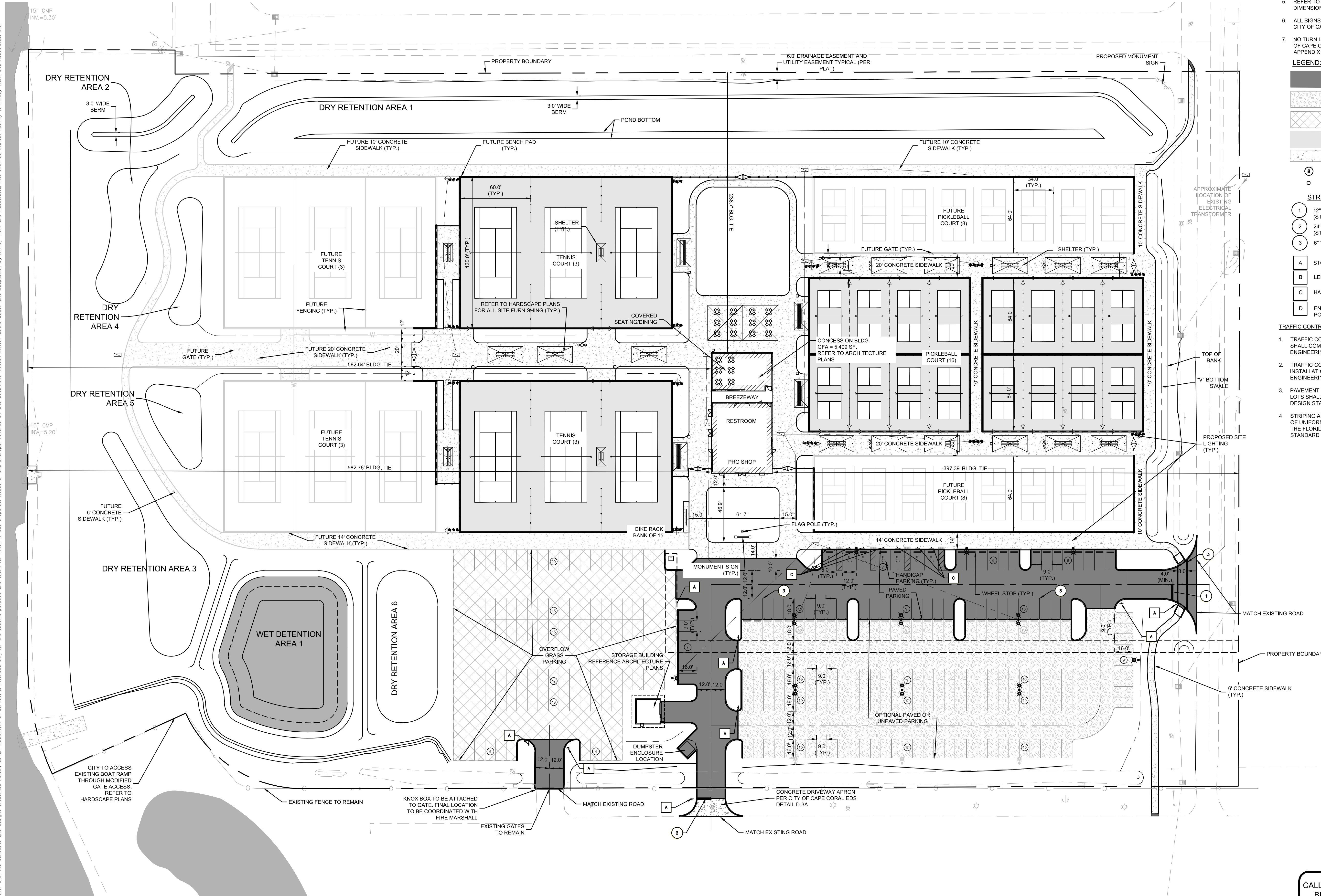

PEAK-HOUR TRIP ESTIMATION		
RATE (PEAK-HOUR TRIPS / COURT)	COURTS	TOTAL PEAK-HOUR TRIPS
4.21	44	185.24

1. TRIP RATE BASED ON ITE TRAFFIC MANUAL, 10TH EDITION RATE FOR TENNIS COURTS.

NOTES:

- ALL DIMENSIONS ARE TO FACE OF CURB OR FACE OF BUILDING UNLESS SHOWN OTHERWISE.
- REFER TO LANDSCAPE PLAN FOR LANDSCAPE DESIGN.
- REFER TO HARDSCAPE PLANS FOR ALL FENCING, GATES SHADE STRUCTURES, AND COURT SPECIFICATIONS.
- CONTRACTOR TO INSTALL TRUNCATED DOMES AT EACH SIDE STREET CROSSWALK WHERE SIDEWALK MEETS DRIVE/ALLEY.
- REFER TO ARCHITECTURAL PLAN FOR BUILDING DIMENSIONS.
- ALL SIGNS TO BE PERMITTED SEPARATELY THROUGH THE CITY OF CAPE CORAL.
- NO TURN LANE WARRANTS ARE MET ACCORDING TO CITY OF CAPE CORAL ENGINEERING AND DESIGN STANDARD APPENDIX 1.

LEGEND:

- STANDARD ASPHALT PAVEMENT (E-7, CAPE CORAL EDS)
- OPTIONAL PAVED OR UNPAVED PARKING
- OVERFLOW GRASS PARKING
- COURT SURFACE
- CONCRETE SURFACE

- PARKING COUNT BOLLARD

STRIPING AND SIGNAGE LEGEND

- 12" WIDE SOLID WHITE LINE (STANDARD CROSSWALK)
- 24" WIDE SOLID WHITE LINE (STOP LINE)
- 6" WIDE SOLID WHITE LINE

- A STOP SIGN
- B LEFT TURN ONLY SIGN (R3-5L)
- C HANDICAP PARKING SIGN
- D END OF ROAD MARKER SIGNS/ POSTS (OM4-1)

TRAFFIC CONTROL SIGNAGE & PAVEMENT MARKING NOTES

- TRAFFIC CONTROL SIGNAGE AND PAVEMENT MARKINGS SHALL COMPLY WITH THE CITY OF CAPE CORAL ENGINEERING DESIGN STANDARDS
- TRAFFIC CONTROL SIGN SPECIFICATIONS AND INSTALLATION SHALL BE PER CITY OF CAPE CORAL ENGINEERING DESIGN STANDARD DETAILS J-1 & J-2.
- PAVEMENT MARKINGS AND STRIPING WITHIN PARKING LOTS SHALL BE PER CITY OF CAPE CORAL ENGINEERING DESIGN STANDARD DETAILS E-4 & E-5.
- STRIPING AND SIGNAGE SHALL COMPLY WITH THE MANUAL OF UNIFORM TRAFFIC CONTROL DEVICES (MUTCD) AND THE FLORIDA DEPARTMENT OF TRANSPORTATION (FDOT) STANDARD PLANS.

Kimley»Horn

© 2021 KIMLEY-HORN AND ASSOCIATES, INC.
1777 MAIN STREET, SUITE 200, SARASOTA, FL 34236
PHONE: 941-379-7600
WWW.KIMLEY-HORN.COM CA 00000696

SWEETSPARKMAN
ARCHITECTURE & INTERIORS

CIVIL ENGINEER & LANDSCAPE ARCHITECT

Kimley Horn and Associates, Inc.
1777 Main Street, Suite 200
Sarasota, FL 34236
TEL: (941) 379-7600

ARCHITECT

Sweet Sparkman Architects
2168 Main Street
Sarasota, FL 34237
TEL: (941) 652-0084

MECHANICAL, ELECTRICAL, PLUMBING ENGINEER

TLC Engineering
13099 S. Cleveland Avenue, Suite 500
Fort Myers, FL 33907
TEL: (239) 275-4240

SURVEYOR

E.F. Gaines Surveying Services, Inc.
5235 Ramsey Way, Suite 10
Fort Myers, FL 33907
TEL: (239) 2418-0128

LICENSED PROFESSIONAL

DEAN L. PAQUET, P.E.
FLORIDA LICENSE NUMBER 59916

DATE

5/13/21

LAKE KENNEDY
RACQUET CENTER

400 SANTA BARBARA BLVD,
CAPE CORAL, FL 33991



100% CONSTRUCTION PLANS
NOT FOR CONSTRUCTION

REVISIONS:

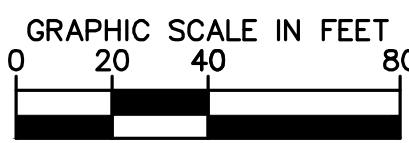
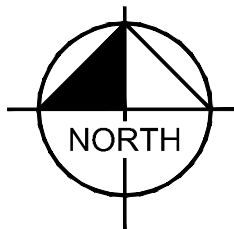

SCALE: AS SHOWN
DESIGNED BY: KHA
DRAWN BY: KHA
CHECKED BY: TTS
PROJECT NUMBER: 048420013.1
DATE: 12/03/2020

SITE PLAN

SHEET NUMBER

C-7

CALL 2 WORKING DAYS
BEFORE YOU DIG

IT'S THE LAW!
DIAL 811



SUNSHINE STATE ONE CALL OF FLORIDA, INC.