

# Cape Coral

---

## Median Landscape Templates



06.17.19 / C10212

Table 212.11.3 Minimum Tree Spacing

Design Speed (mph)	Minimum Tree Spacing (Center-to-Center of Trunk) (feet)	
	4" < Tree Diameter ≤ 11"	11" < Tree Diameter ≤ 18"
25-30	25	90
35	30	105
40	35	120
45	40	135
50	50	150
55	55	165
60	60	180

Notes:

- (1) Size and spacing are based on the following conditions:
- (a) A single line of trees in the median parallel to but not necessarily collinear with the centerline.

(b) A straight approaching mainline and intersection angle between 60° and 120°.

(c) Space trees with 4" < Dia. ≤ 11" intermixed with trees with 11" < Dia. ≤ 18" based on trees with 11" < Dia. ≤ 18".
- (2) Detail tree size, spacing, and location in the plans for any other conditions.

Applies to within limits of the clear sight triangles.  
Refer to the City of Cape Coral Engineering Design Standards (Latest Edition)  
Sheet No. G-22 Site Triangles for Unobstructed View at Intersections and Driveways.

INTERSECTION SIGHT DISTANCE

SPEED LIMIT (MPH)	DISTANCE FROM EDGE OF MEDIAN LIMITED TO GROUND COVER (FT)	INTERSECTION SIGHT DISTANCE TRIANGLE DIMENSIONS	TREE SPACING AND CALIPER	CLEAR SIGHT WINDOW
30	50	TABLE 16-2 FLORIDA GREEN BOOK	FDOT DESIGN MANUAL	EDS DETAIL G-12 (FDOT DESIGN MANUAL)
35	50	FIGURE 3-12 FLORIDA GREEN BOOK	FDOT DESIGN MANUAL	EDS DETAIL G-12 (FDOT DESIGN MANUAL)
40	50	FIGURE 3-12 FLORIDA GREEN BOOK	FDOT DESIGN MANUAL	EDS DETAIL G-12 (FDOT DESIGN MANUAL)
45	FDOT DESIGN MANUAL	FIGURE 3-12 FLORIDA GREEN BOOK	FDOT DESIGN MANUAL	EDS DETAIL G-12 (FDOT DESIGN MANUAL)
45+	FDOT DESIGN MANUAL	FDOT DESIGN MANUAL	FDOT DESIGN MANUAL	EDS DETAIL G-12 (FDOT DESIGN MANUAL)

CORNER SIGHT DISTANCE

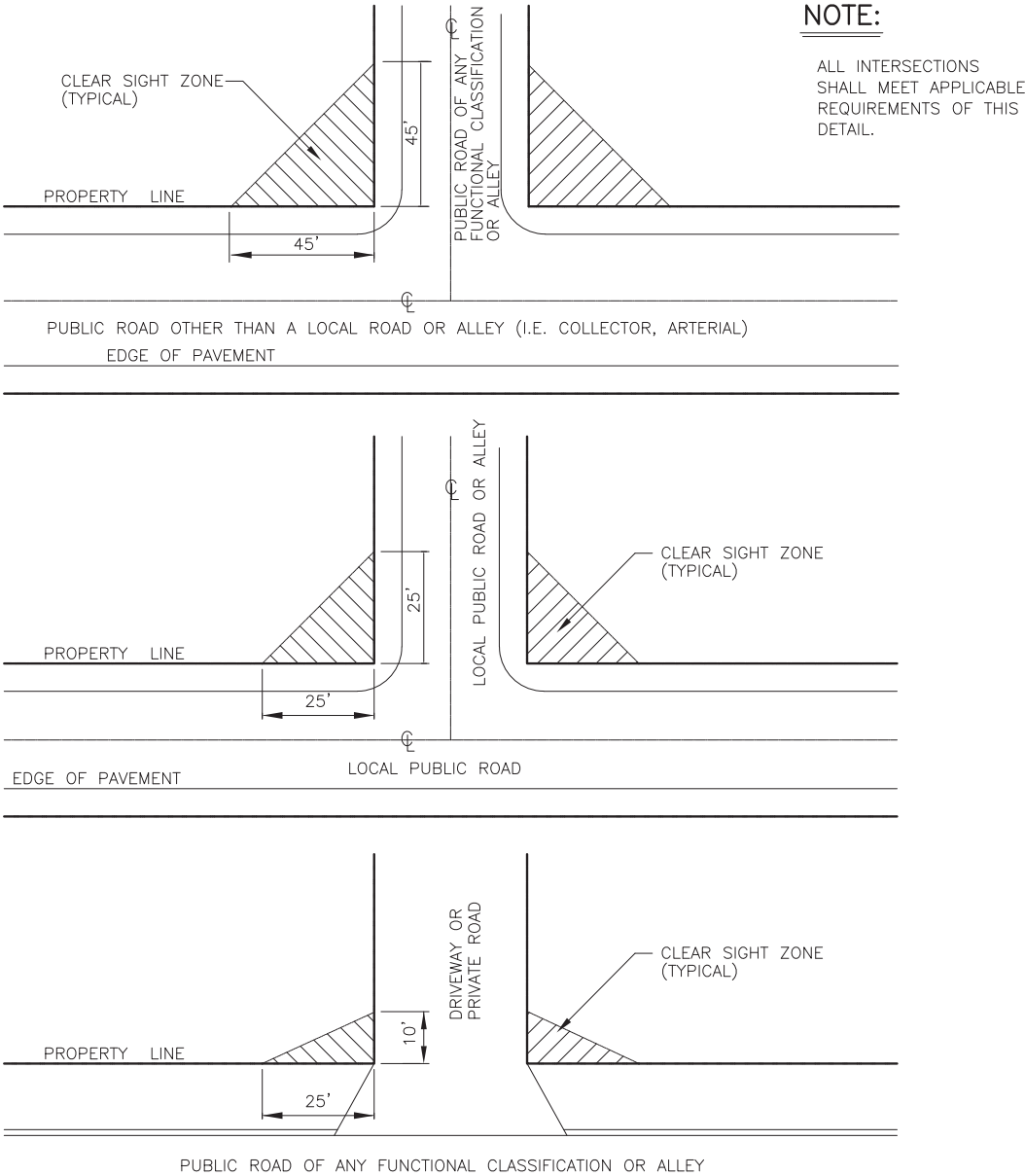

NOTE:

ALL INTERSECTIONS SHALL MEET APPLICABLE REQUIREMENTS OF THIS DETAIL.

Maximum height of ground cover in this zone is two feet (2').

TYPICAL MEDIAN TYPES

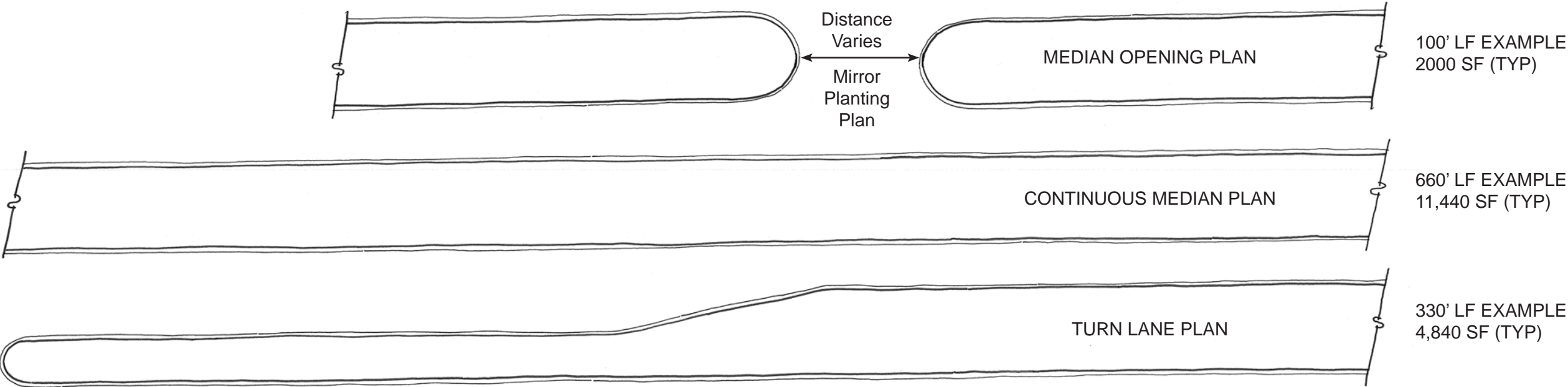

TYPICAL COVERAGE:

	100 LF	330 LF	660 LF
HIGH INTENSITY = 80% COVERAGE	1,600 SF	3,872 SF	9,152 SF
MEDIUM INTENSITY = 60% COVERAGE	1,200 SF	2,904 SF	6,864 SF
LOW INTENSITY = 40% COVERAGE	800 SF	1,936 SF	4,576 SF



PROPOSED LANDSCAPE PLAN

REFER TO AND APPLY INTERSECTION CLEAR SIGHT DISTANCE STANDARDS FROM CHAPTER 12 OF THE MOST CURRENT FDOT DESIGN MANUAL / CITY EXHIBIT G-22. ASSUMES 35 MPH DESIGN SPEED TREE SPACING (30' O.C. SPACING TREES <4" DIA. / 105' SPACING TREES <11" DIA. ASSUMES AVERAGE PLANT SPACING OF 30" O.C.

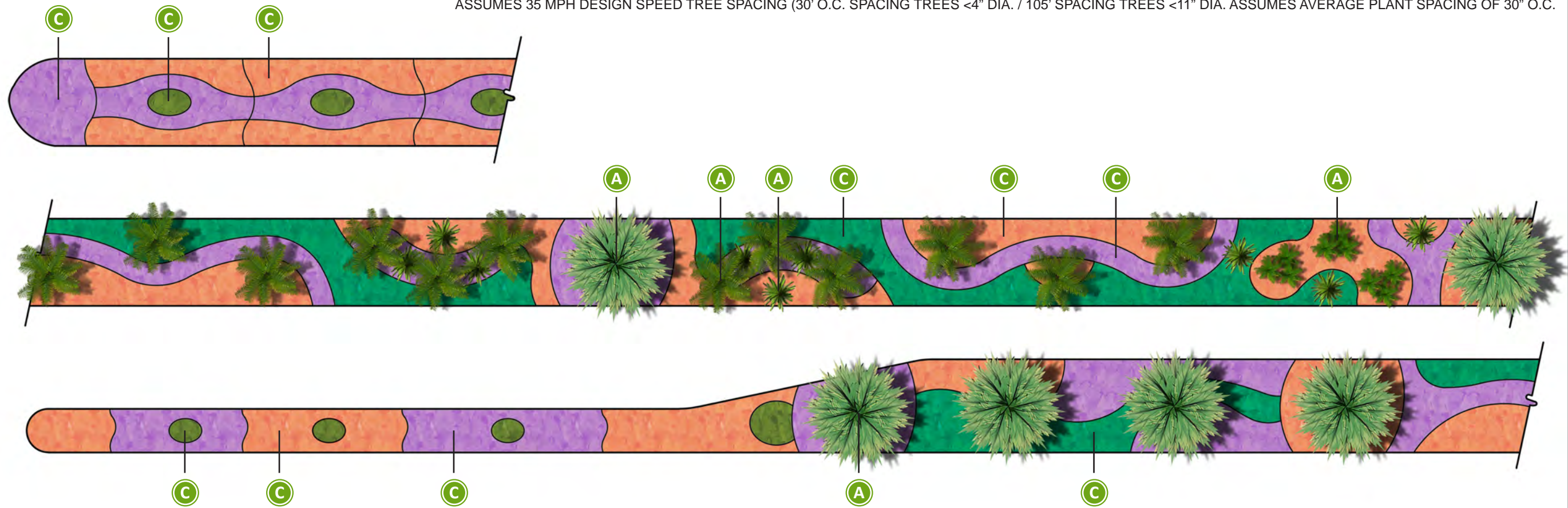

DRAWINGS NOT TO SCALE

SAMPLE PLANTS: (Refer to pages 16-19 for full plant list)

A. Palms



B. Shrubs



C. Accent / Ground Cover





PROPOSED LANDSCAPE PLAN

REFER TO AND APPLY INTERSECTION CLEAR SIGHT DISTANCE STANDARDS FROM CHAPTER 12 OF THE MOST CURRENT FDOT DESIGN MANUAL / CITY EXHIBIT G-22. ASSUMES 35 MPH DESIGN SPEED TREE SPACING (30' O.C. SPACING TREES <4" DIA. / 105' SPACING TREES <11" DIA. ASSUMES AVERAGE PLANT SPACING OF 30" O.C.

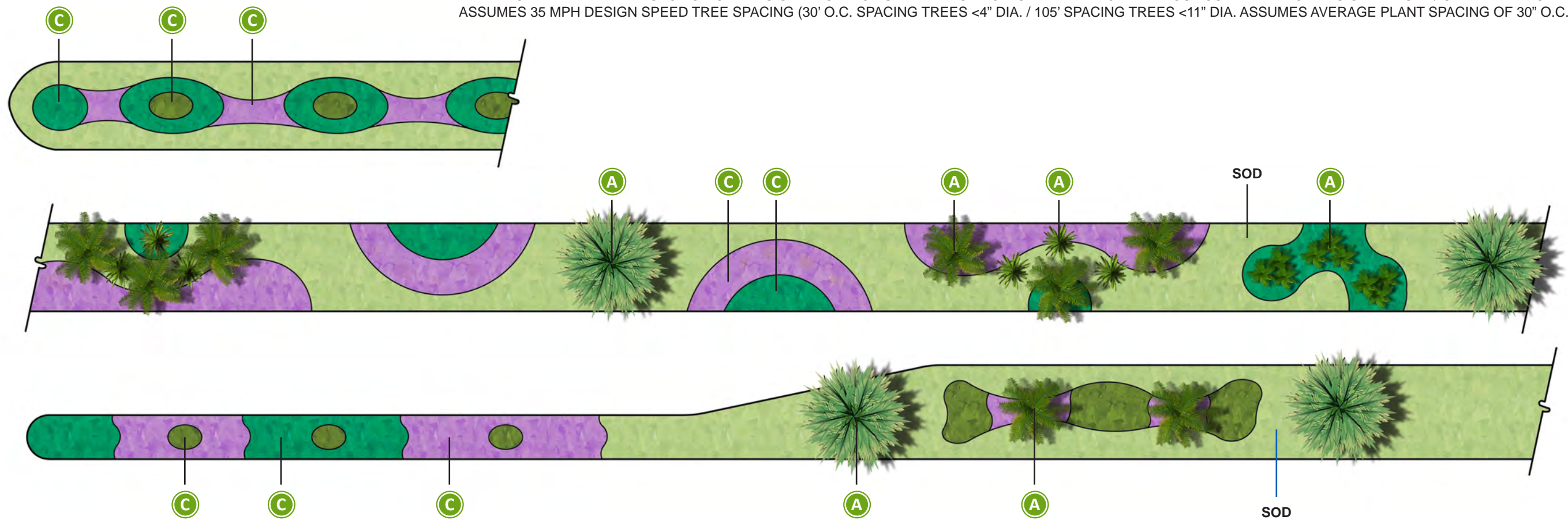

DRAWINGS NOT TO SCALE

SAMPLE PLANTS: (Refer to pages 16-19 for full plant list)

A. Palms



B. Shrubs



C. Accent / Ground Cover



Tropical

Medium Intensity (Example)

Cape Coral  
Median Landscape Templates



06.17.19 / C10212

PAGE 5



PROPOSED LANDSCAPE PLAN

REFER TO AND APPLY INTERSECTION CLEAR SIGHT DISTANCE STANDARDS FROM CHAPTER 12 OF THE MOST CURRENT FDOT DESIGN MANUAL / CITY EXHIBIT G-22. ASSUMES 35 MPH DESIGN SPEED TREE SPACING (30' O.C. SPACING TREES <4" DIA. / 105' SPACING TREES <11" DIA. ASSUMES AVERAGE PLANT SPACING OF 30" O.C.

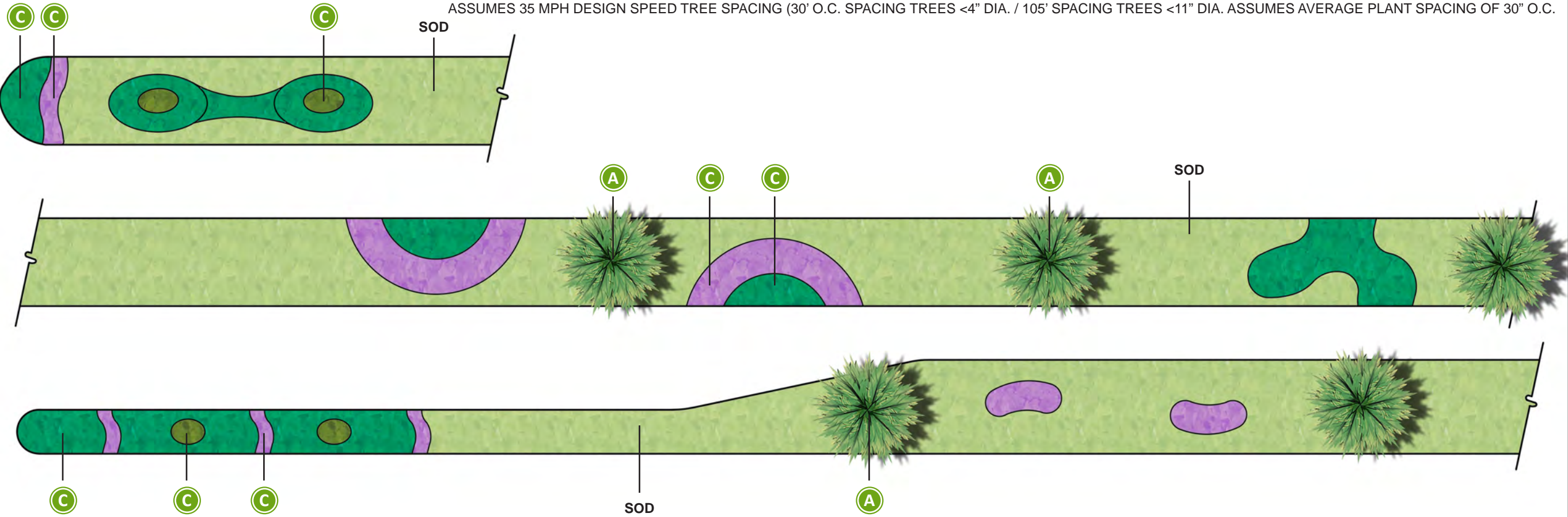

DRAWINGS NOT TO SCALE

SAMPLE PLANTS: (Refer to pages 16-19 for full plant list)

A. Palms



B. Shrubs



C. Accent / Ground Cover



Tropical

Low Intensity (Example)

Cape Coral  
Median Landscape Templates



06.17.19 / C10212

PAGE 6



PROPOSED LANDSCAPE PLAN

REFER TO AND APPLY INTERSECTION CLEAR SIGHT DISTANCE STANDARDS FROM CHAPTER 12 OF THE MOST CURRENT FDOT DESIGN MANUAL / CITY EXHIBIT G-22. ASSUMES 35 MPH DESIGN SPEED TREE SPACING (30' O.C. SPACING TREES <4" DIA. / 105' SPACING TREES <11" DIA. ASSUMES AVERAGE PLANT SPACING OF 30" O.C.

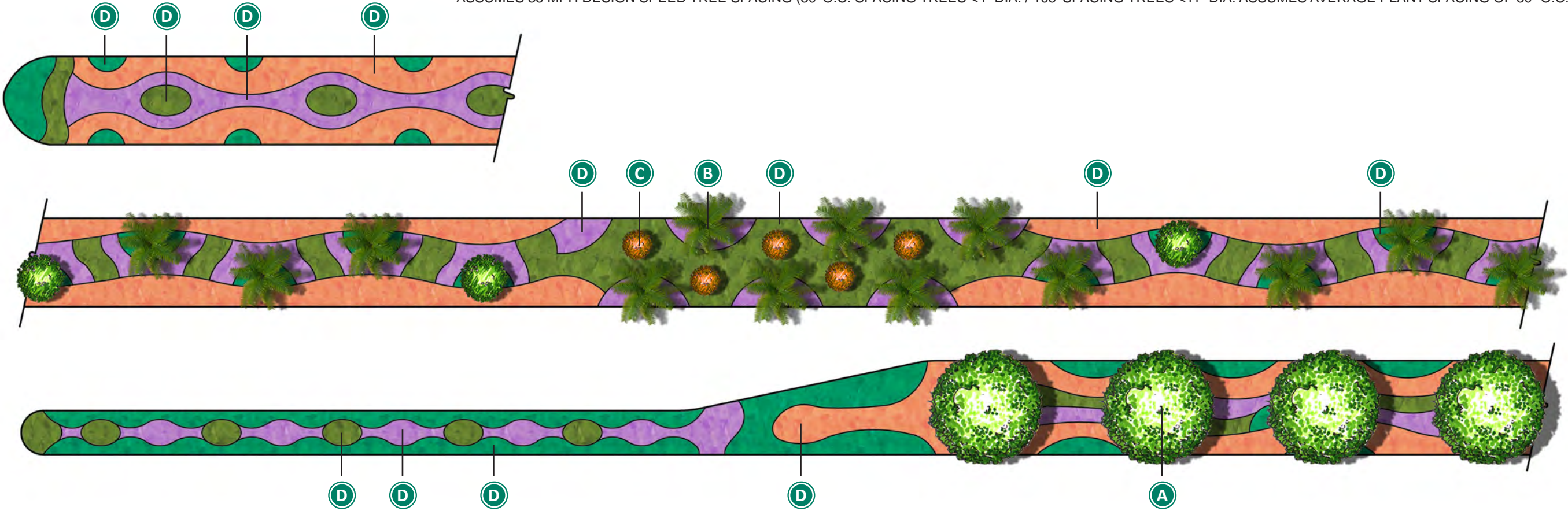

DRAWINGS NOT TO SCALE

SAMPLE PLANTS: (Refer to pages 16-19 for full plant list)



Mixed

High Intensity (Example)

Cape Coral  
Median Landscape Templates



cph

06.17.19 / C10212

PAGE 7



PROPOSED LANDSCAPE PLAN

REFER TO AND APPLY INTERSECTION CLEAR SIGHT DISTANCE STANDARDS FROM CHAPTER 12 OF THE MOST CURRENT FDOT DESIGN MANUAL / CITY EXHIBIT G-22. ASSUMES 35 MPH DESIGN SPEED TREE SPACING (30' O.C. SPACING TREES <4" DIA. / 105' SPACING TREES <11" DIA. ASSUMES AVERAGE PLANT SPACING OF 30" O.C.

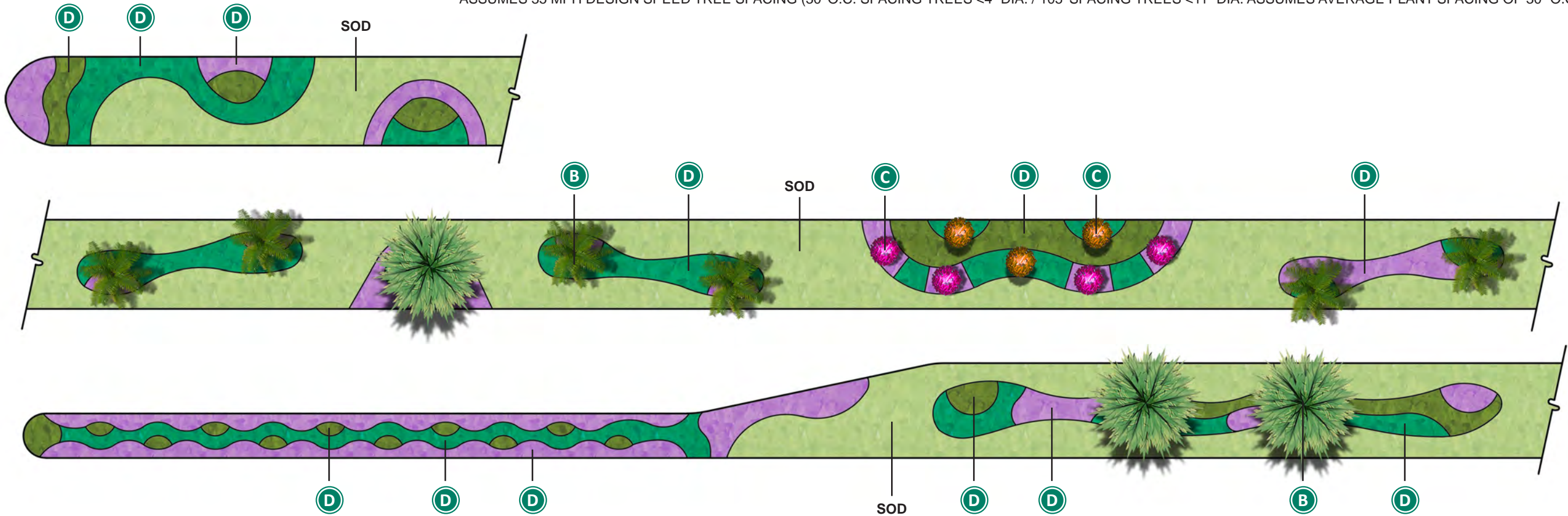

DRAWINGS NOT TO SCALE

SAMPLE PLANTS: (Refer to pages 16-19 for full plant list)

A. Trees



B. Palms

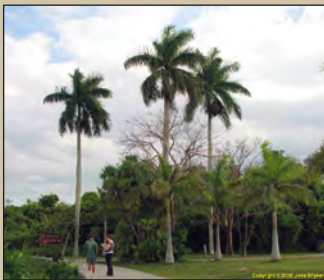

C. Shrubs



D. Accent / Ground Cover

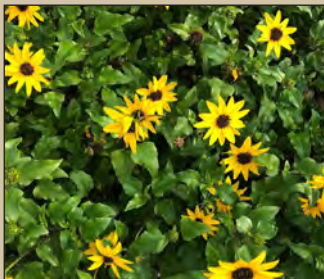

Mixed

Medium Intensity (Example)

Cape Coral  
Median Landscape Templates



06.17.19 / C10212

PAGE 8



PROPOSED LANDSCAPE PLAN

REFER TO AND APPLY INTERSECTION CLEAR SIGHT DISTANCE STANDARDS FROM CHAPTER 12 OF THE MOST CURRENT FDOT DESIGN MANUAL / CITY EXHIBIT G-22. ASSUMES 35 MPH DESIGN SPEED TREE SPACING (30' O.C. SPACING TREES <4" DIA. / 105' SPACING TREES <11" DIA. ASSUMES AVERAGE PLANT SPACING OF 30" O.C.

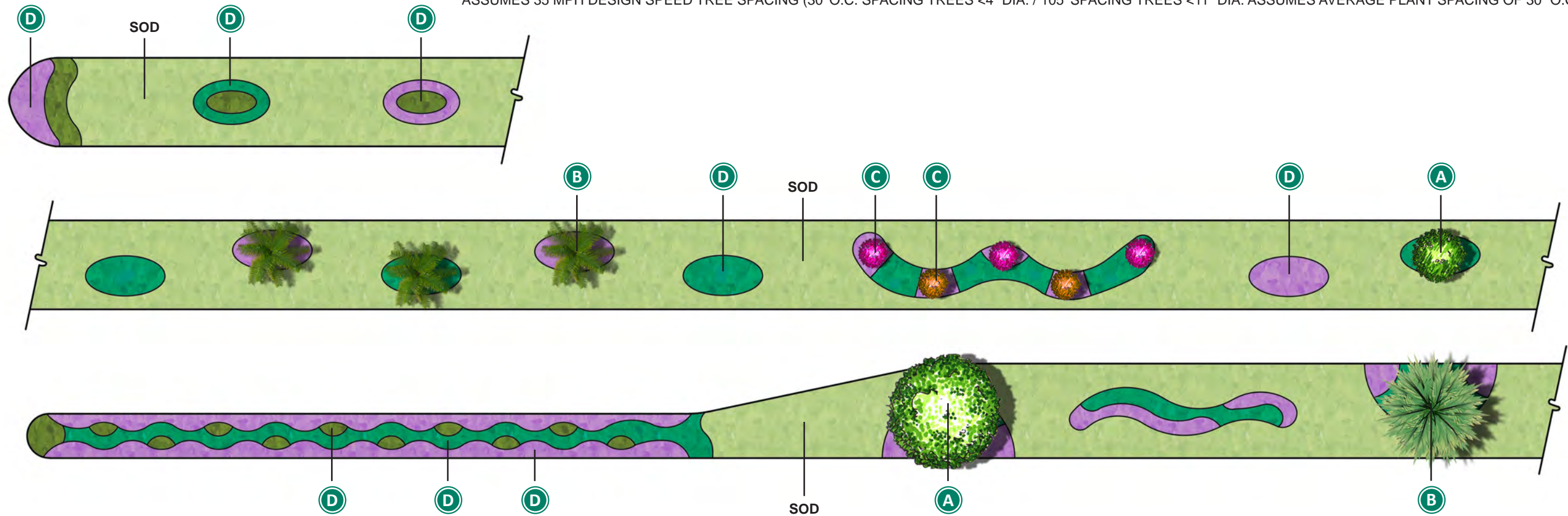

DRAWINGS NOT TO SCALE

SAMPLE PLANTS: (Refer to pages 16-19 for full plant list)

A. Trees		B. Palms		C. Shrubs		D. Accent / Ground Cover	
							
							

Mixed

Low Intensity (Example)

Cape Coral  
Median Landscape Templates



cph

06.17.19 / C10212

PAGE 9



PROPOSED LANDSCAPE PLAN

REFER TO AND APPLY INTERSECTION CLEAR SIGHT DISTANCE STANDARDS FROM CHAPTER 12 OF THE MOST CURRENT FDOT DESIGN MANUAL / CITY EXHIBIT G-22. ASSUMES 35 MPH DESIGN SPEED TREE SPACING (30' O.C. SPACING TREES <4" DIA. / 105' SPACING TREES <11" DIA. ASSUMES AVERAGE PLANT SPACING OF 30" O.C.

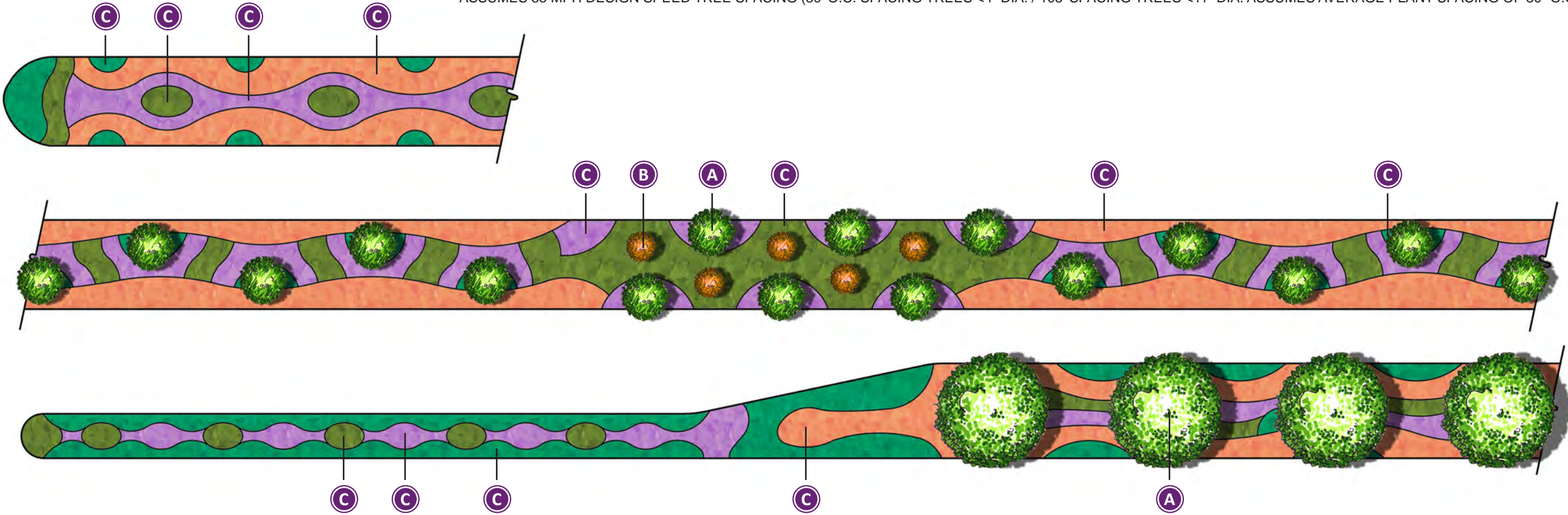

DRAWINGS NOT TO SCALE

SAMPLE PLANTS: (Refer to pages 16-19 for full plant list)

A. Trees



B. Shrubs



C. Accent / Ground Cover

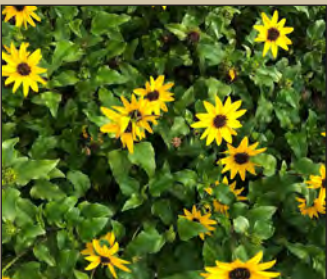

Shade

High Intensity (Example)

Cape Coral  
Median Landscape Templates





PROPOSED LANDSCAPE PLAN

REFER TO AND APPLY INTERSECTION CLEAR SIGHT DISTANCE STANDARDS FROM CHAPTER 12 OF THE MOST CURRENT FDOT DESIGN MANUAL / CITY EXHIBIT G-22. ASSUMES 35 MPH DESIGN SPEED TREE SPACING (30' O.C. SPACING TREES <4" DIA. / 105' SPACING TREES <11" DIA. ASSUMES AVERAGE PLANT SPACING OF 30" O.C.

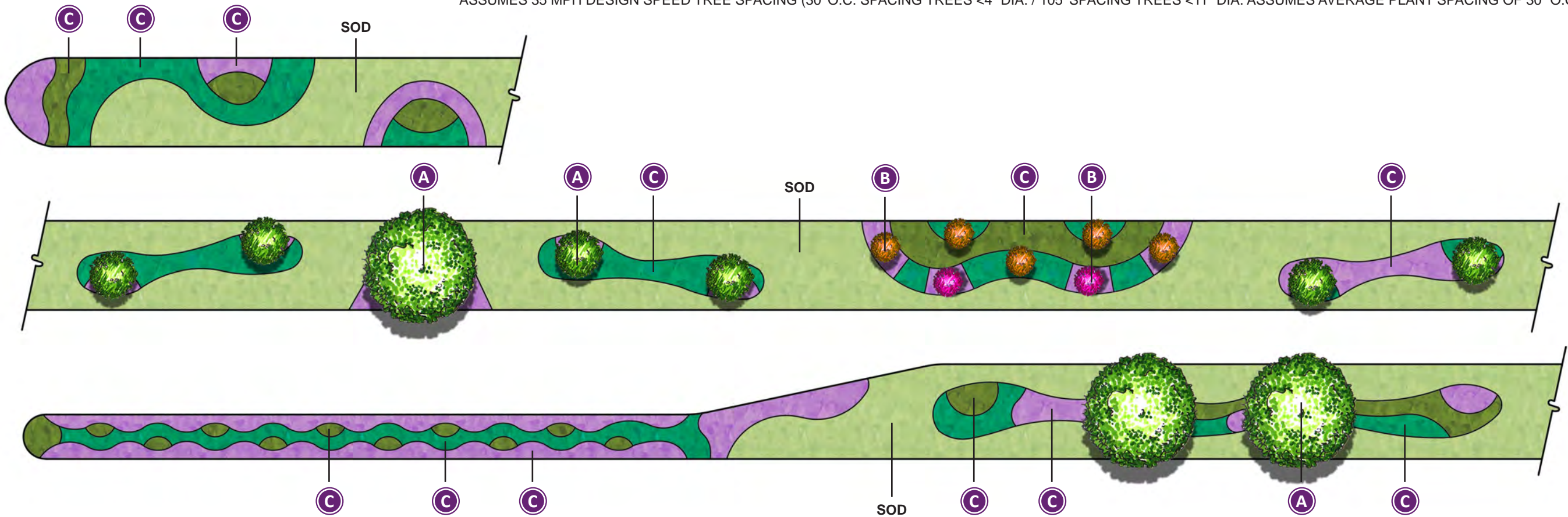

DRAWINGS NOT TO SCALE

SAMPLE PLANTS: (Refer to pages 16-19 for full plant list)

A. Trees



B. Shrubs



C. Accent / Ground Cover

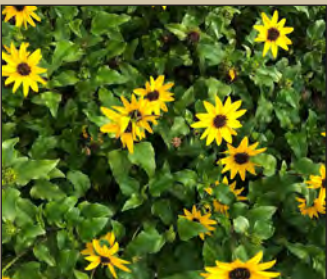

Shade

Medium Intensity (Example)

Cape Coral  
Median Landscape Templates



06.17.19 / C10212

PAGE 11



PROPOSED LANDSCAPE PLAN

REFER TO AND APPLY INTERSECTION CLEAR SIGHT DISTANCE STANDARDS FROM CHAPTER 12 OF THE MOST CURRENT FDOT DESIGN MANUAL / CITY EXHIBIT G-22. ASSUMES 35 MPH DESIGN SPEED TREE SPACING (30' O.C. SPACING TREES <4" DIA. / 105' SPACING TREES <11" DIA. ASSUMES AVERAGE PLANT SPACING OF 30" O.C.

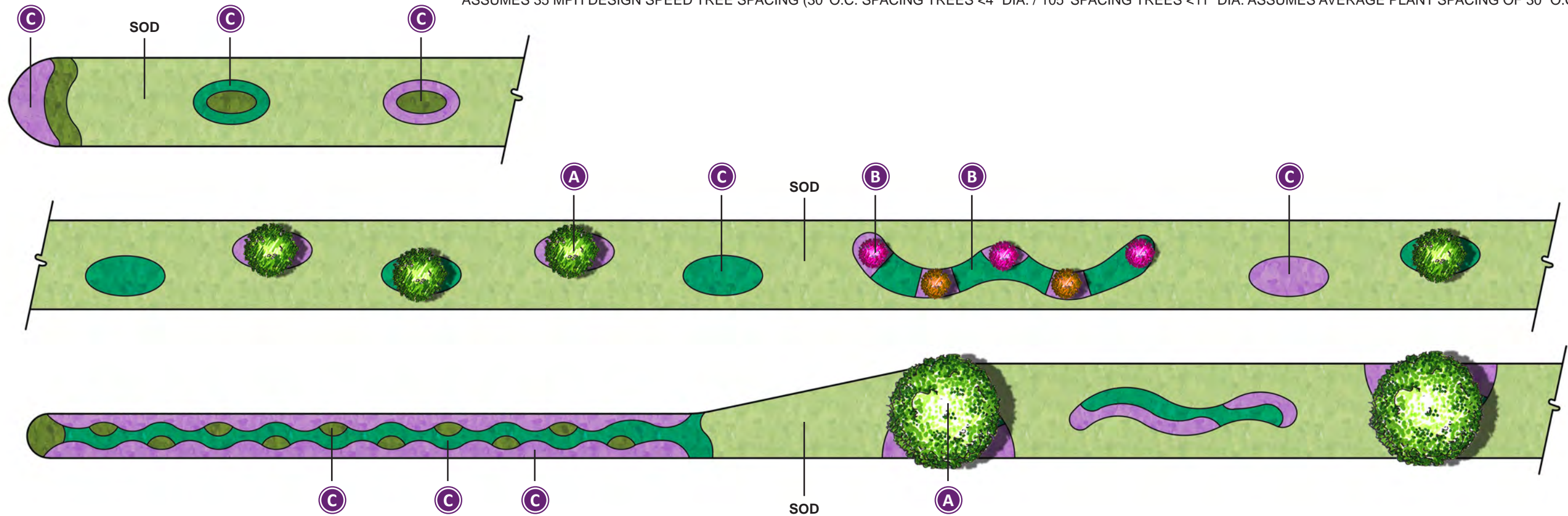

DRAWINGS NOT TO SCALE

SAMPLE PLANTS: (Refer to pages 16-19 for full plant list)

A. Trees



B. Shrubs



C. Accent / Ground Cover

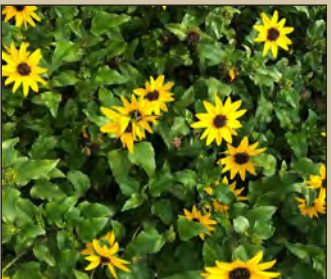

Shade

Low Intensity (Example)

Cape Coral  
Median Landscape Templates





PROPOSED LANDSCAPE PLAN

REFER TO AND APPLY INTERSECTION CLEAR SIGHT DISTANCE STANDARDS FROM CHAPTER 12 OF THE MOST CURRENT FDOT DESIGN MANUAL / CITY EXHIBIT G-22. ASSUMES 35 MPH DESIGN SPEED TREE SPACING (30' O.C. SPACING TREES <4" DIA. / 105' SPACING TREES <11" DIA. ASSUMES AVERAGE PLANT SPACING OF 30" O.C.

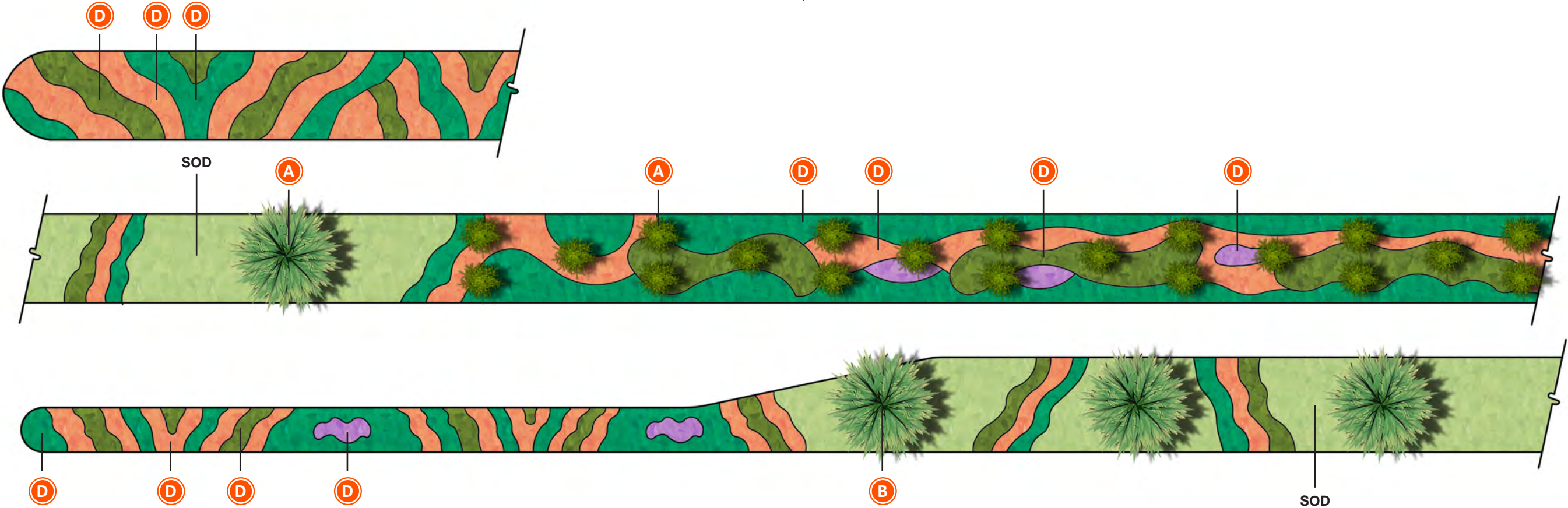

DRAWINGS NOT TO SCALE

SAMPLE PLANTS: (Refer to pages 16-19 for full plant list)

A. Trees		B. Palms		C. Shrubs		D. Accent / Ground Cover	



PROPOSED LANDSCAPE PLAN

REFER TO AND APPLY INTERSECTION CLEAR SIGHT DISTANCE STANDARDS FROM CHAPTER 12 OF THE MOST CURRENT FDOT DESIGN MANUAL / CITY EXHIBIT G-22. ASSUMES 35 MPH DESIGN SPEED TREE SPACING (30' O.C. SPACING TREES <4" DIA. / 105' SPACING TREES <11" DIA. ASSUMES AVERAGE PLANT SPACING OF 30" O.C.

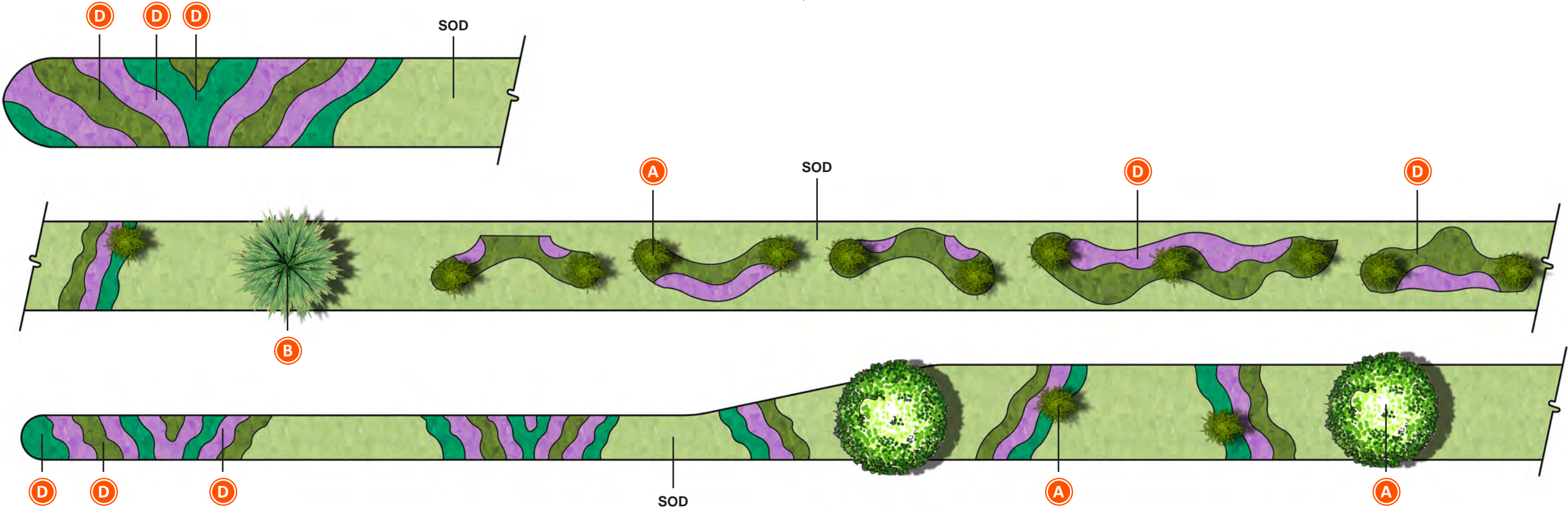

DRAWINGS NOT TO SCALE

SAMPLE PLANTS: (Refer to pages 16-19 for full plant list)

A. Trees		B. Palms		C. Shrubs		D. Accent / Ground Cover	
							
							



PROPOSED LANDSCAPE PLAN

REFER TO AND APPLY INTERSECTION CLEAR SIGHT DISTANCE STANDARDS FROM CHAPTER 12 OF THE MOST CURRENT FDOT DESIGN MANUAL / CITY EXHIBIT G-22. ASSUMES 35 MPH DESIGN SPEED TREE SPACING (30' O.C. SPACING TREES <4" DIA. / 105' SPACING TREES <11" DIA. ASSUMES AVERAGE PLANT SPACING OF 30" O.C.

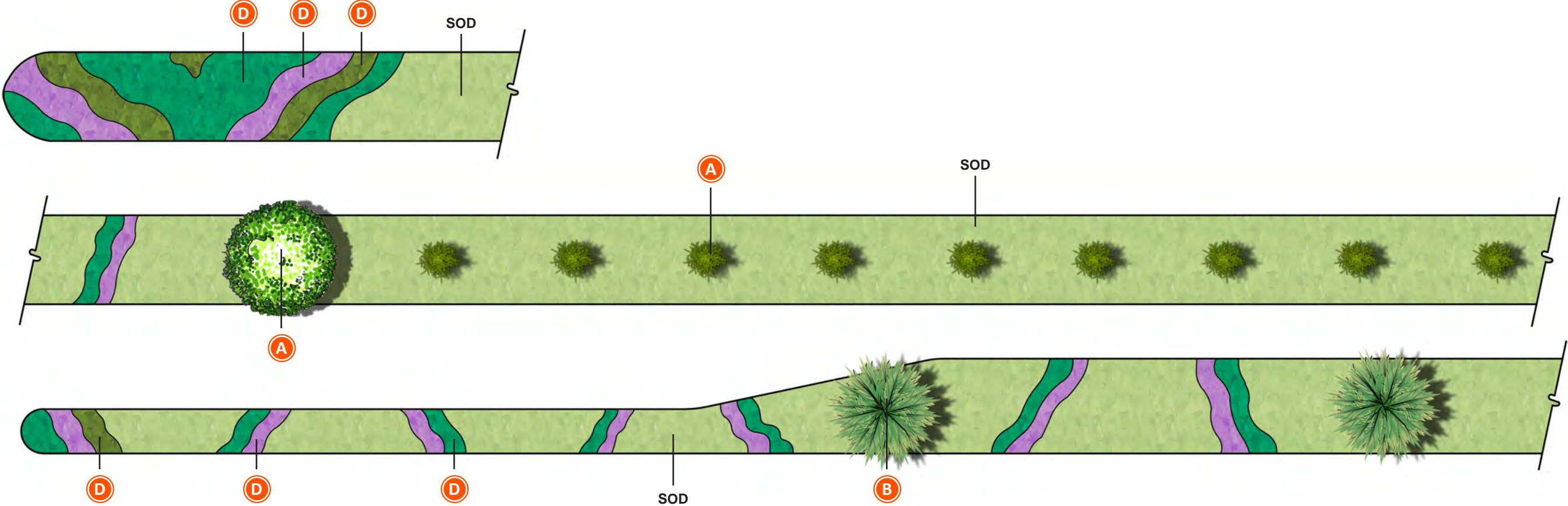

DRAWINGS NOT TO SCALE

SAMPLE PLANTS: (Refer to pages 16-19 for full plant list)

A. Trees		B. Palms		C. Shrubs		D. Accent / Ground Cover	
							
							

Xeriscape  
Low Intensity (Example)

Cape Coral  
Median Landscape Templates



cph



TREES										
COMMON NAME	OTHER NAMES	BOTANICAL NAME		MEDIAN THEME APPLICATION			MATURE HEIGHT	MATURE SPREAD	RECOMMENDED SPACING	NOTES / COMMENTS
			Tropical	Mix	Shade	Xerisape				
Black Olive Tree	Shady Lady, Gregorywood, Oxhorn Bucida, Bucida (various)	Bucida buceras					40'-50'	35'-50'	Equal to spread	Due to potential root damage the use of this tree is recommended to be used only in limited areas that have sufficient open areas. Should not be used immediately adjacent to walkways, medians and/or paved areas. Best for open lateral/parallel green areas.
Bottle Brush		Callistemon citrinus or viminalis					10'-15'	10'-15'	Equal to spread	
Buttonwood	Green Buttonwood	Conocarpus erectus					30'-45'	20'-30'	5' o.c. (for shrub)//Equal to spread for tree form	
Buttonwood	Silver Buttonwood	Conocarpus erectus var.sericeus					30'-45'	20'-30'	5' o.c. (for shrub)//Equal to spread for tree form	
Crape Myrtle	Muskogee	Lagerstroemia indica					10'-30'	15'-25'	Equal to spread	
Cypress-Bald	Bald Cypress	Taxodium distichum					100'-150'	40'-50'+	Equal to spread	Due to suckering/developing knees and rapid growth, the use of this tree is limited to areas that have sufficient open areas and should not be used in medians. Do not place immediately adjacent to walkways, medians and/or paved areas. Best for open lateral/parallel green areas.
Fiddlewood		Citharexylum fruticosum					15'-25'	10'-15'	Equal to spread	Can be trained to be shrub form or can be tree form.
Florida Privet	"Florida Swamp Privet, and Southern Privet"	Forestiera segregata					10'-15'	5'-10'		Can be trained to be shrub form or can be tree form.
Geiger Tree		Cordia sebestena L.					25'-30'	20'-25'	Equal to spread	
Gumbo Limbo		Bursera simaruba					25'-50'	25'-50'	Equal to spread	Can be used in medians, growth rate is slow and roots have not proven to be issues when planted in medians and/or parking lot aisles.
Holly-East Palataka	Savannah Holly	Ilex x attenuata 'Savannah'					30'-45'	15'-20'	Equal to spread	
Holly-Yaupon	Yaupon	Ilex vomitoria					15'-25'	15'-20'	Equal to spread	
Jacaranda Tree		Jacaranda mimosifolia					25'-40'	45'-60'	Equal to spread	Due to size and potential root damage the use of this tree is should be limited to areas that have sufficient open areas. Should not be used immediately adjacent to walkways, medians and/or paved areas. Best for open lateral/parallel green areas.
Jamaican Caper		Capparis cynophallophora					6'-15'	8'-12'	3'-5' o.c. (for shrub)//10'-15' o.c. spread for tree form	
Japanese Blueberry		Elaeocarpus decipens					20'-40'	15'-25'	Equal to spread	
Magnolia	Southern Magnolia, Little Gem	Magnolia grandiflora L.					30'-35'	10'-25'	Equal to spread	
Oak-Live		Quercus virginiana Mill.					40'-60'	60'-100'	Equal to spread	Due to potential root damage the use of this tree is recommended to be used only in limited areas that have sufficient open areas. Should not be used immediately adjacent to walkways, medians and/or paved areas. Best for open lateral/parallel green areas.
Pigeon Plum		Coccoloba diversifolia					15'-25'	20'-30'	Equal to spread	
Poinciana: Royal	Poinciana Tree	Delonix regia (Bojer ex Hook.) Raf.					30'-40'	50'-60'	1.5 times spread	Due to potential root damage the use of this tree is recommended to be used only in limited areas that have sufficient open areas. Should not be used immediately adjacent to walkways, medians and/or paved areas. Best for open lateral/parallel green areas.
Poinciana: Yellow	Yellow Flame Tree, Copper-Pod	Peltophorum pterocarpum					30'-40'	50'-60'	1.5 times spread	Due to potential root damage the use of this tree is recommended to be used only in limited areas that have sufficient open areas. Should not be used immediately adjacent to walkways, medians and/or paved areas. Best for open lateral/parallel green areas.
Poinciana: Dwarf	Peacock Flower, Barbados Pride	Caesalpinia pulcherrima (L.) Sw.					10'-15'	10'-15'	Equal to spread	
Red Maple		Acer rubrum L.					60'-75'	25'-35'	Equal to height	
Satinleaf		Chrysophyllum oliviforme					35'-45'	20'-25'	Equal to height	
Screw Pine	N/A	Pandanus utilis Bory					20'-60'	15'-20'	Equal to height	
Sea Grape	N/A	Coccoloba uvifera					25'-30'	20'-30'	Equal to spread	Can be trained to be shrub form or can be tree form.
Slash Pine	Cuban Pine, Dade County Pine, Dade County Slash Pine, Pitch Pine, Slash Pine, South Florida Slash Pine, Swamp Pine	Pinus elliotii					75'-100'	35'-50'	1.5 times spread	Due to height and spread, the use of this species shall be restricted to areas with sufficient areas and nearby adjacent overhead utilities.
Southern Redcedar		Juniperus silicicola					30'-45'	20'-30'	Equal to height	Due to size and potential root damage the use of this tree is should be limited to areas that have sufficient open areas. Should not be used immediately adjacent to walkways, medians and/or paved areas. Best for open lateral/parallel green areas.
Swamp Apple	Pitch Apple, Pond Apple	Annona glabra					10'-20'	10'-15'	Equal to spread	Good plant to use in wet areas (e.g. detention areas)
Sweet Acacia		Acacia farnesiana					15'-25'	15'-25'	Equal to spread	Not to be used in medians and/or parking lots where canopy clearances for vehicles is necessary. Use in areas where tree and canopy can spread. Lateral right of ways, wide medians with no sight restrictions can be ideal locations.
Wax Myrtle		Myrica cerifera					20'-25'	20'-25'	1.5 times spread	
Wild Tamarind		Lysiloma bahamensis					40'-60'	30'-50'	Equal to height	Due to potential root damage the use of this tree is recommended to be used only in limited areas that have sufficient open areas. Should not be used immediately adjacent to walkways, medians and/or paved areas. Best for open lateral/parallel green areas.
Wild Tamarind		Lysiloma latisiliquum					40'-60'	30'-50'	Equal to height	Due to potential root damage the use of this tree is recommended to be used only in limited areas that have sufficient open areas. Should not be used immediately adjacent to walkways, medians and/or paved areas. Best for open lateral/parallel green areas.

Plant Lists

& Specifications

Cape Coral

Median Landscape Templates



cph

06.17.19 / C10212

PAGE 16



PALMS										
COMMON NAME	OTHER NAMES	BOTANICAL NAME		MEDIAN THEME APPLICATION			MATURE HEIGHT	MATURE SPREAD	RECOMMENDED SPACING	NOTES / COMMENTS
			Tropical	Mix	Shade	Xerisape				
Palm-Alexander		Ptychosperma elegans					15'-20'	10'-15'	Equal to spread	Narrow/slim trunk palm. Can be found in multiple trunk clusters
Palm-Areca	Golden Cane, Yellow Butterfly, Madagascar, Areca lutescens	Dypsis lutescens (H. Wendl.) Beentje & Dransf.					25'-35'	10'-20'	Equal to spread	This species will be limited to select locations and will be considered on a case by case basis. Approval and/or rejection of this palm will vary.
Palm-Bismarckia	Bismark, Bismarckia, Bismarkia	Bismarckia nobilis					30'-60'	15'-20'	Equal to height	Spacing equal to height. This is a showy palm and needs plenty of room. Very susceptible to diseases and pest infestations.
Palm-Buccaneer		Psuedophoenix sargentii					10'-25'	8'-15'	Equal to spread	Very slow growing. Sometimes difficult to source palms greater than 5' o.a. height.
Palm-Canary Island Date		Phoenix canariensis								
Palm-Carpentaria		Carpentaria acuminata								
Palm-Christmas	Manila Palm, Adonidia	Veitchia merrillii					20'-25'	10'-15'	Equal to spread	Adonidia merrillii is synonymous with Veitchia merrillii
Palm-Coconut		Cocos nucifera					35'-40'	15'-20'	Equal to height	Not to be placed in medians with high traffic (vehicle and/or pedestrian) volumes.
Palm-Foxtail		Wodyetia bifurcata					20'-30'	15'-20'	Equal to height	Watch for signs of Micronutrient deficiencies
Palm-European Fan										
Palm-King Alexander	Alexander Palm, Alexandra Palm, King Alexander Palm, Northern Bangalow Palm	Archontophoenix cunning-hamiana					20'-40'	10'-15'	Equal to height	Narrow/slim trunk palm. Can be found in multiple trunk clusters
Palm-Latania Blue		Latania spp.					20'-30'	10'-15'	Equal to height	Similar appearance to Bismarckia. Also a red cultivar in some limited areas.
Palm-Majesty	Majestic Palm	Ravenea rivularis					15'-20'	10'-15'	Equal to height	Can be fast growing palm.
Palm-Montgomery		Veitchia montgomeryana					25'-35'	15'-20'	Equal to spread	They have combined the Vietchia montgomeryana with the vietchia mcdanielsii and lumped them together to make the vietchia arecina
Palm-Palmetto (Silver)	Saw Palmetto (green/silver)	Serenoa repens					5'-10'	4'10'	Equal to height	
Palm-Palmetto (Scrub)	Scrub Palm, Scrub Palmetto	Sabal etonia Swingle ex Nash					3'-6'	3'-5'	Equal to height	
Palm-Paurotis	Everglades Palm	Acoelorrhaphe wrightii					30'	20'	Equal to spread	
Palm-Piccabeen		Archontophoenix cunning-hamiana					20'-30'	10'-15'	Equal to spread	
Palm-Pindo		Butia capitata					15'-20'	10'-15'	Equal to height	
Palm-Pygmy	Miniature Date Palm, Pygmy Date Palm	Phoenix roebelenii					15'-20'	10'-15'	Equal to spread	
Palm-Reclinata		Phoenix reclinata					25'-50'	15'-20'	Equal to spread	
Palm-Ribbon		Livistona decipiens					30'-50'	15'-20'	Equal to spread	
Palm-Royal	Florida Royal Palm	Roystonea regia					50'-70'	20'-25'	Equal to spread	
Palm-Sabal	Cabbage Palm, Palmetto	Sabal palmetto					20'-40'	15'-20'	Equal to spread	
Palm-Spindle		Hyophorbe verschaffeltii					20'-25'	10'-15'	Equal to spread	
Palm-Sylvester		Phoenix sylvestris (L.) Roxb.					40'-50'	15'-25'	Equal to spread	
Palm-Thatch	Florida Thatch	Thrinax radiata					15'-20'	5'-10'	Equal to height	
Palm-Thatch (Silver)	Silver Thatch, Silverpalm	Coccothrinax argentata					5'-20'	5'-10'	Equal to spread	
Palm-Triangle		Dypsis decaryi					25'-35'	10'-15'	Equal to spread	
Palm-Wax		Copernicia prunifera					25'-30'	10'-15'	Equal to spread	
MULCH										
COMMON NAME										NOTES / COMMENTS
Mulch-Cypress										3" loose depth
Mulch-Flora										3" loose depth
Mulch-Red										3" loose depth
Mulch rings are to be used around all trees, palms, utility boxes, sign posts, electrical services/panels and as indicated by the City's representative. New medians will establish mulch type & mulch color to be utilized the remainder of roadway. If mulch already exists in an approved landscaped median on the subject roadway, the same mulch shall be required throughout the remainder of the roadway.										



SHRUBS...										
COMMON NAME	OTHER NAMES	BOTANICAL NAME		MEDIAN THEME APPLICATION			MATURE HEIGHT	MATURE SPREAD	RECOMMENDED SPACING	NOTES / COMMENTS
			Tropical	Mix	Shade	Xerisape				
Arboricola	Dwarf Schefflera, Dwarf Scheff, Trinette	Schefflera arboricola					10'-15'	6'-15'	5' o.c. (for shrub)//Equal to spread for tree form	
Bahama Cassia		Cassia bahamensis					3'-9'	6'-10'	5' o.c. for hedge//space equal to spread for individual shrub form	
Beach Sunflower		helianthus debilis					2'-4'	2'-4'	3' o.c.	
Beautyberry	American Beautyberry	Callicarpa americana					3'-8'	4'-8'	5' o.c.	
Blue Porterweed		Stachytarpheta jamaicensis					4'-8'	4'-8'	3'-5' o.c.	
Bougainvillea	Paper Flower, Helen Johnson	Bougainvillea spp					1'-20'+	15'-40'	5' o.c. (for shrub)//Equal to spread for tree form	
Bougainvillea-Dwarf		Bougainvillea spp					1'-20'+	15'-40'	5' o.c. (for shrub)//Equal to spread for tree form	
Cape Honeysuckle		Tecomaria capensis					10'-12'	25'+	3' o.c. (for shrub)	Can be used as a shrub or vine for screening purposes. Due to growth potential, recommend maintaining 10' buffer from trees/palms, walls, and/or structures. Growth can be very aggressive and rampant. When used as a shrub, often best responds when allowed to naturally form shape in-lieu of heavy pruning/shaping cuts. 'Aurea' cultivar has yellow flowers, 'Apricot' cultivar has organge flowers.
Carissa-Emerald Blanket	Emerald Blanket	Carissa macrocarpa					1'-2'	4'-8'	3'-5' o.c.	Emerald Blanket is the dwarf cultivar, and its low spreading
Carissa-Boxwood	Boxwood	Carissa macrocarpa					1'-2'	4'-8'	3'-5' o.c.	This cultivar is a compact, mounded shrub, makes a nice foundation plant. Has spreading habit and can be used as a ground cover shrub as well.
Carissa-Dwarf Natal Plum	Dwarf Natal Plum	Carissa macrocarpa					1'-2'	4'-8'	3'-5' o.c.	Natal Plum is the largest of the three, and has a bit more of an open foliage pattern to it. This cultivar is used mainly as an accent or foundation plant
Clusia	Pitch Apple	Clusia rosea & Clusia guttifera					25'-30'	15'-25'	5' o.c. (for shrub)//Equal to spread for tree form	
Cocoplum	Ikaco	Chrysobalanus icaco L.					3'-15'	3'-15'	5' o.c. (for shrub)//Equal to spread for tree form	
Cocoplum	Ikaco	Chrysobalanus icaco Horizontalis					3'-15'	3'-15'	5' o.c. (for shrub)//Equal to spread for tree form	
Coontie	Florida Arrowroot	Zamia floridana					2'-4'	3'-5'	3'-5' o.c.	
Croton		Codiaeum variegatum					3'-8'	3'-6'	5' o.c.	Numerous Cultivars Available
Dracaena		Dracaena var					1'-40'	2'-20'	Equal to spread	Numerous Cultivars Available
Fakahatchee Grass-Dwarf		Tripsacum floridanum					2'-3'	4'-6'	3'-5' o.c.	
Fakahatchee Grass-Full		Tripsacum floridana					3'-5'	4'-6'	3'-5' o.c.	
Flax Lily		Dianella tasmanica					1'-4'	2'-4'	Equal to spread	
Fiddlewood		Citharexylum fruticosum					15'-25'	10'-15'	3'-5' o.c.	Can be trained to be shrub form or can be tree form.
Fire Bush	Scarlet Bush, Hummingbird Bush	Hamelia patens Jacq.					6'-12'	5'-8'	Equal to spread	
Fire Bush	Native	Hamelia patens								
Fire Bush-Dwarf	Dwarf Firebush	Hamelia patens var glabra or compacta								
Florida Privet	"Florida Swamp Privet, and Southern Privet"	Forestiera segregata					10'-15'	5'-10'		Can be trained to be shrub form or can be tree form.
Foxtail Fern	Myers or Myers Asparagus	Asparagus densiflorus					1'-2'	2'-4'	Equal to spread	
Golden Dewdrop		Duranta repens					10'-15'	10'-20'	5' o.c. for hedge//space equal to spread for individual shrub form	Native
Golden Dewdrop		Duranta erecta					10'-15'	10'-20'	5' o.c. for hedge//space equal to spread for individual shrub form	Not Native
Green Island Ficus		Ficus microcarpa					3'-4'	2'-4'	3'-5' o.c.	Can be spaced closer if desired. Used frequently in median locations to replace Indian Hawthorns, few pest problems experienced.
Holly-Dahoon	N/A	Ilex cassine					20'-30'	10'-15'	Equal to spread	
Ilex Schilling	Dwarf Holly, Dwarf Schilling	Ilex vomitoria					4'-7'	7'-10'	5' o.c.	
Jamaican Caper		Capparis cynophallophora					10'-15'	6'-12'	Equal to spread	"Can be utilized as an understory tree in the partial shade. Train the plant into a tree by removing low, drooping branches, and heading upright branches to thicken their diameter. It can also be clipped into a hedge or tall screen to block an undesirable view"
Jasmine-Downy		Jasminum multiflorum					5'-15'	5'-10'	Equal to spread	
Jasmine-Wax		Jasminum simplicifolium (aka) Jasminum volubile					5'-15'	5'-10'	Equal to spread	
Jasmine-Star		Jasminum nitidum					5'-15'	5'-10'	Equal to spread	
Jatropha	Peregrina, Spicy Jatropha	Jatropha integerrima compacta					10'-15'	10'-15'	Equal to spread	
Ligustrum	Japanese Privet	Ligustrum japonicum					10'-15'	15'-25'	Equal to spread	

Plant Lists

& Specifications

Cape Coral

Median Landscape Templates



**cph**

06.17.19 / C10212

PAGE 18



SHRUBS...										
COMMON NAME	OTHER NAMES	BOTANICAL NAME		MEDIAN THEME APPLICATION			MATURE HEIGHT	MATURE SPREAD	RECOMMENDED SPACING	NOTES / COMMENTS
			Tropical	Mix	Shade	Xerisape				
Muhly Grass	Regal Mist, Hairawn Muhly	Muhlenbergia capillaris					3'-5'	3'-5'	Equal to spread	
Necklace Pod		Sophora tomentosa var. truncata					5'-10'	10'-15'	5' o.c. for hedge//space equal to spread for individual shrub form	
Palm-Palmetto (silver)	Saw Palmetto (green/silver)	Serenoa repens					5'-10'	4'10'	Equal to height	
Philodendron		Philodendron bipinnatifidum								
Plumbago	Leadwort, Skyflower	Plumbago auriculata Lam.								
Sea Grape	N/A	Coccoloba uvifera					25'-30'	20'-30'	Equal to spread	
Shrimp Plant		Justicia brandegeana								
Simpson's Show Stopper	Twinberry	Myrcianthes fragrans								
Varnish Leaf	Hopbush	Dodonaea viscosa					10'-15'	5'-15'	Equal to spread	Availability may be limited and hard to source due.
Wax Myrtle-Dwarf		Myrica pumila								
White Stopper		Eugenia axillaris								
GROUND COVER										
COMMON NAME	OTHER NAMES	BOTANICAL NAME		MEDIAN THEME APPLICATION			MATURE HEIGHT	MATURE SPREAD	RECOMMENDED SPACING	NOTES / COMMENTS
			Tropical	Mix	Shade	Xerisape	2'-4'	2'-4'	3' o.c.	Use of this as groundcover will be limited in areas outside of 100' from median ends.
Beach Sunflower		Helianthus debilis					1'-2'	2'-3'	1'-2" o.c.	Annual/Seasonal flower.
Blanket Flower		Gaillardia pulchella					.5'-1'	1'-2'	3' o.c.	Allow to spread to fill in. Can be susceptible to mites. Not recommended to be used where soils are not well drained.
Blue Daze		Evolvulus glomeratus					1'-3'	2'-3'	Equal to spread	
Crown of Thorns	Christ Thorns, Christ Plant	Euphorbia milii								
Golden Creeper		Ernodea littoralis					1'-2'	1'-2'	Equal to spread	
Liriope	Border Grass, Lily-Turf	Liriope muscari (Decne.) L.H. Bailey					3'-4'	2'-4'	3'-5" o.c.	Slow growing and can be used in median ends. Is susceptible to spider mites.
Parson Juniper	Dahurian Juniper	Juniperus davurica 'Parsonii'					.5'-1'	1'-2'	3' o.c.	
Perennial Peanut		Arachis glabrata								Can be aggressive in growth. Use may be limited/restricted to select medians/areas.
Railroad Vine		Ipomoea pes-caprae								
Society Garlic	Pink Agapanthus	Tulbaghia violacea (Tulbaghia L.- at least 20 varieties of this species)					N/A	N/A	N/A	
Sod-Bahia		Bahia spp.					N/A	N/A	N/A	
Sod-St. Augustine							N/A	N/A	N/A	
BEDDING PLANTS										
COMMON NAME	OTHER NAMES	BOTANICAL NAME		MEDIAN THEME APPLICATION			SUN EXPOSURE	PLANTING PERIOD (ADD-REMOVE)	RECOMMENDED SPACING	NOTES / COMMENTS
			Tropical	Mix	Shade	Xerisape				
Ageratum	Blue Horizon	Ageratum houstonianum					Full Sun	February-July	10"-12" o.c.	
Celosia	Cockscomb	Celosia argenta					Full Sun	February-July	10"-12" o.c.	
Coleus		Coleus x hybridus					Sun to Partial Shade	Year Round	18"-24" o.c.	
Cosmos		Cosmos bipannatus					Full Sun	Year Round	12"-18" o.c.	Remove and Replace every 3 months or as they decline
Gazania		Gazania splendens					Full Sun	Year Round	8"	
Geranium		Pelargonium x hortorum					Full Sun	October-May	12"-18" o.c.	Tolerates Cold and Sale Spray
Impatiens		Impatiens wallerana					Partial to Full Shade	October-May	12"-18" o.c.	
Jacobinia		Justicia carnea					Partial to Full Shade	Spring-Summer	12"-14" o.c.	
Melampodium		Melampodium paludosum					Sun to Partial Shade	Year Round	12"-18" o.c.	Great for Summer
Moss Rose	Purslane, Portulaca	Portulaca grandiflora					Full Sun	Spring-Summer	10"-12" o.c.	
Torenia		Torenia fournieri					Sun to Partial Shade	February-December	12"-18" o.c.	Does well in heat
Zinnia		Zinnia elegans					Sun to Partial Shade	Spring-Summer	12"-14" o.c.	Use Viola cultivar for cooler winter months. Attracts bees and butterflies.
Bedding plants, if used shall be required to be removed and replaced a minimum of 4 times per year. This shall include the bedding soils and replacement with new bedding soil. Also do not use mulch around herbacious plants, as this could cause stem damage. If mulch is desired, use pine straw.										

