

- AGENDA -

REGULAR MEETING OF THE WEST BRANCH DOWNTOWN DEVELOPMENT
AUTHORITY (DDA) TO BE HELD AT THE WEST BRANCH CITY HALL, 121 N.
FOURTH ST, WEST BRANCH, MICHIGAN, 48661 ON TUESDAY, NOVEMBER 28, 2023,
BEGINNING AT 12:00 P.M.

- I. Call to Order
- II. Roll Call
- III. Additions to agenda
- IV. Public comment on agenda items only
- V. Approval of the minutes from the regular meeting held September 26, 2023 and the special meeting held October 31, 2023.
- VI. Bills
- VII. Bids
- VIII. New Business
 - A. Reschedule December meeting
- IX. Unfinished Business
- X. Reports
 - A. MDOT report
 - B. Chairperson Report
 - B. Member Report
 - C. Treasurers Report
 - D. City Manager Report
 - 1. Downtown Tree lights
 - 2. Bond totals
 - 3. Sprinkling system
 - E. Planning Commission
- XI. Communications
 - A. DNR Spark Grant notice
 - B. Light pictures
- XII. Public comment
- XIII. Adjournment

Next Meeting – Tuesday, September 26, 2023

REGULAR MEETING OF THE WEST BRANCH DOWNTOWN DEVELOPMENT AUTHORITY
HELD AT WEST BRANCH CITY HALL, 121 N. FOURTH ST. WEST BRANCH, MI ON TUESDAY,
SEPTEMBER 26, 2023.

The meeting was called to order by Vice Chairperson Joe Clark at 12:00 pm.

Present: Joanne Bennett, Alan Bruder, Joe Clark, Autum Hunter, Sandy Rabidue, and Erin Resteiner.

Absent: Samantha Fabbri, Ken Walters, and Cathy Zimmerman.

Others present: Acting Secretary/City Manager John Dantzer

* * * * *

**MOTION BY RABIDUE, SECOND BY HUNTER, TO APPROVE THE MINUTES FROM
THE MEETING HELD AUGUST 22, 2023.**

Yes – Bennett, Bruder, Clark, Hunter, Rabidue, Resteiner
No – None Absent – Fabbri, Walters, Zimmerman Motion carried

* * * * *

**MOTION BY RABIDUE, SECOND BY HUNTER, TO APPROVE THE BILLS IN THE
AMOUNT OF \$7,782.83.**

Yes – Bennett, Bruder, Clark, Hunter, Rabidue, Resteiner
No – None Absent – Fabbri, Walters, Zimmerman Motion carried

* * * * *

The Board discussed moving the next meeting due to the Council Chambers not being available due to the City being in their annual audit. It was the consensus to switch the October meeting to October 31st at noon, if needed.

* * * * *

**MOTION BY CLARK, SECOND BY RABIDUE, TO EXCUSE MEMBERS FABBRI,
WALTERS, AND ZIMMERMAN FROM THE MEETING.**

Yes – Bennett, Bruder, Clark, Hunter, Rabidue, Resteiner
No – None Absent – Fabbri, Walters, Zimmerman Motion carried

* * * * *

Vice Chairperson Clark welcomed new member Alan Bruder to the Board.

Vice Chairperson Clark also spoke on the road construction and the removal of some downtown trees.

Member Resteiner asked about the possibility of hosting events downtown next year on side streets to help the downtown businesses. Acting Secretary/Manager Dantzer noted he didn't think there would be any issues as long as it wasn't planned on an MDOT detour route.

The Treasures report was submitted.

Acting Secretary/Manager Dantzer noted he was asked by a downtown business owner about the possibility of using the Gathering Place as a temporary parking lot during the road construction project to help cover the spots they will be losing on Houghton Ave.

MOTION BY BRUDER, SECOND BY RESTEINER, TO APPROVE THE USE OF THE GATHERING PLACE AS A TEMPORARY PARKING LOT WHILE HOUGHTON AVE IS UNDER CONSTRUCTION.

Yes – Bennett, Bruder, Clark, Hunter, Rabidue, Resteiner

No – None

Absent – Fabbri, Walters, Zimmerman

Motion carried

The board discussed hours for trick or treating and if they wanted to reestablish trick or treating downtown from 5:00-6:00 pm with the city-wide trick or treating starting at 6:00. It was the consensus of the Board to have downtown trick or treating running from 5:00 pm-6:00 pm on Halloween.

The Board discussed highlights of the Planning Commission minutes including the development of old mill building, old bicycle factory building, old City PD building, and a City grant for water infrastructure that will be announced by the State in September.

* * * * *

A communication from the MEDC noting the City of West Branch was not chosen as an awardee for this round of grant funding as a part of their Public Spaces Grant Program was shared.

* * * * *

The meeting was adjourned at 12:32 pm.

SPECIAL MEETING OF THE WEST BRANCH DOWNTOWN DEVELOPMENT AUTHORITY
HELD AT WEST BRANCH CITY HALL, 121 N. FOURTH ST. WEST BRANCH, MI ON TUESDAY,
OCTOBER 31, 2023.

The meeting was called to order by Vice Chairperson Joe Clark at 12:00 pm.

Present: Joanne Bennett, Joe Clark, and Sandy Rabidue.

Absent: Alan Bruder, Samantha Fabbri, Autum Hunter, Erin Resteiner, Ken Walters, and
Cathy Zimmerman.

Others present: Acting Secretary/City Manager John Dantzer

* * * * *

There was not a quorum present so no action could be taken during the meeting.

* * * * *

Kim Mullins of MDOT gave an update on the road construction project.

* * * * *

The meeting was adjourned at 12:32 pm.

*ATTACHED IS A
LIST OF THE
BILLS TO BE APPROVED
AT THIS MEETING*

BILLS

Beckett & Raeder	\$ 135.00
Beckett & Raeder	\$ 405.00

Paid but not approved	\$ 0.00
-----------------------	---------

TOTAL BILLS	\$ 540.00
--------------------	------------------

B R i
Beckett&Raeder
535 W. William St, Ste 101
Ann Arbor, MI 48103
Tel: (734) 663-2622

John Dantzer
City of West Branch
121 N. 4th Street
West Branch, MI 48661

INVOICE

INVOICE DATE: 9/1/2023
INVOICE NO: 2023880
BILLING THROUGH: 8/31/2023

2021088 West Branch Streetscape M-55 Corridor Improvements

Managed By: Timothy C Knutsen

DESCRIPTION	CONTRACT AMOUNT	% COMPLETE	BILLED TO DATE	PREVIOUSLY BILLED	CURRENT AMOUNT
West Branch Streetscape M-55 Corridor Improvements - DD - CD 2021088	\$56,750.00	92.09	\$52,261.65	\$52,126.65	\$135.00
TOTAL	\$56,750.00		\$52,261.65	\$52,126.65	\$135.00

SUBTOTAL \$135.00
AMOUNT DUE THIS INVOICE \$135.00

This invoice is due on 10/1/2023



535 W. William St, Ste 101
Ann Arbor, MI 48103
Tel: (734) 663-2622

John Dantzer
City of West Branch
121 N. 4th Street
West Branch, MI 48661

INVOICE

INVOICE DATE: 10/1/2023
INVOICE NO: 20231010
BILLING THROUGH: 9/30/2023

2021088 West Branch Streetscape M-55 Corridor Improvements

Managed By: Timothy C Knutsen

DESCRIPTION	CONTRACT AMOUNT	% COMPLETE	BILLED TO DATE	PREVIOUSLY BILLED	CURRENT AMOUNT
West Branch Streetscape M-55 Corridor Improvements - DD - CD 2021088	\$56,750.00	92.80	\$52,666.65	\$52,261.65	\$405.00
TOTAL	\$56,750.00		\$52,666.65	\$52,261.65	\$405.00

SUBTOTAL \$405.00

AMOUNT DUE THIS INVOICE \$405.00

This invoice is due on 10/31/2023

Questions about your invoice? Call or email Dawn Iley at 734-239-6601; iley@bria2.com

Original bid amount	\$56,750.00
---------------------	-------------

Payments

4/18/2022	\$12,367.00
5/30/2022	\$6,799.87
6/30/2022	\$6,260.00
9/30/2022	\$1,977.50
2/7/2023	\$750.00
4/4/2023	\$4,635.00
6/7/2023	\$10,388.53
8/22/2023	\$5,347.50
8/2/2023	\$2,776.25
9/7/2023	\$555.00
10/3/2023	\$270.00

Previous paid	\$52,126.65
---------------	-------------

Current due	<hr/> \$540.00
-------------	----------------

Amount remaining after this payment	\$4,083.35
--	------------

GL NUMBER	DESCRIPTION	2023-24 ORIGINAL BUDGET	2023-24 AMENDED BUDGET	YTD BALANCE 11/30/2023 NORM (ABNORM)	ACTIVITY FOR MONTH 11/30/23 INCR (DECR)	AVAILABLE BALANCE NORM (ABNORM)	% BDGT USED
Fund 248 - DDA OPERATING FUND							
Revenues							
Dept 000.000							
248-000.000-400.400	TAX INCREMENT FINANCING	80,000.00	80,000.00	68,593.03	0.00	11,406.97	85.74
248-000.000-403.400	CURRENT PROPERTY TAX GEN.OP.	10,000.00	10,000.00	8,849.26	173.36	1,150.74	88.49
248-000.000-408.400	PERSONAL PROPERTY TAX LOSS REIMBURSEMEN	40,000.00	40,000.00	49,179.87	0.00	(9,179.87)	122.95
248-000.000-664.400	INTEREST INCOME	0.00	0.00	455.90	0.00	(455.90)	100.00
248-000.000-695.400	MISCELLANEOUS	1,500.00	1,500.00	400.00	0.00	1,100.00	26.67
Total Dept 000.000		131,500.00	131,500.00	127,478.06	173.36	4,021.94	96.94
TOTAL REVENUES							
		131,500.00	131,500.00	127,478.06	173.36	4,021.94	96.94
Expenditures							
Dept 000.000							
248-000.000-729.700	FLOWER PROJECT	5,000.00	5,000.00	0.00	0.00	5,000.00	0.00
248-000.000-750.700	RETAIL MERCHANTS	7,500.00	7,500.00	7,500.00	0.00	0.00	100.00
248-000.000-782.700	ADMINISTRATION	2,400.00	2,400.00	1,000.00	200.00	1,400.00	41.67
248-000.000-801.700	CONTRACTUAL SERVICES	104,800.00	104,800.00	50,046.71	49.00	54,753.29	47.75
248-000.000-865.700	PROFESSIONAL DEVELOPMENT	1,000.00	1,000.00	0.00	0.00	1,000.00	0.00
248-000.000-935.703	SHOWMOBILE EXPENSES	300.00	300.00	0.00	0.00	300.00	0.00
248-000.000-940.700	GEN. MAINTENANCE/SNOW REMOVAL	9,000.00	9,000.00	0.00	0.00	9,000.00	0.00
248-000.000-956.700	EXPENSES	1,500.00	1,500.00	12.83	0.00	1,487.17	0.86
Total Dept 000.000		131,500.00	131,500.00	58,559.54	249.00	72,940.46	44.53
TOTAL EXPENDITURES							
		131,500.00	131,500.00	58,559.54	249.00	72,940.46	44.53
Fund 248 - DDA OPERATING FUND:							
TOTAL REVENUES		131,500.00	131,500.00	127,478.06	173.36	4,021.94	96.94
TOTAL EXPENDITURES		131,500.00	131,500.00	58,559.54	249.00	72,940.46	44.53
NET OF REVENUES & EXPENDITURES		0.00	0.00	68,918.52	(75.64)	(68,918.52)	100.00

11/21/2023 01:47 PM
User: JOHN
DB: Westbranch City

BALANCE SHEET FOR WEST BRANCH
Period Ending 11/30/2023

Page: 1/1

Fund 248 DDA OPERATING FUND

GL Number	Description	Balance
*** Assets ***		
248-000.000-001.000	CASH CHECKING - CHEMICAL BANK	364,633.08
Total Assets		364,633.08
*** Liabilities ***		
Total Liabilities		0.00
*** Fund Balance ***		
248-000.000-390.000	CARRY OVER	295,714.56
Total Fund Balance		295,714.56
Beginning Fund Balance		295,714.56
Net of Revenues VS Expenditures		68,918.52
Ending Fund Balance		364,633.08
Total Liabilities And Fund Balance		364,633.08

Item Description	Units	Quantity	Unit Price	Auth. Amount	
_ Conduit, DB, 2, 1 1/4 inch- DDA PORTION	Ft	38.760	\$30.94	\$1,199.23	DDA
_ Conduit, DB, 2, 1 1/4 inch - CITY PORTION	Ft	12.240	\$30.94	\$378.71	CITY
_ Conduit, DB, 3, 1 1/4 inch - DDA PORTION	Ft	22.800	\$35.83	\$816.92	DDA
_ Conduit, DB, 3, 1 1/4 inch - CITY PORTION	Ft	7.200	\$35.83	\$257.98	CITY
_ Conduit, DB, 4, 1 1/4 inch - DDA PORTION	Ft	31.920	\$43.99	\$1,404.16	DDA
_ Conduit, DB, 4, 1 1/4 inch - CITY PORTION	Ft	10.080	\$43.99	\$443.42	CITY
_ Conduit, Directional Bore, 2, 2 inch - DDA PORTION	Ft	61.560	\$52.09	\$3,206.66	DDA
_ Conduit, Directional Bore, 2, 2 inch - CITY PORTION	Ft	19.440	\$52.09	\$1,012.63	CITY
_ Conduit, Schedule 80, 1 1/4 inch - DDA PORTION	Ft	8,421.560	\$11.51	\$96,932.16	DDA
_ Conduit, Schedule 80, 1 1/4 inch - CITY PORTION	Ft	2,659.440	\$11.51	\$30,610.15	CITY
_ Fence, Structure, Handrail- DDA PORTION	Ft	120.000	\$200.00	\$24,000.00	DDA
_ Fence, Structure, Handrail- CITY PORTION	Ft	162.000	\$200.00	\$32,400.00	CITY
_ Light Std Fdn, Precast, Type 1 - DDA PORTION	Ea	77.520	\$1,680.00	\$130,233.60	DDA
_ Light Std Fdn, Precast, Type 1 - CITY PORTION	Ea	24.480	\$1,680.00	\$41,126.40	CITY
_ Light Std Fdn, Precast, Type 2 - DDA PORTION	Ea	3.040	\$3,747.00	\$11,390.88	DDA
_ Light Std Fdn, Precast, Type 2 - CITY PORTION	Ea	0.960	\$3,747.00	\$3,597.12	CITY
_ Light Std Fdn, Spec - DDA PORTION	Ea	0.760	\$3,454.00	\$2,625.04	DDA
_ Light Std Fdn, Spec - CITY PORTION	Ea	0.240	\$3,454.00	\$828.96	CITY
_ Modular Block Wall	Sft	939.000	\$75.00	\$70,425.00	CITY
_ Planter Curb	Ft	976.000	\$27.00	\$26,352.00	DDA
_ Water Main, HDPE, 12 inch, Directional B ore	Ft	400.000	\$500.00	\$200,000.00	WATER
Aggregate Base - DDA PORTION	Ton	69.160	\$42.00	\$2,904.72	DDA
Aggregate Base - CITY PORTION	Ton	21.840	\$42.00	\$917.28	CITY
Approach, CI I - DDA PORTION	Ton	44.080	\$54.00	\$2,380.32	DDA
Approach, CI I - CITY PORTION	Ton	13.920	\$54.00	\$751.68	CITY
Conduit, Schedule 80, 2 inch - DDA PORTION	Ft	55.480	\$35.40	\$1,963.99	DDA
Conduit, Schedule 80, 2 inch - CITY PORTION	Ft	17.520	\$35.40	\$620.21	CITY
Curb and Gutter, Conc, Det F4 - DDA PORTION	Ft	19.760	\$22.50	\$444.60	DDA
Curb and Gutter, Conc, Det F4 - CITY PORTION	Ft	6.240	\$22.50	\$140.40	CITY
Curb and Gutter, Rem - DDA PORTION	Ft	19.760	\$6.50	\$128.44	DDA
Curb and Gutter, Rem - CITY PORTION	Ft	6.240	\$6.50	\$40.56	CITY
Ero Con, Inlet Protection, Fabric Drop - DDA PORTION	Ea	0.760	\$120.00	\$91.20	DDA
Ero Con, Inlet Protection, Fabric Drop - CITY PORTION	Ea	0.240	\$120.00	\$28.80	CITY
Exploratory Investigation, Vertical - DDA PORTION	Ft	22.800	\$50.00	\$1,140.00	DDA
Exploratory Investigation, Vertical - CITY PORTION	Ft	7.200	\$50.00	\$360.00	CITY
Fence, Rem - DDA PORTION	Ft	5.460	\$100.00	\$546.00	DDA
Fence, Rem - CITY PORTION	Ft	7.540	\$100.00	\$754.00	CITY
Fire Hydrant	Ea	15.000	\$4,460.00	\$66,900.00	WATER
Flowable Fill, Non-Structural	Cyd	3.000	\$300.00	\$900.00	WATER
Gate Valve and Box, 12 inch	Ea	27.000	\$4,249.00	\$114,723.00	WATER
Gate Valve and Box, 6 inch	Ea	15.000	\$1,802.00	\$27,030.00	WATER
Gate Valve and Box, 8 inch	Ea	17.000	\$2,818.00	\$47,906.00	WATER
Gate Well, Abandon	Ea	17.000	\$226.00	\$3,842.00	WATER
Hh, Polymer Conc - DDA PORTION	Ea	5.320	\$1,315.00	\$6,995.80	DDA
Hh, Polymer Conc - CITY PORTION	Ea	1.680	\$1,315.00	\$2,209.20	CITY
Hh, Rem - DDA PORTION	Ea	6.840	\$220.00	\$1,504.80	DDA

Hh, Rem - CITY PORTION	Ea	2.160	\$220.00	\$475.20	CITY
HMA Approach - DDA PORTION	Ton	46.360	\$125.00	\$5,795.00	DDA
HMA Approach - CITY PORTION	Ton	14.640	\$125.00	\$1,830.00	CITY
HMA Surface, Rem- DDA PORTION	Syd	187.720	\$3.20	\$600.70	DDA
HMA Surface, Rem - CITY PORTION	Syd	59.280	\$3.20	\$189.70	CITY
Hydrant, Rem	Ea	10.000	\$575.00	\$5,750.00	WATER
Light Std Fdn, Rem - DDA PORTION	Ea	66.880	\$288.00	\$19,261.44	DDA
Light Std Fdn, Rem - CITY PORTION	Ea	21.120	\$288.00	\$6,082.56	CITY
Light Std Shaft, Rem and Salv - DDA PORTION	Ea	66.120	\$175.00	\$11,571.00	DDA
Light Std Shaft, Rem and Salv - CITY PORTION	Ea	20.880	\$175.00	\$3,654.00	CITY
Masonry and Conc Structure, Rem	Cyd	1,210.000	\$0.01	\$12.10	CITY
Polyethylene Encasement	Ft	6,464.000	\$1.50	\$9,696.00	WATER
Pyrus calleryana 'Cleveland Select', 2in	Ea	50.000	\$400.00	\$20,000.00	DDA
Sidewalk, Conc, 4 inch - DDA PORTION	Sft	141.360	\$4.50	\$636.12	DDA
Sidewalk, Conc, 4 inch - CITY PORTION	Sft	44.640	\$4.50	\$200.88	CITY
Sidewalk, Conc, 6 inch - DDA PORTION	Sft	36.480	\$6.00	\$218.88	DDA
Sidewalk, Conc, 6 inch - CITY PORTION	Sft	11.520	\$6.00	\$69.12	CITY
Sidewalk, Rem - DDA PORTION	Syd	28.880	\$8.00	\$231.04	DDA
Sidewalk, Rem - CITY PORTION	Syd	9.120	\$8.00	\$72.96	CITY
Site Preparation, Max \$7,900.00	LS	1.000	\$7,000.00	\$7,000.00	DDA
Steel Casing Pipe, 20in,Jacked in Place	Ft	140.000	\$551.00	\$77,140.00	WATER
Subbase, CIP	Cyd	63.000	\$0.01	\$0.63	CITY
Water Main, 10 inch, Cut and Plug	Ea	1.000	\$634.00	\$634.00	WATER
Water Main, 12 inch, Cut and Plug	Ea	1.000	\$920.00	\$920.00	WATER
Water Main, 4 inch, Cut and Plug	Ea	2.000	\$394.00	\$788.00	WATER
Water Main, 6 inch, Cut and Plug	Ea	14.000	\$427.00	\$5,978.00	WATER
Water Main, 8 inch, Cut and Plug	Ea	7.000	\$525.00	\$3,675.00	WATER
Water Main, DI, 12 inch	Ft	140.000	\$149.00	\$20,860.00	WATER
Water Main, DI, 12 inch, Tr Det G	Ft	4,759.000	\$166.00	\$789,994.00	WATER
Water Main, DI, 6 inch, Tr Det G	Ft	277.000	\$122.00	\$33,794.00	WATER
Water Main, DI, 8 inch, Tr Det G	Ft	1,288.000	\$213.00	\$274,344.00	WATER
Water Serv	Ea	24.000	\$2,711.00	\$65,064.00	WATER
Water Serv, Long	Ea	46.000	\$6,050.00	\$278,300.00	WATER
SUBTOTAL MDOT BID WORK				\$2,609,302.35	

Mobilization, Max \$1,208,200.00 - DDA PORTION	LS	0.140	\$338,296.00	\$47,361.44	DDA
Mobilization, Max \$1,208,200.00 - CITY PORTION	LS	0.090	\$338,296.00	\$30,446.64	CITY
Mobilization, Max \$1,208,200.00 - WATER PORTION	LS	0.770	\$338,296.00	\$260,487.92	WATER
TOTAL MDOT MOBILATION				\$338,296.00	

Engineering - DDA PORTION	Ea	0.140	\$442,139.75	\$61,899.57	DDA
Engineering - CITY PORTION	Ea	0.090	\$442,139.75	\$39,792.58	CITY
Engineering - WATER PORTION	Ea	0.770	\$442,139.75	\$340,447.61	WATER
TOTAL MDOT ENGINEERING				\$442,139.75	
TOTAL MDOT COST				\$3,389,738.10	

Trash cans	Ea	10.000	\$583.93	\$5,839.30	DDA
Benches	Ea	16.000	\$1911.82	\$30,589.12	DDA

Irrigation	Ea	1.000	\$49474.00	\$49,474.00
Lights - DDA portion	Ea	93.000	\$2220.00	\$206,460.00
Lights - CITY portion	Ea	16.000	\$2220.00	\$35,520.00
Light installation - DDA portion	Ea	0.850	\$400,000.00	\$340,000.00
Light installation - City portion	Ea	0.150	\$400,000.00	\$60,000.00

DDA
DDA
CITY
DDA
CITY

TOTAL CITY BID WORK

\$727,882.42

TOTAL COST

\$4,117,620.52

	MDOT BID PORTION	TOTAL COST %	MOBILIZATION TOTAL	ENGINEERING TOTAL	CITY BID TOTAL	TOTALS	AVAILABLE FUNDS			AMOUNT TO FINANCE
WATER	\$2,028,238.00	77.0%	\$260,487.92	\$340,447.61	\$632,362.42	\$2,629,173.53	\$215,431.88	\$1,760,000.00		\$653,741.65 28%
DDA	\$381,574.71	14.0%	\$47,361.44	\$61,899.57	\$632,362.42	\$1,123,198.14			\$45,968.12	\$1,077,230.02 54%
CITY	\$199,489.64	9.0%	\$30,446.64	\$39,792.58	\$95,520.00	\$365,248.86				\$365,248.86 18%
TOTAL	\$2,609,302.35	100.0%	\$338,296.00	\$442,139.75	\$727,882.42	\$4,117,620.52	less City portion-committed infrastructure			\$2,096,220.52
							TOTAL AMOUNT TO FUND			\$365,000.00
										\$1,731,220.52

FUNDING SOURCE OPTIONS				20 YR BOND	
Bond total		\$2,250,000.00		\$1,750,000.00	
Committed infrastructure		\$615,000.00		ANNUAL PMT	\$146,940.99
DDA carryover		\$288,204.00		DDA-66%	\$96,981.05
Water replacement fund	car	\$820,000.00		WATER-34%	\$49,959.94
City carryover		\$593,069.00			

John Dantzer

From: noreply-migrants@michigan.gov
Sent: Monday, October 9, 2023 2:32 PM
To: citymanager@westbranch.com
Subject: Application Outcome for ARPA-0897

City of West Branch - Ogemaw, Ogemaw

ARPA-0897 - City of West Branch Placemaking and Parks expansion

We regret to inform you that the application noted above was not recommended by the DNR Director. This is a competitive grant program. More applications were submitted than could be funded.

New DNR Recreation Grant applications are accepted on April 1 each year. If you would like to discuss potential projects and strategies for a future application, contact your Grant Coordinator.

Thank you for your interest in the Michigan Spark Grant Program.

Sincerely,
Grants Management
Finance and Operations Division
Michigan Department of Natural Resources

CITY OF WEST BRANCH

DOWNTOWN AND W.B. TOWNSHIP STREET LIGHT IMPROVEMENTS

Medler Electric Order # S5279030

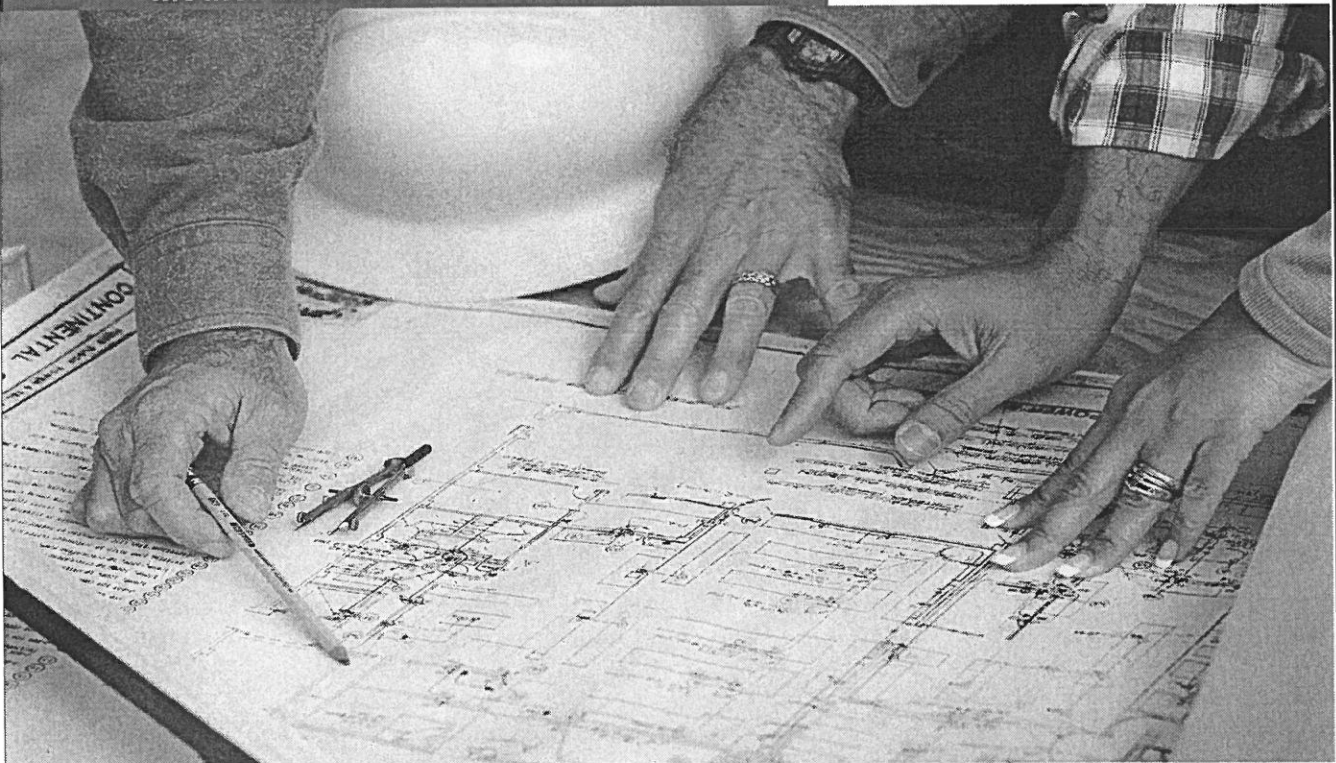
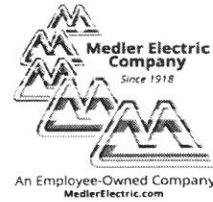

<input checked="" type="checkbox"/> Approval	<input type="checkbox"/> Operations & Maintenance Manual
<input type="checkbox"/> Record	
<input type="checkbox"/> Revision	<input checked="" type="checkbox"/> Copies Provided

PROJECT CONSULTANT
Brian Leibler
brianl@medlerelectric.com
(989) 345-5720

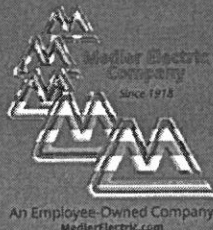

CONTRACTOR / INSTALLER

City of West Branch
121 N. Fourth Street
West Branch, Michigan 48661



DISTRIBUTOR

Medler Electric Company
2543 South M-76
West Branch, Michigan 48661

JOBSITE LOCATION

Downtown West Branch
and a portion of West Branch Twp.
West Branch, Michigan 48661



Job Name:
City of West Branch Street Lights

Catalog Number:
LM-LWW-55-1-30-AC-BH1-BK

Type:

Notes:

WLC23-9241



LM-LWW

Lumecon Midtown Little Woodward Post-Top

Technical Specifications

GLOBE MATERIALS

Acrylic: Our two-piece acrylic lens post-top features precise prisms achievable only through injection molding. The prisms provide pleasing daytime 'prismatic sparkle' and provide excellent uniformity, light distribution, and efficiency for nighttime performance. The globe carries a 20-year warranty which includes resistance to yellowing, as we define as having a yellowness index of less than 7.

FITTER: Slip fits over 2 7/8" and 3" OD tenons on most decorative poles. Requires nominal 3" diameter x 2 7/8" tall tenon. Uses A356 aluminum comprises 92.05% Aluminum, 7% Silicon, 0.35% Magnesium, 0.20% Iron, 0.20% Copper, 0.10% Manganese, and 0.10% Zinc. It is lightweight and highly corrosion-resistant, like stainless steel. Heat treated to improve strength—low impurities cause high strength and ductility.

FINISH: Cast aluminum fitter housing with textured or 60% gloss polyester powder coat finishes for maximum durability. The base aluminum material is prepared using an environmentally friendly non-chrome 2-step surface cleaning and passivation process. The process results in a more durable conversion layer than traditional chromate conversion coatings and allows maximum powder coating adhesion to the aluminum fitter.

POWERED BY THE LUMECON L-RETRO-DG LIGHT ENGINE

INPUT VOLTAGE: 120-277V or 347-480V

EFFECTIVE PROJECTED AREA (EPA): 0.65 ft²

LIGHT ENGINE: Each LED light engine consists of a circuit board of 80 Midpower LEDs. The LED board is mounted to a 0.125 aluminum disk and heat sink for maximum heat dissipation from the LEDs.

LUMECON ETD™ SYSTEM: The enhanced thermal dissipation system engines are thermally bonded to provide maximum thermal dissipation to the fixture's exterior to ensure long life. To protect the light engine panel from moisture and corrosion, the LED light engine panel is uniformly coated with a UV-stabilized acrylic polymer resin that meets MIL and ASTM dielectric standards, UL and IPC standards for flammability, moisture resistance, and thermal shock.

COLOR TEMPERATURE: 2200K, 2700K, 3000K, 4000K, 5000K

LED LIFETIME: All LEDs are rated for a minimum of 100,000 hours of continuous operation at ambient temperatures from -40°F/-40°C to 115°F/46°C.

COLOR RENDERING INDEX (CRI): Minimum of 80 or higher.

DIMMING: 0-10V standard dimming capability.

SURGE PROTECTION: Thermally protected 20kA/ 40kV varistor type surge suppressor is included and meets ANSI C136.2-2015: Extreme Level. It also meets IEC61643-11 Class II / EN61643-11 Type 2 and US Dept of Energy MSSLC Model Spec for surge protection. The device is wired in series with the luminaire input power to interrupt power to the luminaire when consumed, protecting the LED power supply and circuit boards from additional electrical surges.

MANUFACTURING ORIGIN: US Manufactured and Assembled.

BABA COMPLIANT: Meets Build America, Buy America Act. Included in the Infrastructure Investment and Jobs Act, Public Law Number 117-58, Title IX, Subtitle A, Part I—Buy America Sourcing Requirements, Sections 70911-70917 stating Manufactured in the U.S. The cost of components mined, produced, or manufactured in the U.S. is greater than 55 percent of the total cost of all manufactured product components.

WARRANTY: 10 Year L70 performance-based warranty. For full warranty terms, please visit our website: www.lumecon.com.

CERTIFICATION: Built with ETL/UL-certified components.

DESIGNLIGHTS CONSORTIUM® (DLC) QUALIFIED PRODUCT: Unless noted, not all versions of this product may be DLC® qualified. For a complete list of Lumecon DLC® Qualified Products visit: www.designlights.org.



Requires nominal 3" diameter x 2 7/8" tall tenon



Shown with:
PI - Prismatic Injection Molded

FITTER	BH1	BH2	BH3	BH4	BH5	BH8	BH9	BH10	BH12	BH13
HEIGHT	10"	6.75"	8"	6.75"	11.25"	12"	11.5"	12.75"	12"	13.4"

FINIAL	FN1	FN2	FN3	FN4
HEIGHT	5"	4"	3"	3.5"

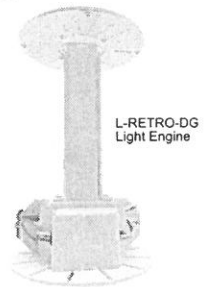

L-RETRO-DG
LIGHT ENGINE



L-RETRO-DG
LIGHT ENGINE



Email: sales@lumecon.com Website: www.lumecon.com Phone: 248-477-5009
Copyright © 2023 Lumecon LLC. All Rights Reserved.
Note: Specifications and photometric data are subject to change at any time without notice.
Please see www.lumecon.com for current specifications and documentation.

CH2484341000_07150701

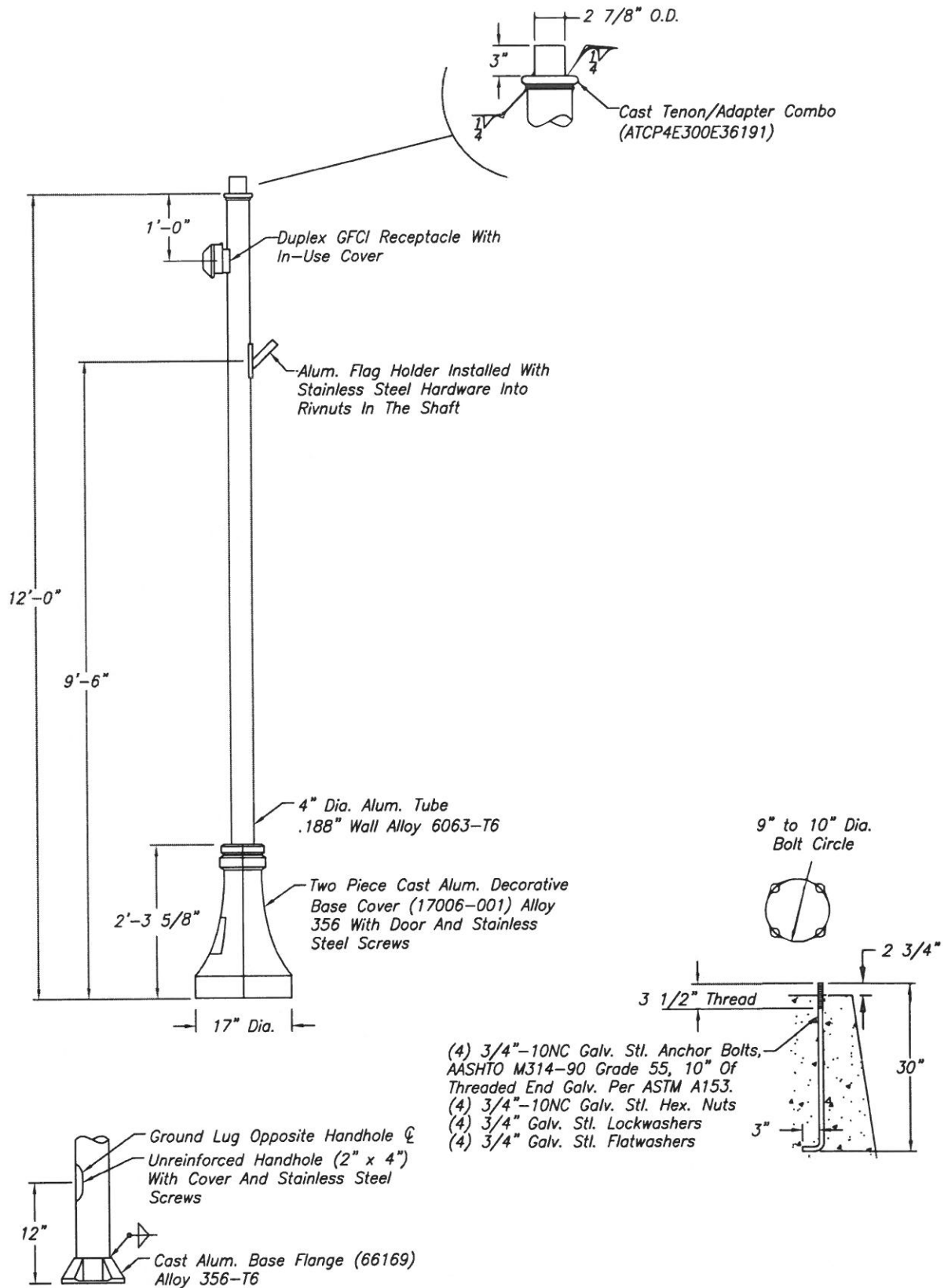

Pole Base Detail

B111887

NO.	REVISIONS	DATE

WARNING: DO NOT INSTALL LIGHTING POLES WITHOUT LUMINAIRES



TITLE YALE MODIFIED SERIES POLE

BY TNB
 CHK'D

DWG. NO.

B111887

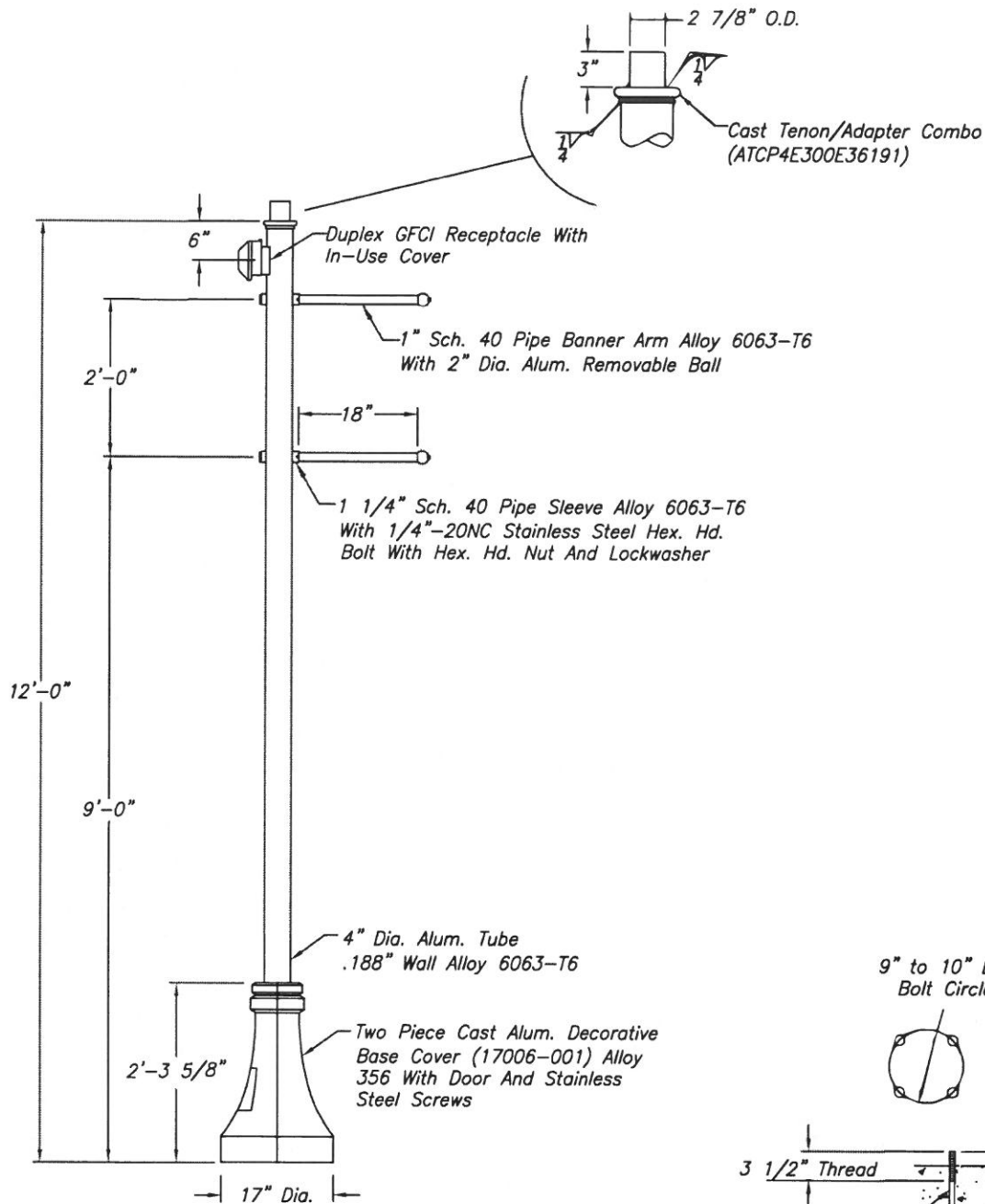

9" to 10" Dia. Bolt Circle

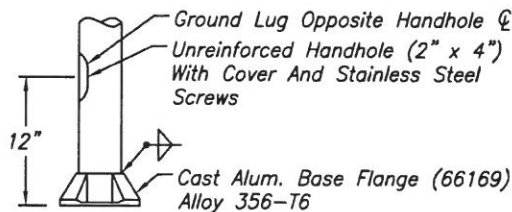
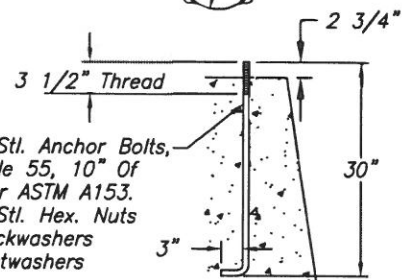

Pole Base Detail

- (4) 3/4"-10NC Galv. Stl. Anchor Bolts, AASHTO M314-90 Grade 55, 10" Of Threaded End Galv. Per ASTM A153.
- (4) 3/4"-10NC Galv. Stl. Hex. Nuts
- (4) 3/4" Galv. Stl. Lockwashers
- (4) 3/4" Galv. Stl. Flatwashers

B111888

WARNING: DO NOT INSTALL LIGHTING POLES WITHOUT LUMINAIRES

NO.	REVISIONS	DATE



TITLE YALE MODIFIED SERIES POLE

BY TNB

DWG. NO.

CHK'D

B111888

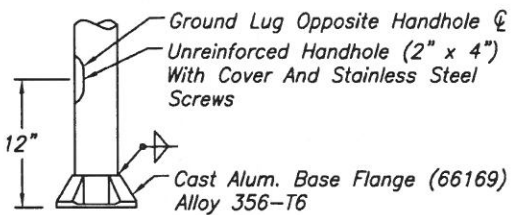
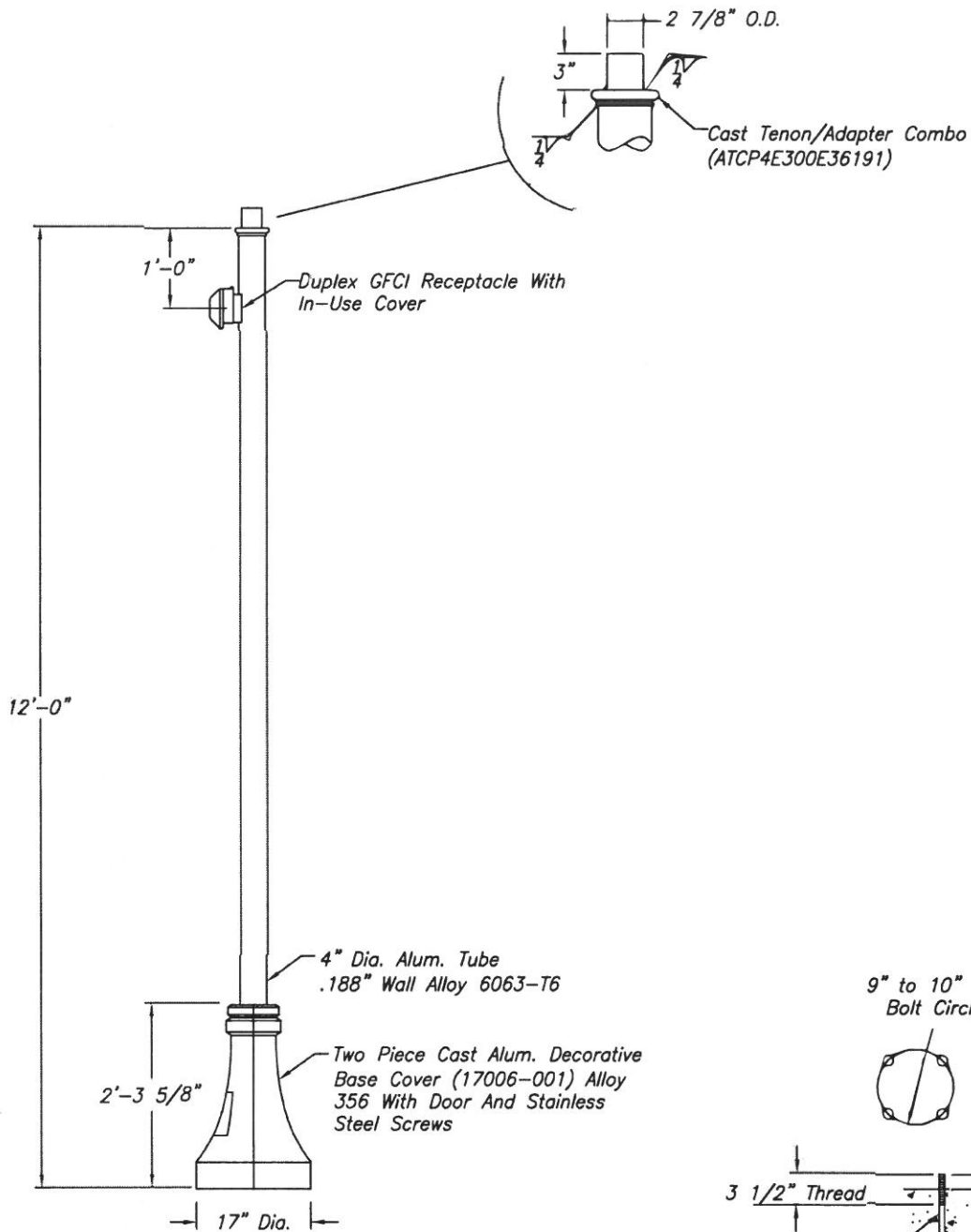

Pole Base Detail

9" to 10" Dia.
Bolt Circle

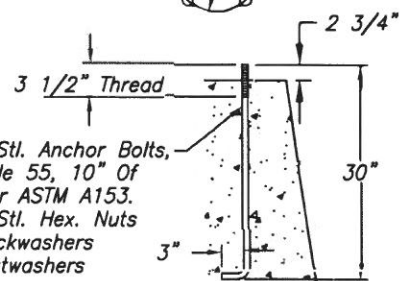

- (4) 3/4"-10NC Galv. Stl. Anchor Bolts, AASHTO M314-90 Grade 55, 10" Of Threaded End Galv. Per ASTM A153.
- (4) 3/4"-10NC Galv. Stl. Hex. Nuts
- (4) 3/4" Galv. Stl. Lockwashers
- (4) 3/4" Galv. Stl. Flatwashers

WARNING: DO NOT INSTALL LIGHTING POLES WITHOUT LUMINAIRES

NO.	REVISIONS	DATE



TITLE YALE MODIFIED SERIES POLE

BY TNB
CHK'D

DWG. NO.

B111889

B111889